

**Prolonged unprotected exposure to heat may be detrimental to the appearance or long term performance of a wall lining. Combustible and heat sensitive wall linings or finishes must not protrude past the trim, to the glass viewing area. Some scenarios will require the use of 22mm DS Extended Trim Kit, or a custom solution, to provide adequate protection.**

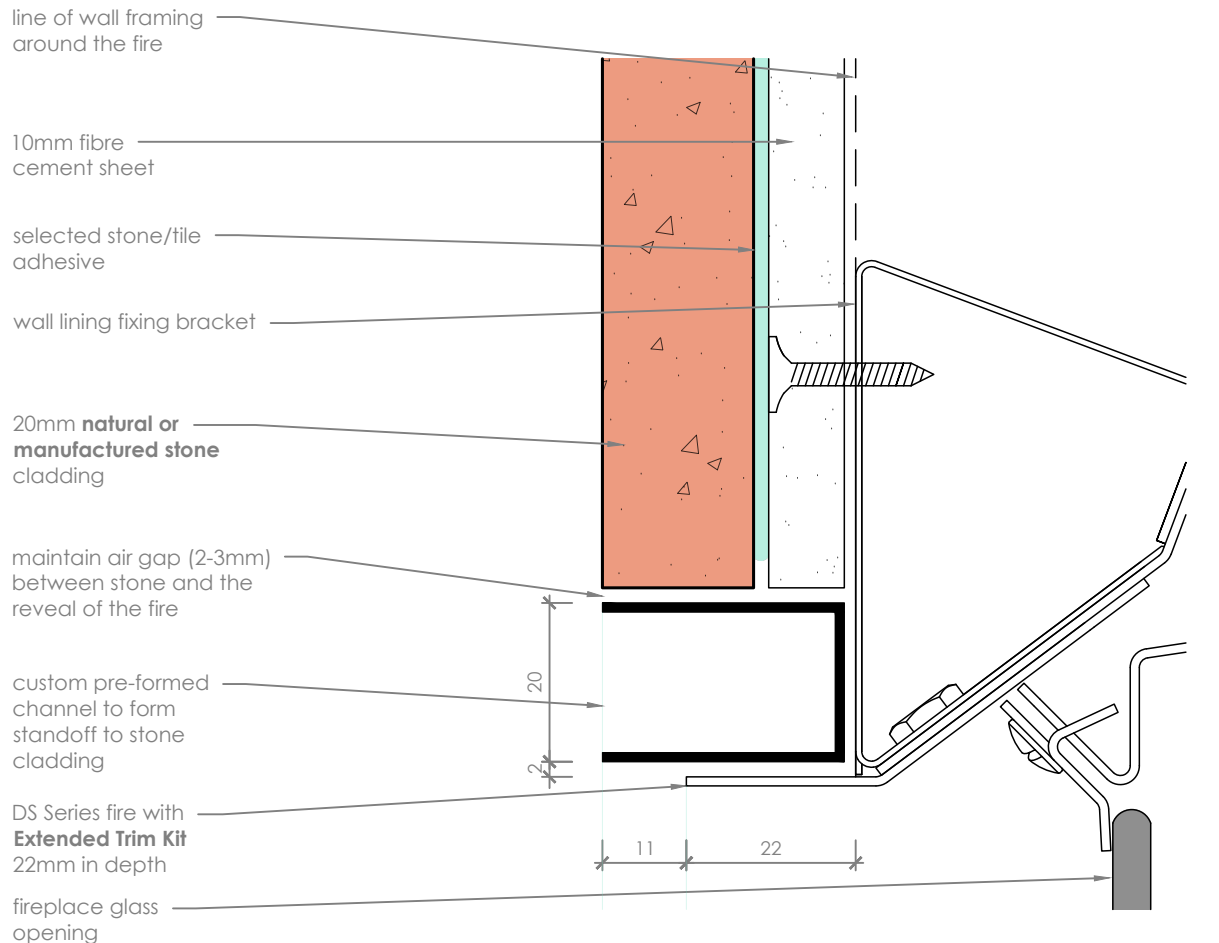

**Negative Detail**

scale 1:1

**Notes:**

- All dimensions are in mm. DO NOT SCALE OFF THESE DRAWINGS
- This detail is to assist in the installation of a **frameless finish** to a DS or DN Series Gas Fireplace.
- This detail is suitable for all for sides of the fireplace glass viewing area.
- Black fireplace reveals must be able to be removed - ensure adhesive or compound is kept clear.
- Any custom trim or L-angle must be on all four sides to the glass opening of the fire.
- This technical sheet must be read in conjunction with the Escea DS Series Installation Manual, the latest version can be found on our website at [www.escea.com](http://www.escea.com).

GENERAL CONSTRUCTION AND FINISHES SHOWN INDICATIVE ONLY

Contact the ESCEA Architectural Advisory Team for assistance with the specification of this fire - [aa@escea.com](mailto:aa@escea.com)

Prolonged unprotected exposure to heat may be detrimental to the appearance or long term performance of a wall lining. Combustible and heat sensitive wall linings or finishes must not protrude past the trim, to the glass viewing area. Some scenarios will require the use of 22mm DS Extended Trim Kit, or a custom solution, to provide adequate protection.

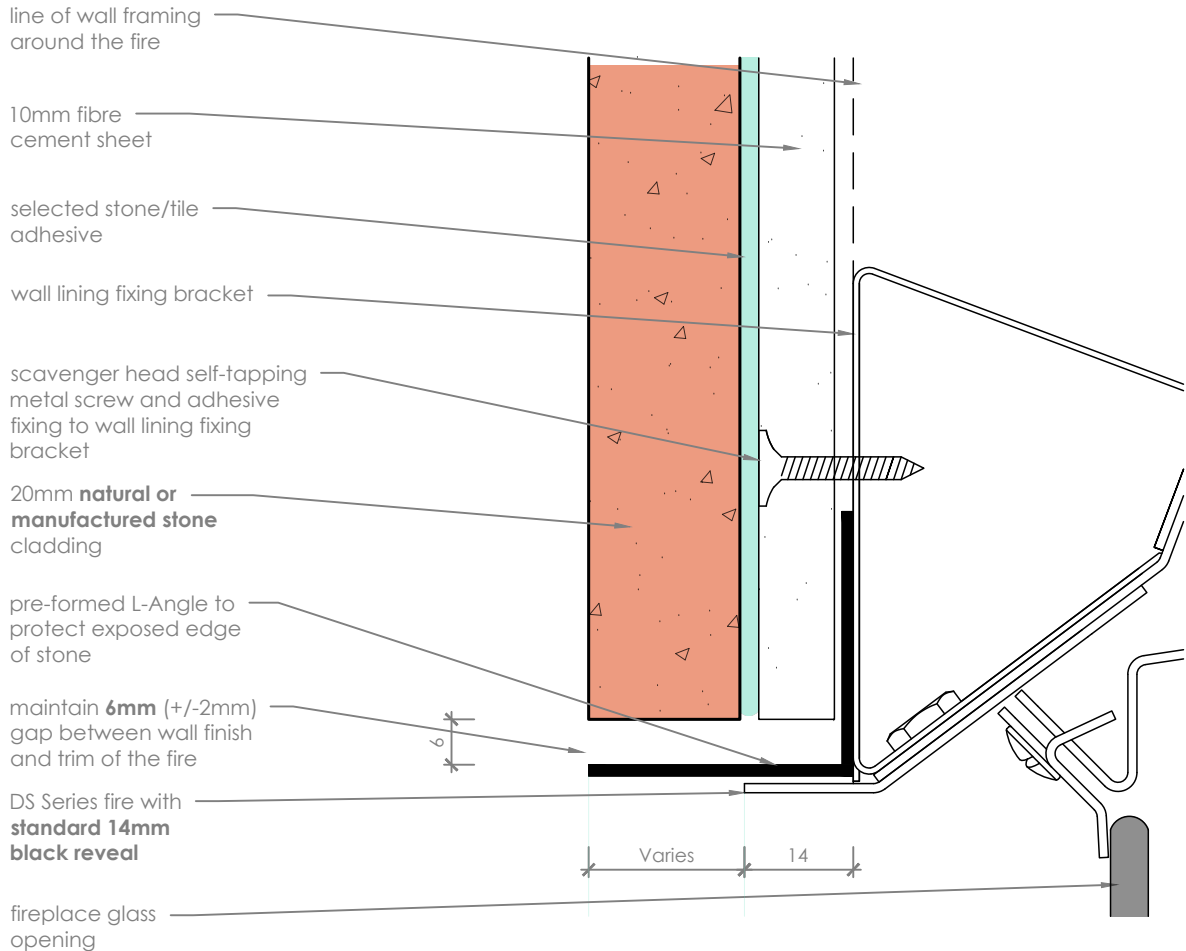

**Custom L-Angle**

scale 1:1

**Notes:**

- All dimensions are in mm. DO NOT SCALE OFF THESE DRAWINGS
- This detail is to assist in the installation of a **frameless finish** to a DS or DN Series Gas Fireplace.
- This detail is suitable for all for sides of the fireplace glass viewing area.
- Black fireplace reveals must be able to be removed - ensure adhesive or compound is kept clear.
- Any custom trim or L-angle must be on all four sides to the glass opening of the fire.
- This technical sheet must be read in conjunction with the Escea DS Series Installation Manual, the latest version can be found on our website at [www.escea.com](http://www.escea.com).

GENERAL CONSTRUCTION AND FINISHES SHOWN INDICATIVE ONLY

Contact the **ESCEA Architectural Advisory Team** for assistance with the specification of this fire - [aa@escea.com](mailto:aa@escea.com)