

**IMPORTANT:**

This technical sheet must be read in conjunction with the Escea DS Series Installation Manual, the latest version can be found on our website [www.escea.com/nz/technical/](http://www.escea.com/nz/technical/)

Contact the **ESCEA Architectural Advisory Team** for assistance with installation of this fire - [aa@escea.com](mailto:aa@escea.com)

**DS Series Mesh kit** provides protection against accidental touching of the glass - this mesh is not cool to touch and prolonged exposure should be avoided

**note:**

- DO NOT SCALE OFF THESE DRAWINGS
- All dimensions are in mm.
- Gas connection is on the lower right hand side of the appliance and access can be made for installation through the access hatches on the front and back of the appliance, or from inside the firebox.
- An electrical isolation switch outside of the cavity is mandatory to isolate power to the fire for servicing in the future.
- The supplied 5m network cable is for connection to the building's modem. This allows control of the fire via the Escea Smart Heat App.
- For further information refer to **Sec D** of the Escea DS Series Installation Manual.

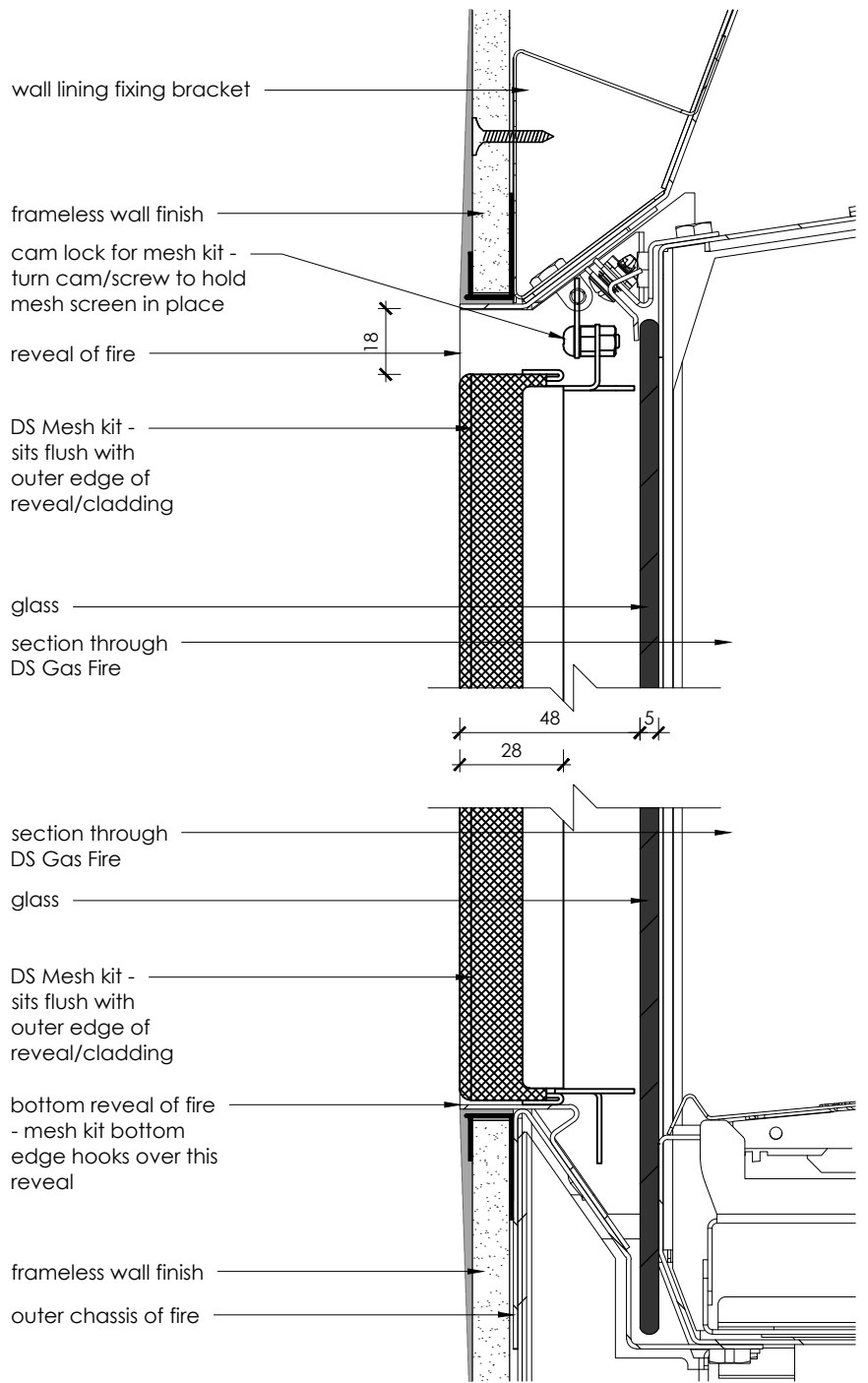

**Mesh Kit Install**

scale 1:2

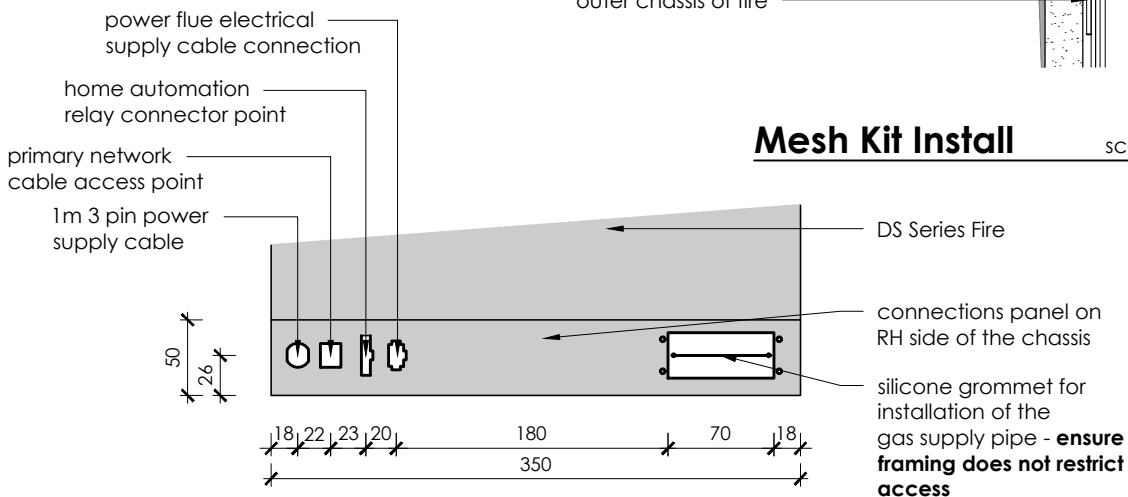

**Connections**

scale 1:5

file: DS SERIES MASTER FILE.dwg	scale: <b>as shown</b>	ecn: <b>ECN-2669</b>	drawing no: <b>EDA-0256</b>	revision: <b>001</b>	date: <b>16.10.2017</b>	drawn: <b>MG</b>
------------------------------------	---------------------------	-------------------------	--------------------------------	-------------------------	----------------------------	---------------------