

DS Series - Frameless Finish Guide

FIRE BY **escea.**

notes:

- DO NOT SCALE OFF THESE DRAWINGS
- All dimensions are in mm.
- This detail sheet is to assist in the installation of a **frame less plasterboard finish** to the DS Series Gas Fire.
- Escea recommends when using these finishing methods that **10mm plasterboard** is used.
- Use care when sanding plaster to avoid scratching black fireplace reveals - use a damp sponge to remove excess.
- Black fireplace reveals must be able to be removed - break seal between finished plaster and reveal prior to painting.
- **Do not excessively push back wall board when fixing it to the fire chassis** - use large daubs of adhesive to the chassis and apply wall board and flush finish with edge of the fire reveal.

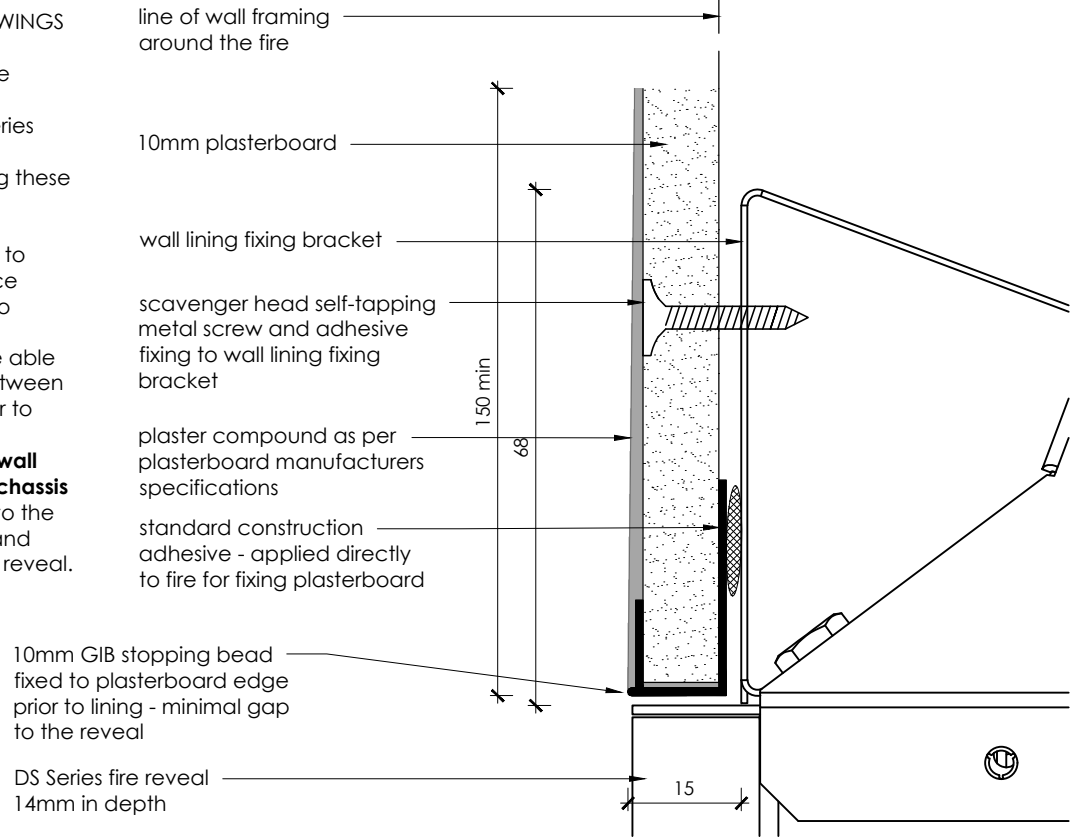

Stopping Bead scale 1:1

This detail is applicable for:

- DS1150
- DS1400
- DS1650

IMPORTANT:

This technical sheet must be read in conjunction with the Escea DS Series Installation Manual, the latest version can be found on our website www.escea.com/nz/technical/

Contact the **ESCEA Architectural Advisory Team** for assistance with installation of this fire - aa@escea.com

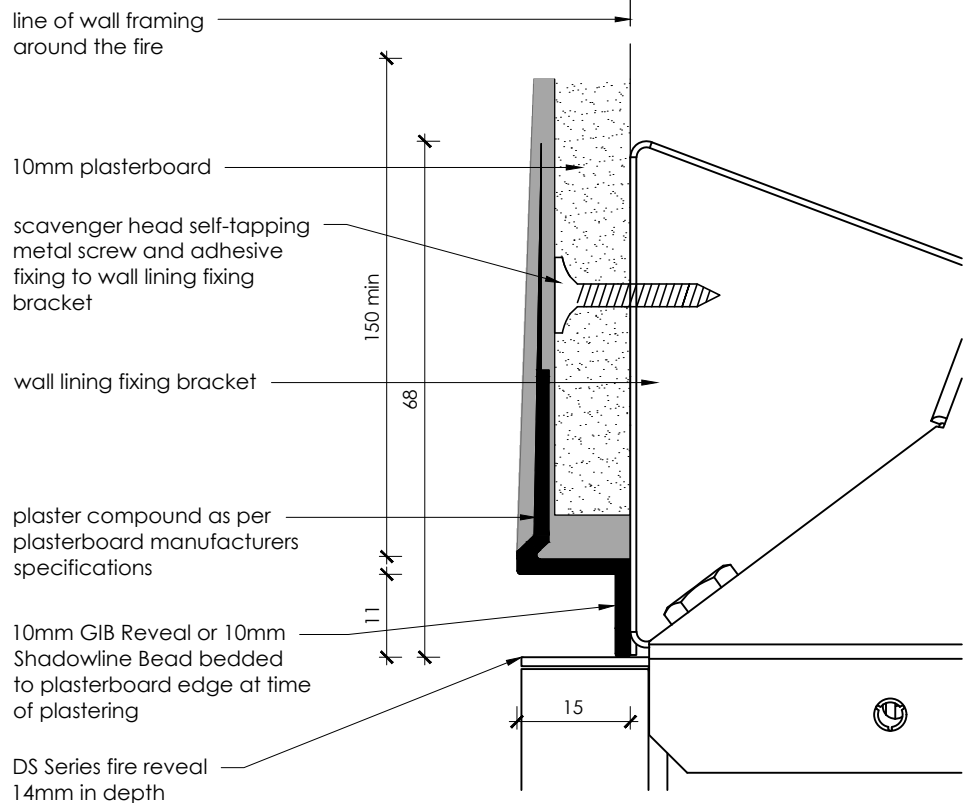

Negative Detail scale 1:1

GENERAL CONSTRUCTION AND FINISHES SHOWN INDICATIVE ONLY

file: DS SERIES MASTER FILE.dwg	scale: 1:1	ecn: ECN-2669	drawing no: EDA-0251	revision: 002	date: 13.10.2017	drawn: MG
------------------------------------	----------------------	-------------------------	--------------------------------	-------------------------	----------------------------	---------------------