

Prolonged unprotected exposure to heat may be detrimental to the appearance or long term performance of a finishing or structural material. Specifier's and installers must ensure that materials used are suitable for the intended project.

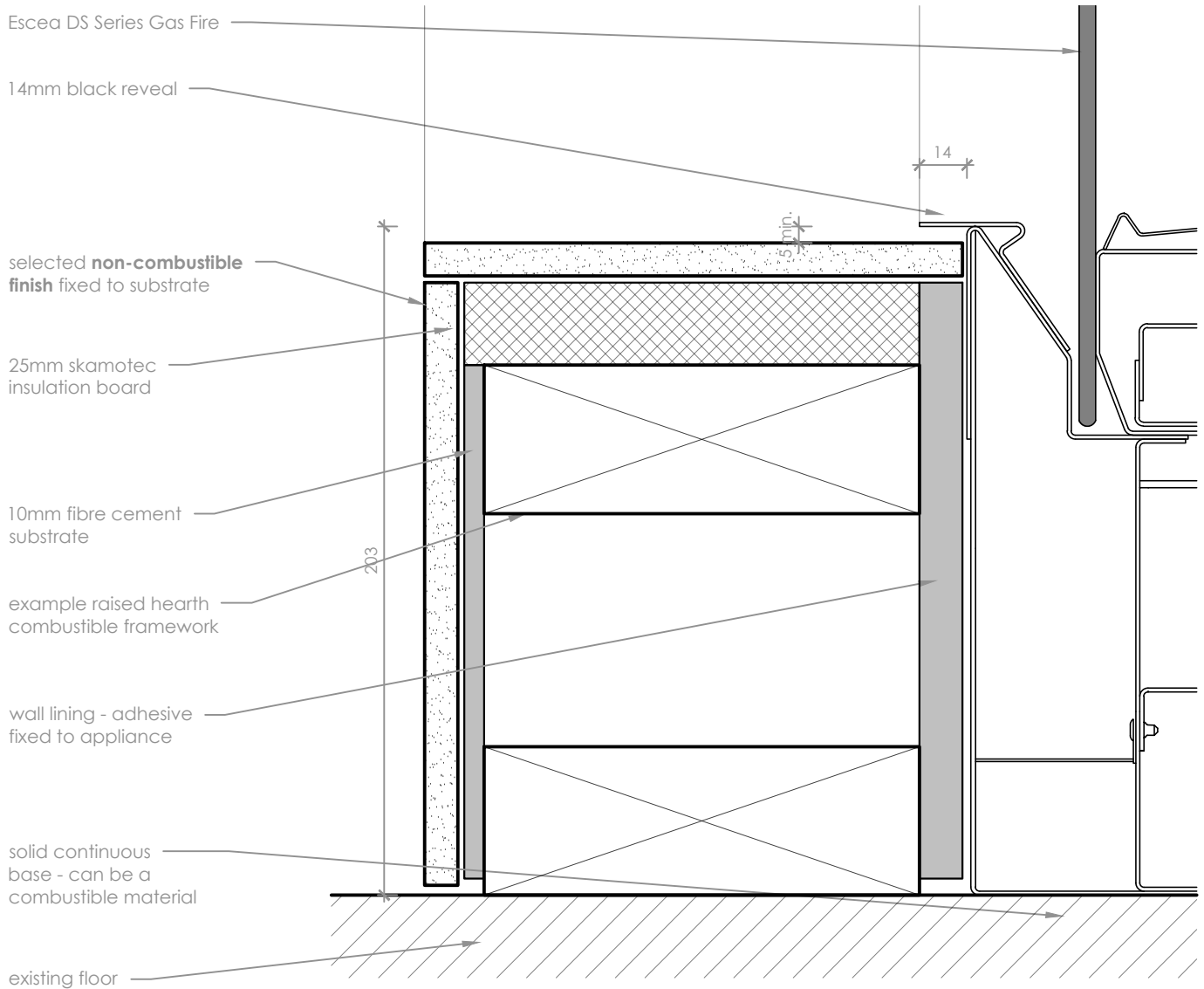

Hearth Detail

scale 1:2

Notes:

- All dimensions are in mm. DO NOT SCALE OFF THESE DRAWINGS.
- This detail is to assist in the installation of a **Raised Hearth or floor with a Non-Combustible or Heat Resistant Finish** to a DS Series Gas Fireplace.
- When setting out framework allow for the thickness of Skamotec insulation, any finishes and required air gaps.
- Powdercoated or painted components can be easily damaged - handle with care.
- Black fireplace reveals must be able to be removed - ensure any adhesive or compound is kept clear.
- This technical sheet must be read in conjunction with the Escea DS Series Installation Manual, the latest version can be found on our website at www.escea.com

GENERAL CONSTRUCTION AND FINISHES SHOWN INDICATIVE ONLY

Contact the ESCEA Architectural Advisory Team for assistance with the specification of this fire - aa@escea.com