

ESCEA DX1000 : NO FASCIA SINGLE SIDED

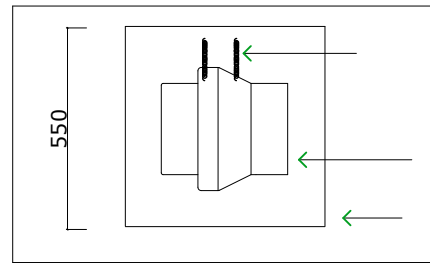

FAN SPRINGS
TV
DUCT FAN
ACCESS PANEL

NOTES:

1. Designer must consider ducting as part of fire detailing.
2. Fire will not operate if ducting incorrect
3. Frame up suitable support structure for inline fan from 90x45mm timber min - refer install instructions for suggested noise isolation

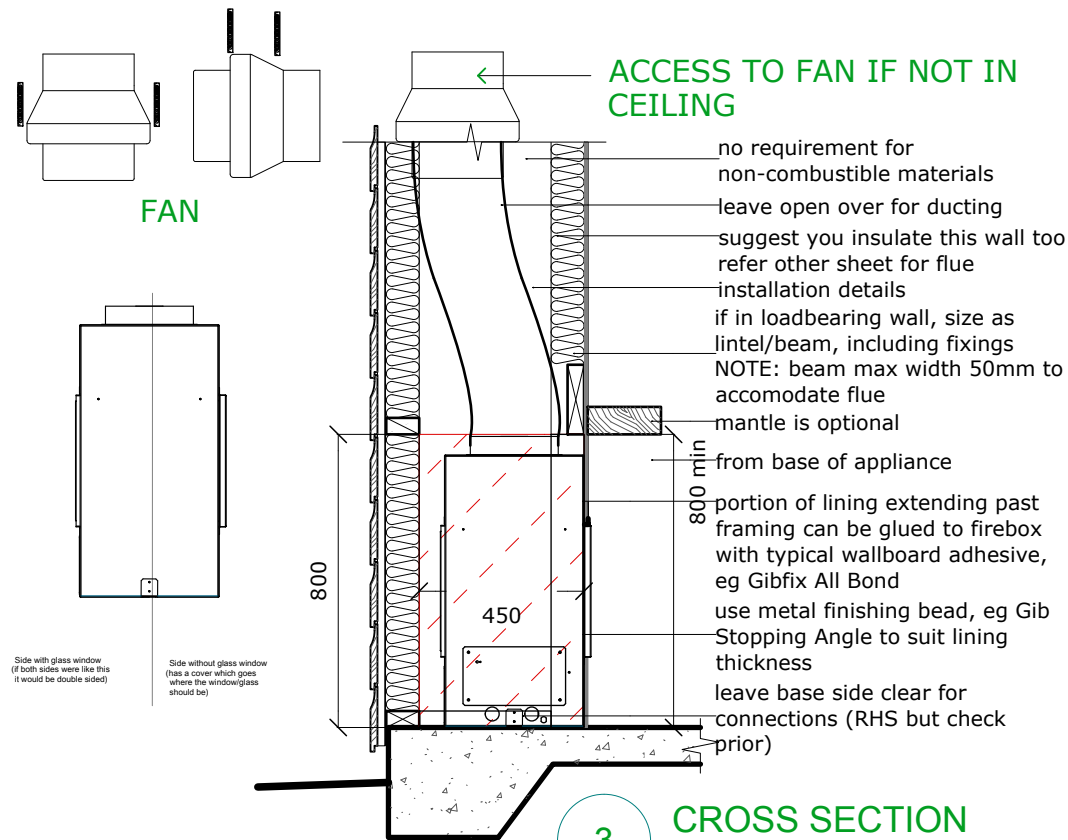

3 CROSS SECTION
Scale: 1:20 @ A4

NOTE: ELECTRICIAN TO PROVIDE EASILY ACCESSIBLE ISOLATING POWER SWITCH TO APPLIANCE, AND NETWORK CABLE BACK TO ROUTER

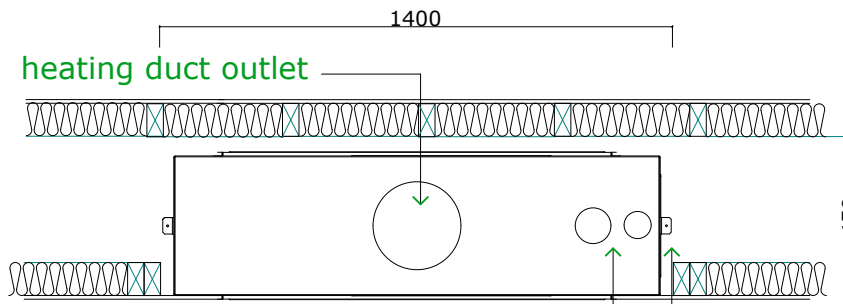

1 PLAN
Scale: 1:20 @ A4

NOTES:

1. Designer must consider ducting as part of fire detailing.
2. Fire will not operate if ducting incorrect
3. Frame up suitable support structure for inline fan from 90x45mm timber min - refer install instructions for suggested noise isolation

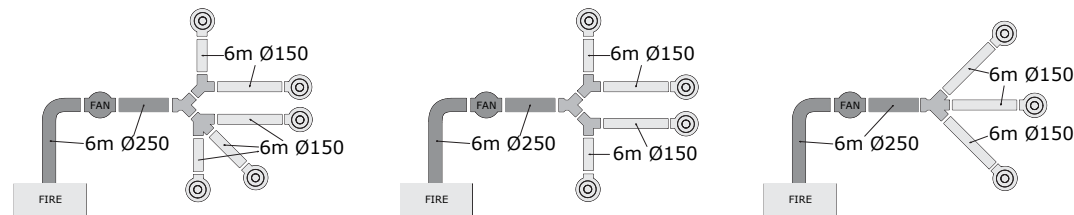

4 DUCTING SCENARIOS
Scale: 1:20

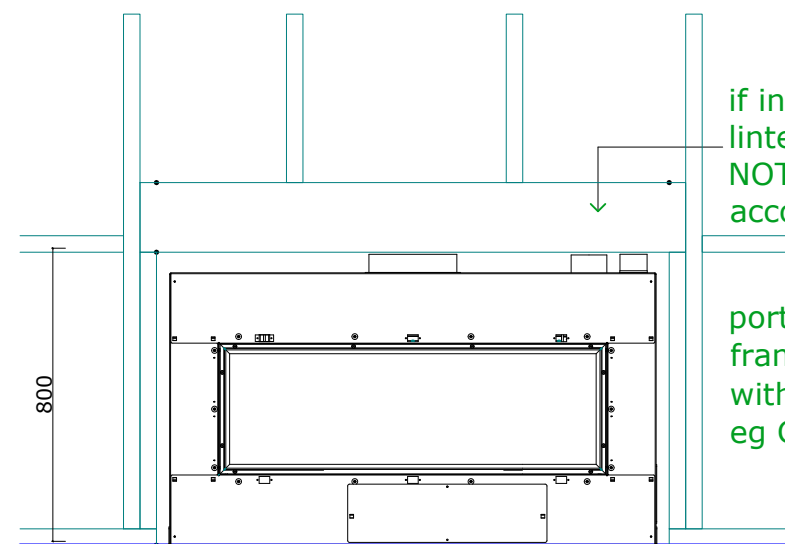

2 ELEVATION
Scale: 1:20 @ A4