

KS55 Mesh Barrier - See Through Gas Fireplace

Information Sheet for Builders and Architects

SPECIFICATIONS

| | |
|-----------------------------|--|
| Model No. | NBD5525 |
| Gas Input (NG/Propane) | 45,000 BTU-hr/42,000 BTU-hr |
| Heat Output (NG/Propane) | 27,675 BTU-hr/27,510 BTU-hr |
| Gas Type | Natural Gas / Propane |
| Power Requirement | 3 pin, 110/120V mains power |
| Appliance Weight | 343.9 lbs |
| Finish Options | Frameless |
| Connections/Gas Connections | Right-hand side/Lower center |
| Duct Vent | Not Required |
| Room Sealed Glass | Yes |
| Fireplace Chase Venting | Not Required |
| Service Access Hatch | Not Required |
| Clearance to Combustibles | Zero clearance from fireplace surfaces |



| | |
|---------------------------------|---|
| Vent System | Power direct-vent with 4" x 6 3/8" vent pipe* |
| Vent Termination Locations | Roof or Wall mounted Terminations |
| Minimum Vent Length | 24" |
| Maximum Vent Length | 50' (600") |
| Vent Clearances to Combustibles | 3" above vent, 1" to sides/below vent |
| Compliance | Certified to ANSI Z21.88/CSA 2.33 |

*Refer to the Escea KS Series Power Vent Information Sheet

INSTALLATION

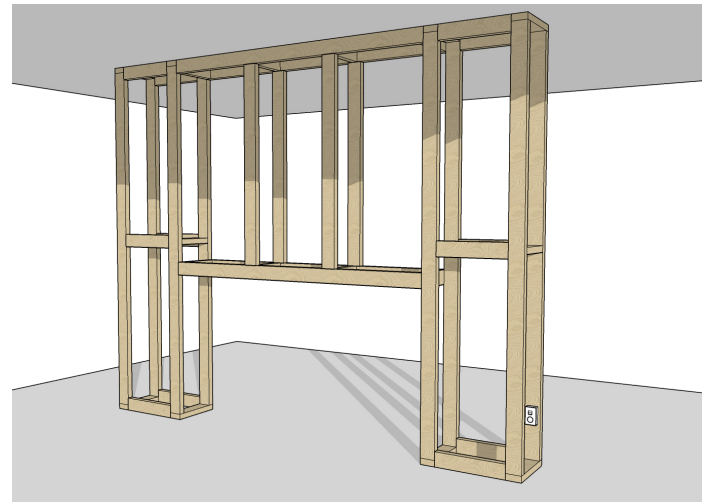

Construct the wood framing following all minimum fireplace chase opening requirements and with consideration to vent pathways. Provide a continuous base for the fireplace. Allow for mains power connection and an accessible isolation switch.

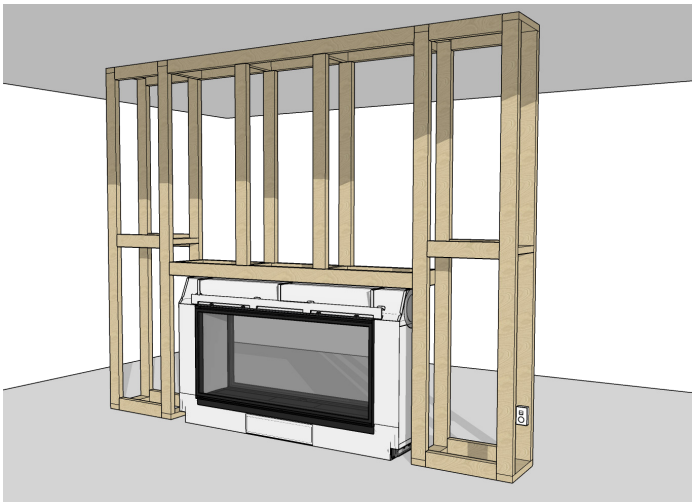

Install the appliance into the preformed opening in the chase. Secure to the framework using the supplied nailing flanges. The fireplace should be flush with the wood framing.

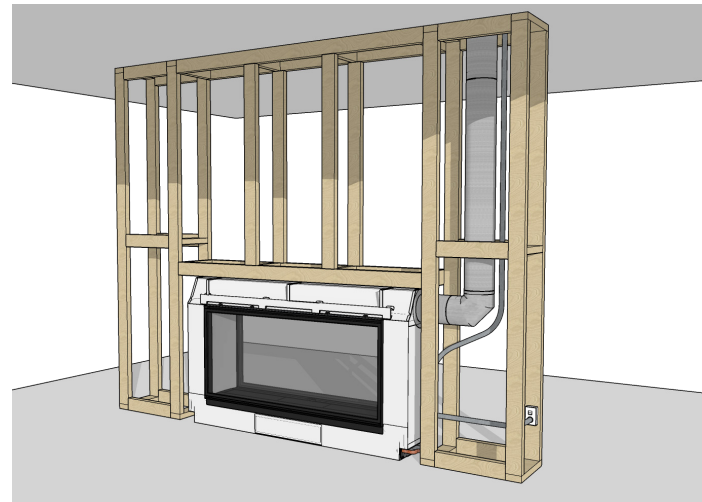

Install the electrical connection and gas supply. Connect the vent pipe to the fireplace and construct vent pathway to the vent termination. Connect Power-vent electrical supply from the fireplace to the vent termination.

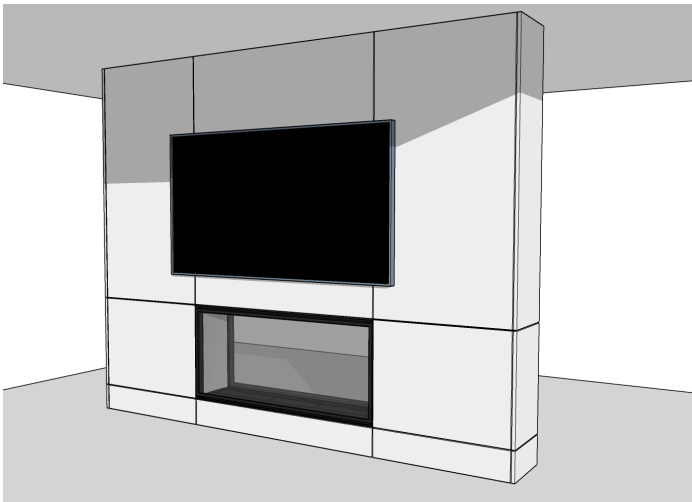

Fix the wall linings to the framework and the fireplace leaving a 1/4" gap to the glass opening. The wall lining can be bonded directly to the fireplace. Install any additional finishes or fixtures to complete the project.

KS55 Mesh Barrier - See Through Gas Fireplace

Information Sheet for Builders and Architects

FIRE BY **escea.**

FIREPLACE AND CHASE DIMENSIONS

| | | | |
|---------------------|-----------|---------------------------|---------|
| Fireplace Width | 68 2 1/2" | Chase Opening Width min. | 73" |
| Fireplace Height | 39 1/4" | Chase Opening Height min. | 40" |
| Fireplace Depth | 15 1/8" | Chase Opening Depth min. | 14 1/2" |
| Viewing Area Width | 53 5/16" | Vent Chase Width min. | 8" |
| Viewing Area Height | 25 13/32" | | |

This fireplace should be installed in accordance with any local regulations or codes and the relevant Escea Install Manual. In the absence of local codes, install in accordance with ANSI Z223.1/NFPA 54, or CSA B149.1 and the relevant Escea Install Manual.

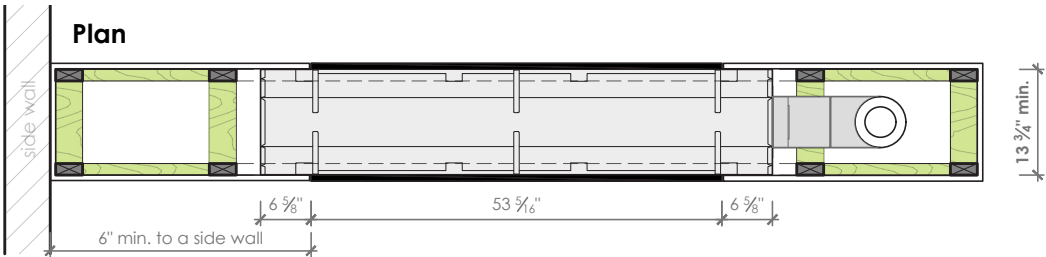

Side View

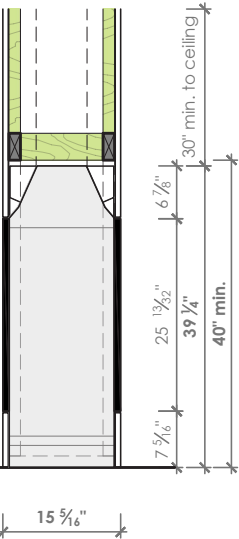

Front View

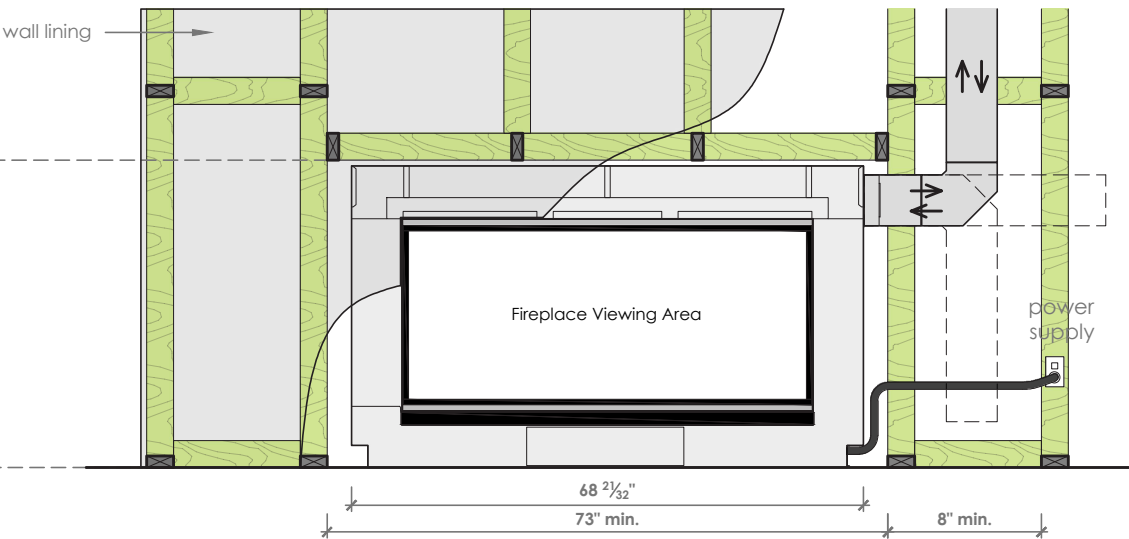

FIREPLACE LOCATION

A see-through gas fireplace provides versatile placement options, including room division, island, or peninsula settings. Consult the *Escea Cabinetry Design Guide* if the framework is at minimum cavity height for under-counter or built-in cabinets. Note: this fireplace cannot be located on an external wall.

FIREPLACE CHASE

The fireplace chase is a structure enclosing the gas fireplace and vent system, using wood, steel framing, or panels. In colder regions, it's advisable to enclose the vent within the chase. Check local regulations. Fire-stops are required for safety when the vent system passes through an interior, exterior wall or a ceiling. Requirements will vary with each geographic location and you should check local regulations.

Note: The fireplace chase detailed above, is 120" wide with 23 1/2" of framework on each side, allowing space for the vent system and symmetry.

FIREPLACE BASE

The fireplace can be installed on the floor or an elevated structure. In all cases, use a solid, continuous surface like concrete, plywood, or compressed cement sheet. Avoid installing directly on carpet, rugs, or heat-sensitive floor finishes.

TV AND MANTEL CLEARANCE

You can mount a TV or other electrical appliances above the fireplace, either surface-mounted or recessed into the chase. Ensure the TV's base is at least 8" above the top of the glass. For a combustible mantel, install it a minimum of 8" above the fireplace. The mantel's clearance depends on its depth, with greater depth requiring higher clearance. Consult the relevant Escea Install Manual for details.

FINISHES

Use wall finishes of 3/8" to 3/4", either combustible or non-combustible. **Ensure combustible linings DO NOT extend past the finishing trim (5/8" depth) to the edge of the glass.** Wall linings can be bonded directly to the appliance, but avoid blocking air inlets or outlets.

Note: Some installation scenarios can expose materials to higher levels of heat than expected or allowable. Designers, owners, or installers must choose materials that are suitable for use. Consult the Escea website for finish details.

For Installation methods not covered in this document contact: aa@escea.com

Installation Manual and CAD files are available from the Escea website - scan the QR code

