

CONSTRUCTION

The PFS system includes two brackets mounted on the stud framework either side of the fireplace, with telescopic rails spanning between them. This design provides a sturdy internal frame that cantilevers out. The PFS Telescopic Hearth is available in two options:

PFS 1200 Hearth: Suitable for unfinished widths of 1200mm to 1600mm.

PFS 1600 Hearth: Suitable for unfinished widths of 1600mm to 2000mm.

Depth/Height for Both: 300mm depth and 75mm height unfinished.

The PFS Wall brackets combined, will support up to 400kg including finishing materials, regardless of the hearth span.

FINISHING MATERIAL SELECTION

For PFS hearth installations below the fireplace viewing area, account for the hearth lining thickness when positioning brackets.

Escea Electric Fireplaces (LE Series): Telescopic hearths can be finished with standard building materials (combustible or non-combustible) at any height below the fireplace. If the hearth surface is directly below the viewing area, use materials that can withstand up to 60°C.

Escea Gas and Wood Fireplaces: Use non-combustible materials directly below the glass or fascia. Combustible materials may only be used if the hearth's finished height is at least 100mm below the fireplace glass.

PFS INSTALLATION STEPS

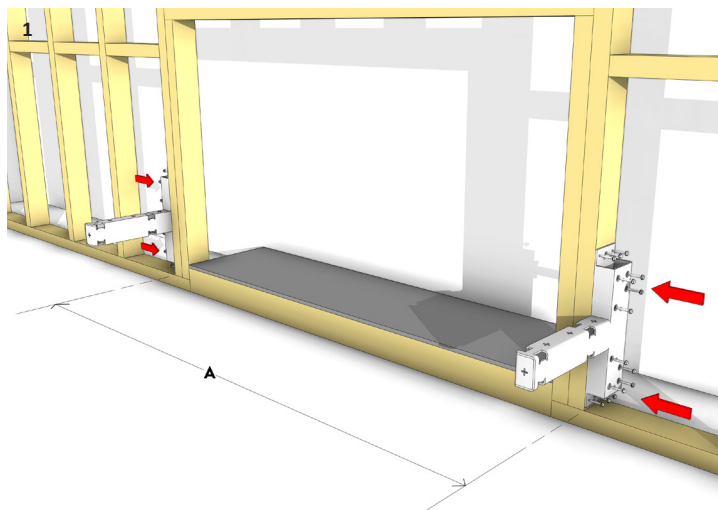

Construct the framework according to the minimum fireplace cavity and stud spacing requirements for PFS brackets. Attach the PFS wall brackets to the framework on each side of the fireplace, ensuring the vertical portions are flush with the framework's front. Secure the brackets to adjacent studs with the supplied 12G x 35mm Tek screws.

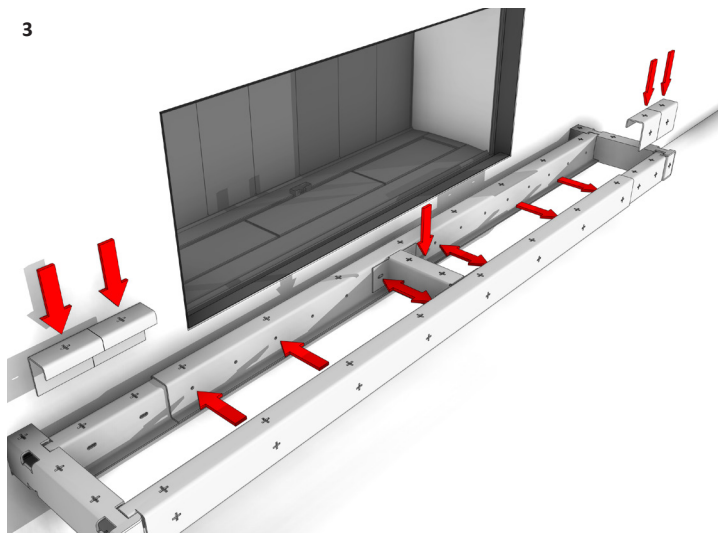

Install the PFS rails between the wall brackets, aligning the holes of the inner and outer telescopic rails. Rails slot into the wall brackets without fastenings. Secure each rail with at least 4x (M6 x 20) hex bolts and nuts. Attach the center bridge rail, bolting centrally using 4 x (M6 x 20) hex bolts and nuts. Use the provided packers on the inner rails for a flush finish; break off the needed amount and glue in place.

PFS HEARTH DIMENSIONS

Finished Hearth Width	(A) Stud Spacing (+/- 5mm)*	PFS Hearth
1200mm	1100mm	PFS1200
1300mm	1200mm	PFS1200
1400mm	1300mm	PFS1200
1500mm	1400mm	PFS1200
1600mm	1500mm	PFS1200/PFS1600
1700mm	1600mm	PFS1600
1800mm	1700mm	PFS1600
1900mm	1800mm	PFS1600
2000mm	1900mm	PFS1600

* Outside Dimensions - PFS wall brackets to be located on the outside of each stud or support framing.

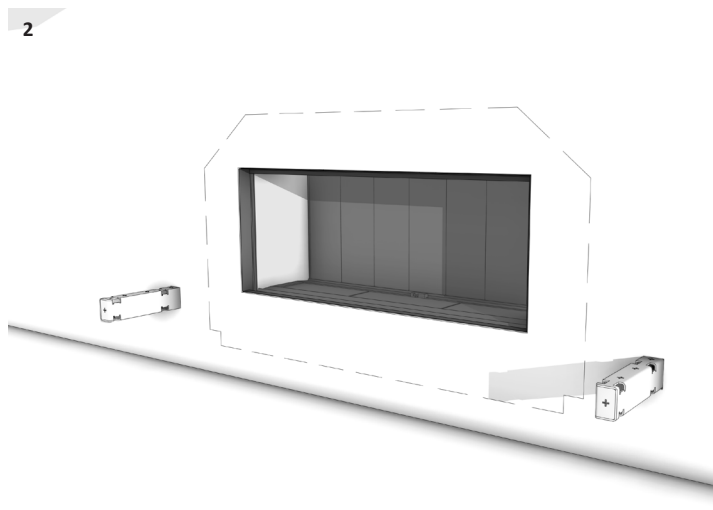

Attach wall linings to the framework and fireplace, maintaining the required gap from the fireplace trim or flange. Allow to cut out the wall lining around the PFS wall brackets. *Escea DS1150 Gas Fireplace shown.*

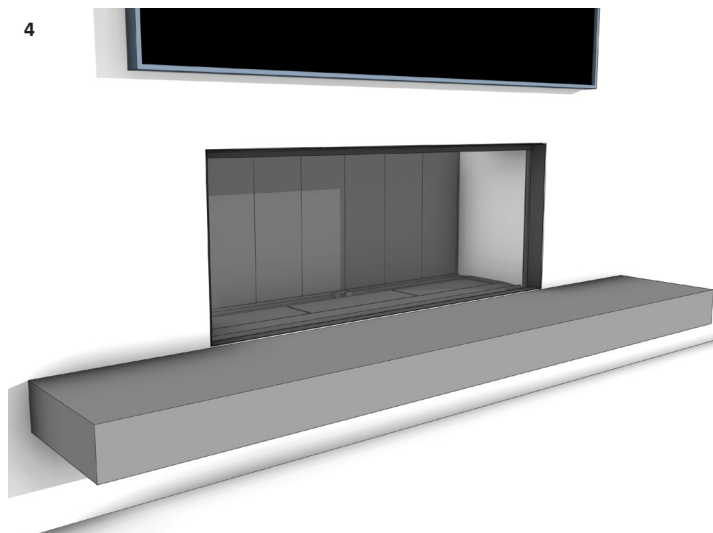

Complete the project by adding finishes to the hearth. Materials can be glue fixed with daubs of adhesive on the cross marks. Any material directly below an Escea Gas or Wood Fireplace must be non-combustible and heat resistant.