

SILL DETAIL
Scale: 1:5

B HEAD FLASHING DETAIL
Scale: 1:5

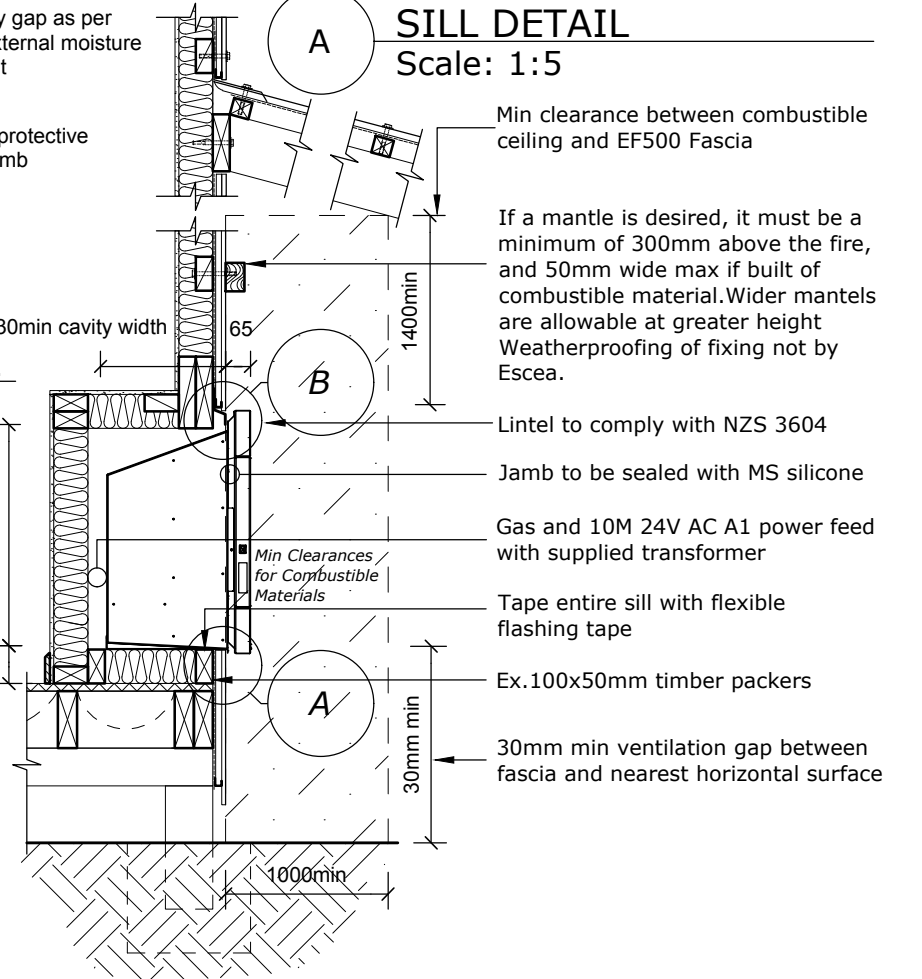
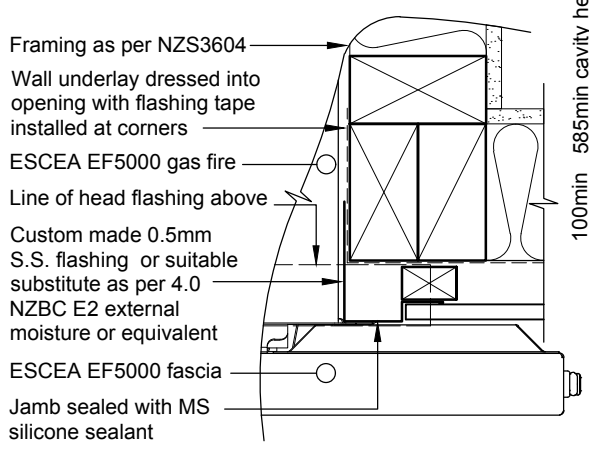

1 CROSS SECTION THROUGH FIRE
Scale: 1:20

C JAMB FLASHING DETAIL
Scale: 1:5

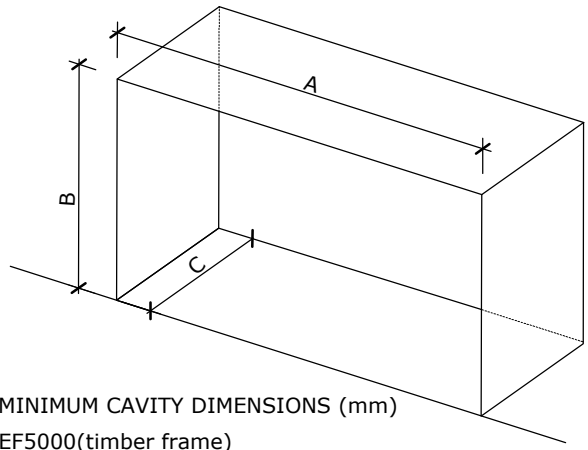
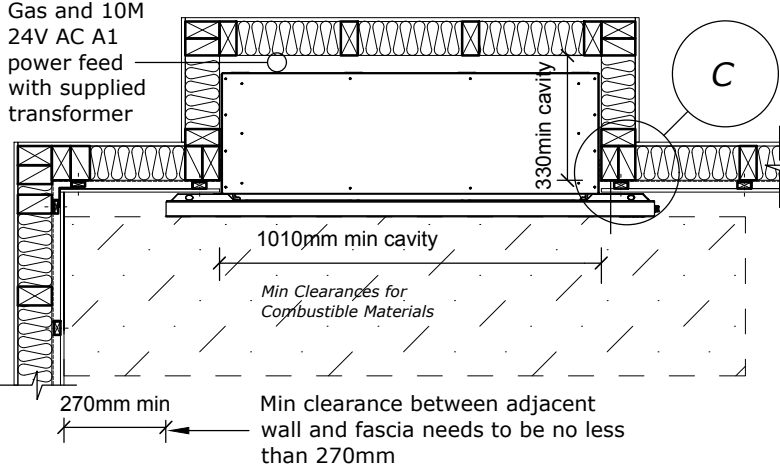

MINIMUM CAVITY DIMENSIONS (mm)

EF5000(timber frame)		
A	B	C
1010	585	330

2 DETAIL PLAN OF FIRE
Scale: 1:20

Where possible it is recommended that the cavity is made a little larger than the above dimensions to give the installer the maximum amount of space to work in.

escea.
17 Carnforth Street
Dunedin, 9018
New Zealand

DRAWING TITLE: EF5000 EXTERNAL WALL INSTALLATION			
SCALE AT A4: AS SHOWN	DATE: 20/01/2016	DRAWN BY: BC	CHECKED BY: RM
DRAWING NO: EDA0002	ECN NO: ECN2150	REVISION NO: 0002	

NOTE:ESCEA EF5000 gas fire is designed for outdoor use only. This appliance requires no flue and must be permanently installed into a cavity.

GENERAL CONSTRUCTION AND CLADDING SHOWN INDICATIVE ONLY