

**Plan**

scale 1:20

**Notes:**

- All dimensions are in mm. DO NOT SCALE OFF THESE DRAWINGS.
- This detail is to assist in the installation of a **EK1550 Outdoor Fireplace Kitchen** into the exterior of a building, within a concrete cavity.
- Parts of this fire and the cavity into which it is installed, may get hot during operation. Where required, ensure materials used are heat resistant and non-combustible. Escea takes no responsibility for material selection.
- Maintain **50mm clearance** from the concrete cavity to any combustible material.
- For flue detailing above the roof line, refer to the requisite Concrete Flue Technical Detail, which can be found at [www.escea.com](http://www.escea.com)
- This technical sheet must be read in conjunction with the EK Series Installation Manual, the latest version can be found on our website at [www.escea.com](http://www.escea.com)

GENERAL CONSTRUCTION AND FINISHES SHOWN INDICATIVE ONLY

Contact the **ESCEA Architectural Advisory Team** for assistance with the specification of this fire - [aa@escea.com](mailto:aa@escea.com)

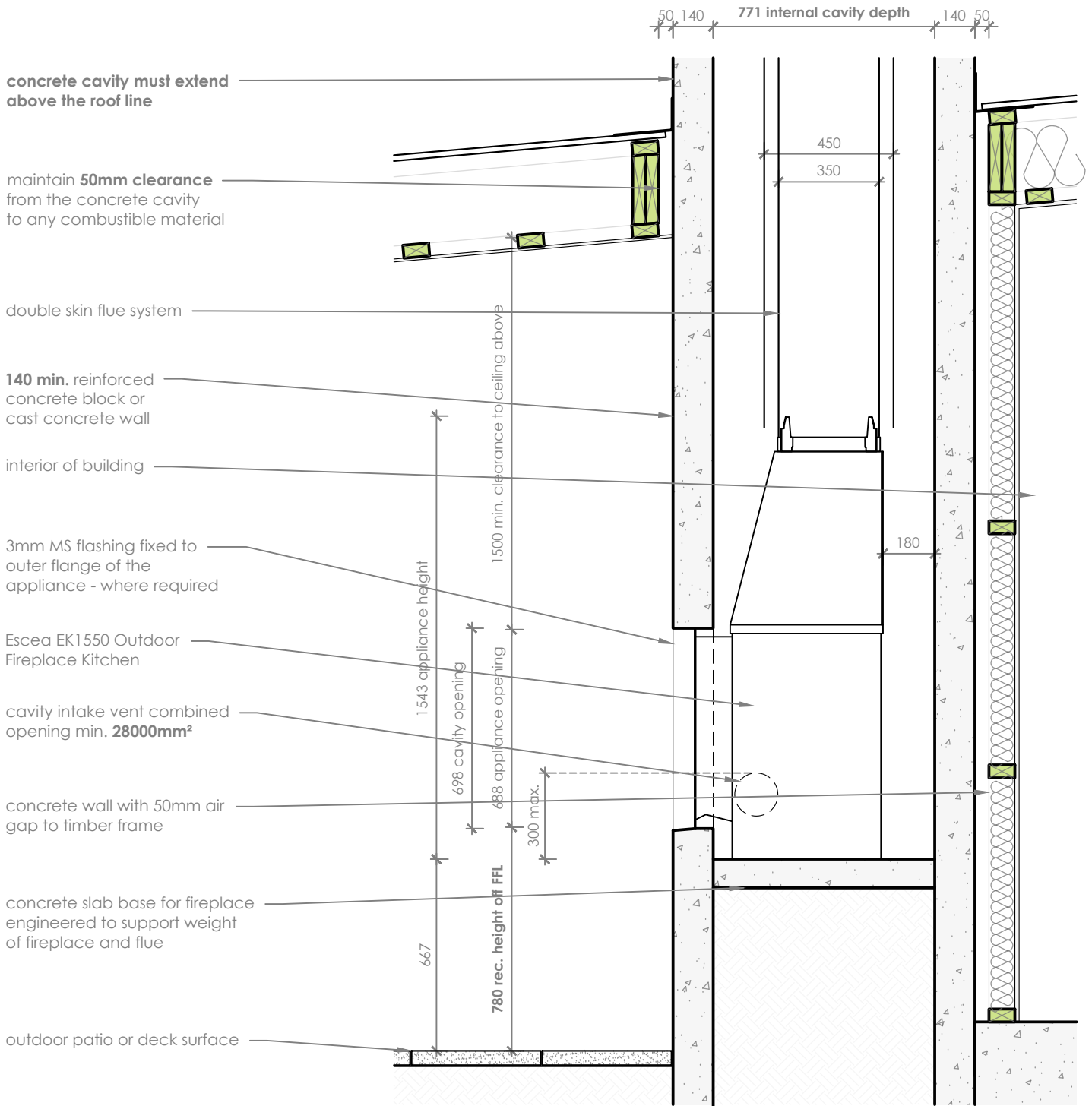

**Section - Side**

scale 1:20

**Notes:**

- All dimensions are in mm. DO NOT SCALE OFF THESE DRAWINGS.
- This detail is to assist in the installation of a **EK1550 Outdoor Fireplace Kitchen** into the exterior of a building, within a concrete cavity.
- Parts of this fire and the cavity into which it is installed, may get hot during operation. Where required, ensure materials used are heat resistant and non-combustible. Escea takes no responsibility for material selection.
- Maintain **50mm clearance** from the concrete cavity to any combustible material.
- For flue detailing above the roof line, refer to the requisite Concrete Flue Technical Detail, which can be found at [www.escea.com](http://www.escea.com)
- This technical sheet must be read in conjunction with the EK Series Installation Manual, the latest version can be found on our website at [www.escea.com](http://www.escea.com)

GENERAL CONSTRUCTION AND FINISHES SHOWN INDICATIVE ONLY

Contact the **ESCEA Architectural Advisory Team** for assistance with the specification of this fire - [aa@escea.com](mailto:aa@escea.com)

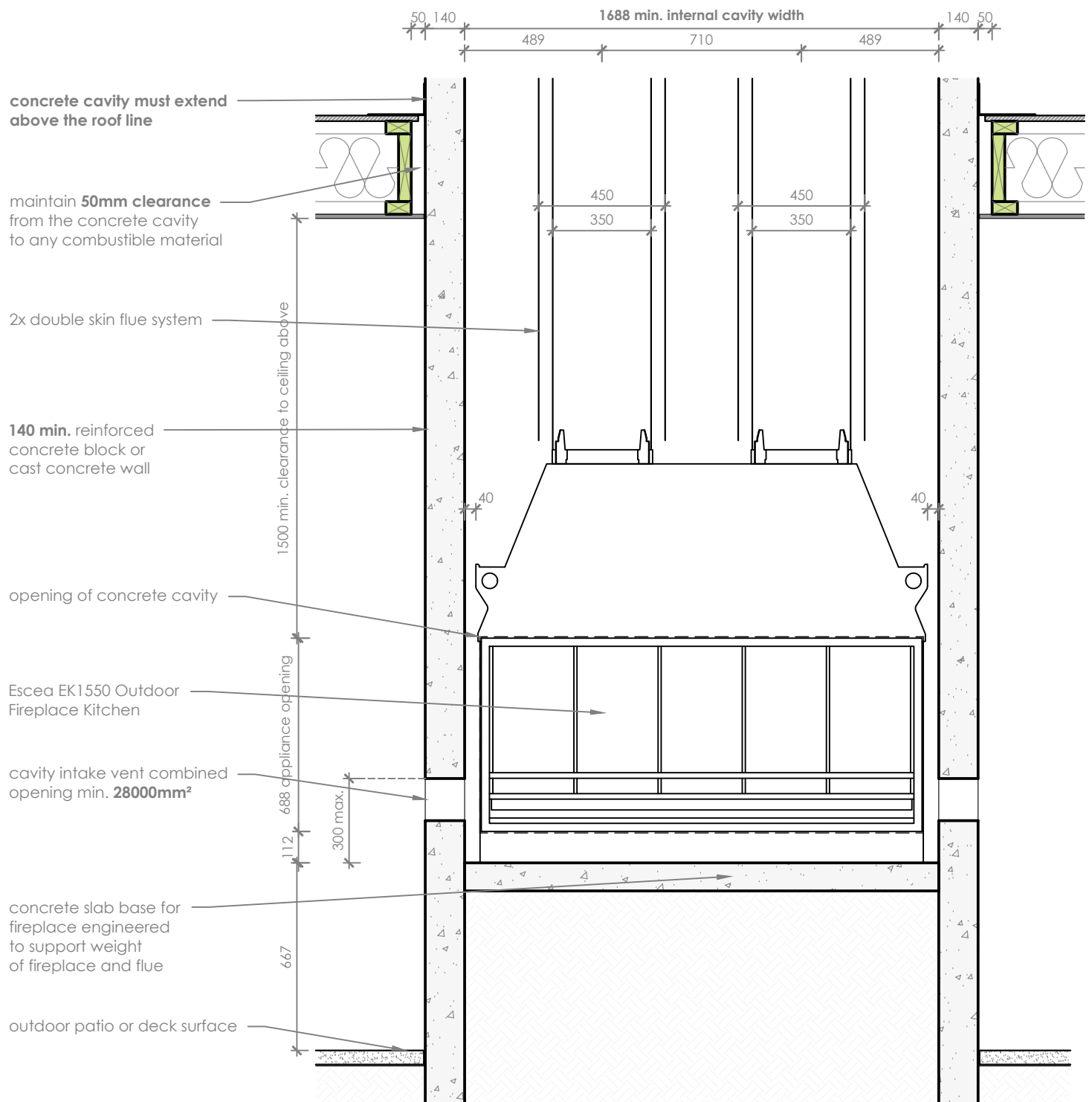

## Section - Front

scale 1:20

### Notes:

- All dimensions are in mm. DO NOT SCALE OFF THESE DRAWINGS.
- This detail is to assist in the installation of a **EK1550 Outdoor Fireplace Kitchen** into the exterior of a building, within a concrete cavity.
- Parts of this fire and the cavity into which it is installed, may get hot during operation. Where required, ensure materials used are heat resistant and non-combustible. Escea takes no responsibility for material selection.
- Restrain the fire from movement by fixing to the supporting base through the provided holes in the base of the fireplace.
- For flue detailing above the roof line, refer to the requisite Concrete Flue Technical Detail, which can be found at [www.escea.com](http://www.escea.com)
- This technical sheet must be read in conjunction with the EK Series Installation Manual, the latest version can be found on our website at [www.escea.com](http://www.escea.com)

GENERAL CONSTRUCTION AND FINISHES SHOWN INDICATIVE ONLY

Contact the ESCEA Architectural Advisory Team for assistance with the specification of this fire - [aa@escea.com](mailto:aa@escea.com)