

**Head Detail**

scale 1:1

**Notes:**

- DO NOT SCALE OFF THESE DRAWINGS. All dimensions are in mm.
- This detail is to assist in the installation of a **Natural or Engineered Stone finish** to the DF700, DF960 or DF990 Gas Fireplace.
- Finish detail also applicable to the side of the appliance.
- Consider noise attenuation within timber framed cavities. It is advisable to restrain fire to avoid movement.
- Ensure to lower standoff brackets at the top of the fire prior to closing in.
- Powdercoated fascia's can be easily damaged - handle with care.
- This technical sheet must be read in conjunction with the Escea DF Series Installation Manual, the latest version can be found on our website at [www.escea.com](http://www.escea.com).

GENERAL CONSTRUCTION AND FINISHES SHOWN INDICATIVE ONLY

Contact the **ESCEA Architectural Advisory Team** for assistance with the specification of this fire - [aa@escea.com](mailto:aa@escea.com)

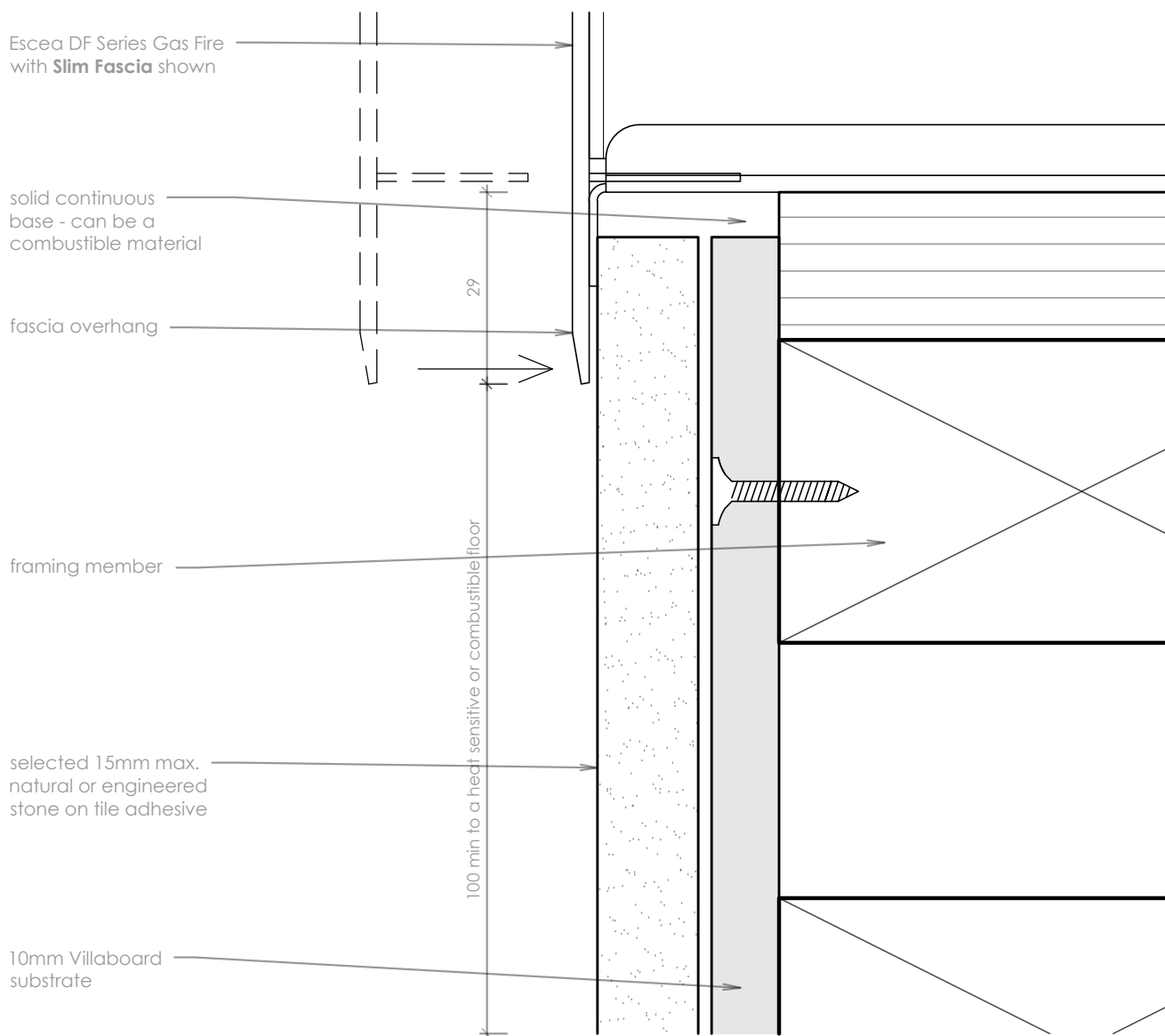

**Base Detail**

scale 1:1

**Notes:**

- This detail is to assist in the installation of a **Natural or Engineered Stone finish** to the DF700, DF960 or DF990 Gas Fireplace.
- Consider noise attenuation within timber framed cavities. It is advisable to restrain fire to avoid movement.
- Powdercoated fascia's can be easily damaged - handle with care.
- Give consideration to the overhang of the fascia when setting up the fire - base of the appliance must be at least 30mm above the any adjacent horizontal surface.
- This technical sheet must be read in conjunction with the Escea DF Series Installation Manual, the latest version can be found on our website at [www.escea.com](http://www.escea.com).

GENERAL CONSTRUCTION AND FINISHES SHOWN INDICATIVE ONLY

Contact the **ESCEA Architectural Advisory Team** for assistance with the specification of this fire - [aa@escea.com](mailto:aa@escea.com)