

Section Detail

1:10

Notes:

- DO NOT SCALE OFF THESE DRAWINGS. All dimensions are in mm.
- This detail sheet is to assist in the installation of a DF960 Gas Fire with an **Escea Timber Mantel**.
- Combustible materials directly above the fireplace, may be susceptible to high levels of heat (outside compliance with AS/NZS5601) if the above detailing is not adhered to. Ensure DF990 spacer bracket is used.
- Raise the base of the fire up off finished floor level a minimum of 65mm, to allow for the infill panel below the fire.
- This technical sheet must be read in conjunction with the Escea DF Series Installation Manual, the latest version can be found on our website at www.escea.com.

GENERAL CONSTRUCTION AND FINISHES SHOWN INDICATIVE ONLY

Contact the ESCEA Architectural Advisory Team for assistance with the specification of this fire - aa@escea.com

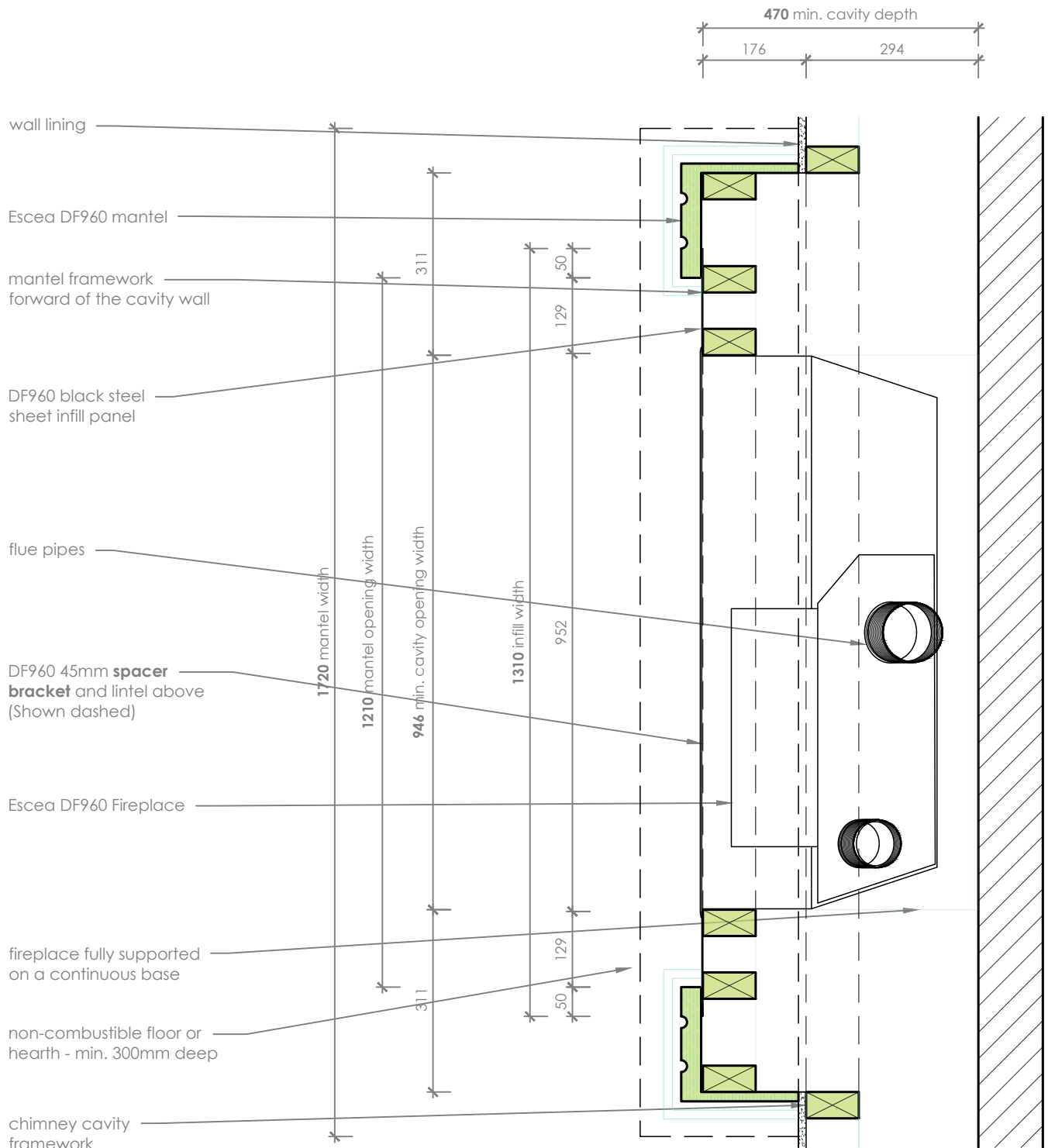

Plan Detail

1:10

Notes:

- DO NOT SCALE OFF THESE DRAWINGS. All dimensions are in mm.
- This detail sheet is to assist in the installation of a DF960 Gas Fire with an **Escea Timber Mantel**.
- Combustible materials directly above the fireplace, may be susceptible to high levels of heat (outside compliance with AS/NZS5601) if the above detailing is not adhered to. Ensure DF990 spacer bracket is used.
- Raise the base of the fire up off finished floor level a minimum of 65mm, to allow for the infill panel below the fire.
- This technical sheet must be read in conjunction with the Escea DF Series Installation Manual, the latest version can be found on our website at www.escea.com.

GENERAL CONSTRUCTION AND FINISHES SHOWN INDICATIVE ONLY

Contact the ESCEA Architectural Advisory Team for assistance with the specification of this fire - aa@escea.com