

Prolonged unprotected exposure to heat may be detrimental to the appearance or long term performance of the wall lining. Always choose materials suitable for the specification around a fireplace.

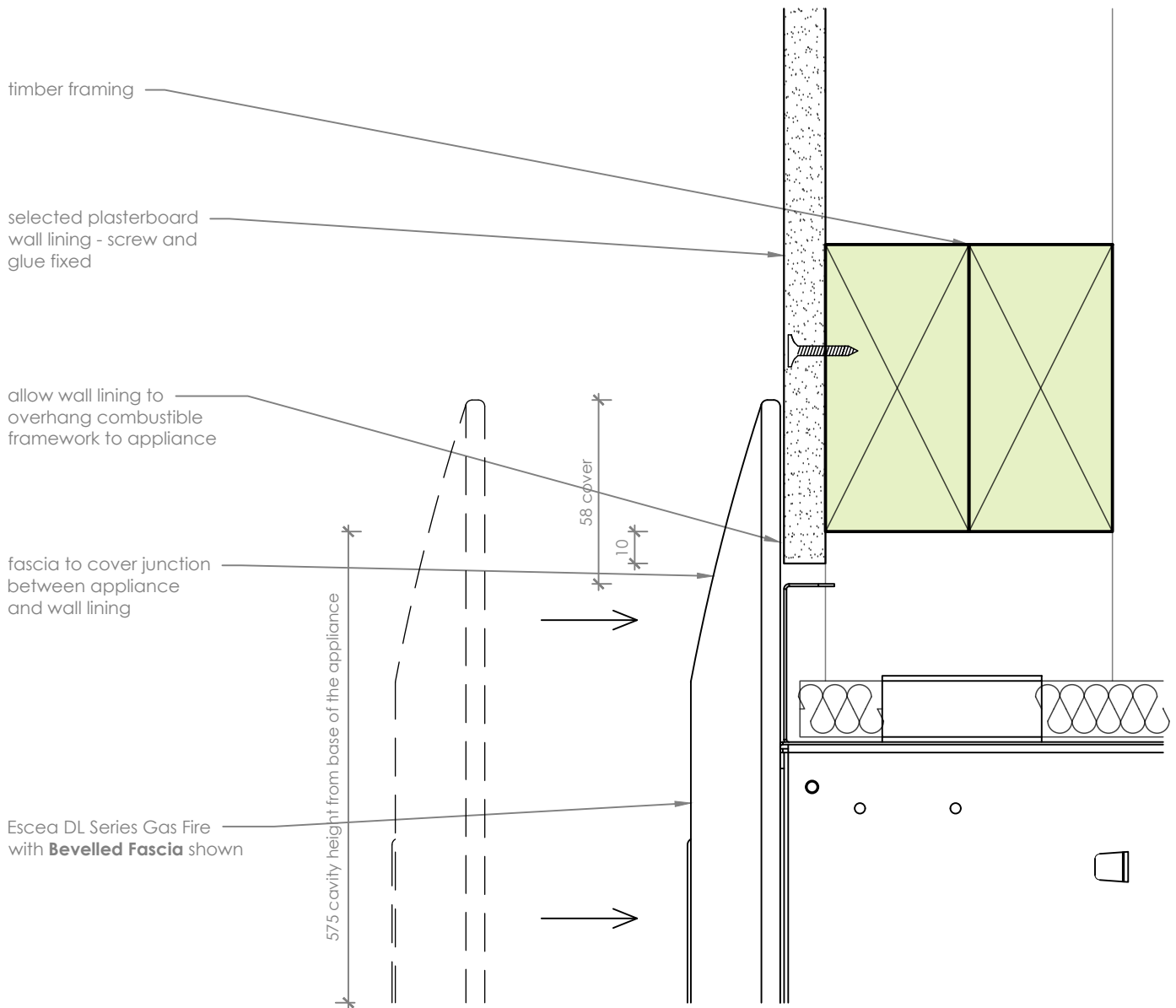

Head Detail

scale 1:2

Notes:

- DO NOT SCALE OFF THESE DRAWINGS. All dimensions are in mm.
- This detail is to assist in the installation of a **plasterboard finish** to the DL850 or DL1100 Gas Fireplace.
- Consider noise attenuation within timber framed cavities. It is advisable to restrain fire and flue to avoid movement.
- Finish detail also applicable to the side of the appliance.
- Powdercoated fascia's can be easily damaged - handle with care.
- This technical sheet must be read in conjunction with the Escea DL Series Installation Manual, the latest version can be found on our website at www.escea.com.

GENERAL CONSTRUCTION AND FINISHES SHOWN INDICATIVE ONLY

Contact the ESCEA Architectural Advisory Team for assistance with the specification of this fire - aa@escea.com

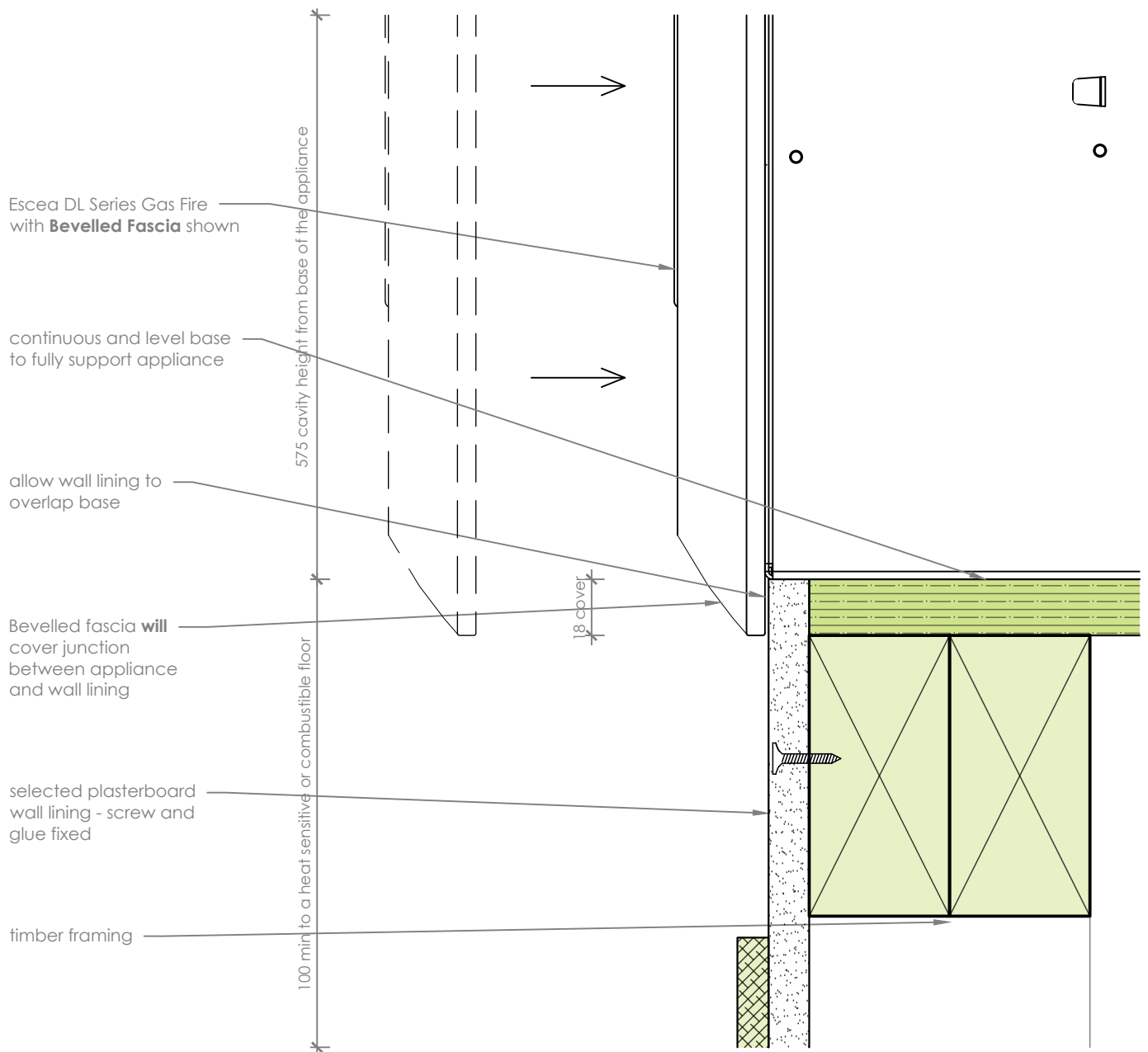
**Base Detail**

scale 1:2

Notes:

- DO NOT SCALE OFF THESE DRAWINGS. All dimensions are in mm.
- This detail is to assist in the installation of a **plasterboard finish** to the DL850 or DL1100 Gas Fireplace.
- Consider noise attenuation within timber framed cavities. It is advisable to restrain fire and flue to avoid movement.
- Finish detail also applicable to the side of the appliance.
- Powdercoated fascia's can be easily damaged - handle with care.
- This technical sheet must be read in conjunction with the Escea DL Series Installation Manual, the latest version can be found on our website at www.escea.com.

GENERAL CONSTRUCTION AND FINISHES SHOWN INDICATIVE ONLY

Contact the ESCEA Architectural Advisory Team for assistance with the specification of this fire - aa@escea.com

Prolonged unprotected exposure to heat may be detrimental to the appearance or long term performance of the wall lining. Always choose materials suitable for the specification around a fireplace.

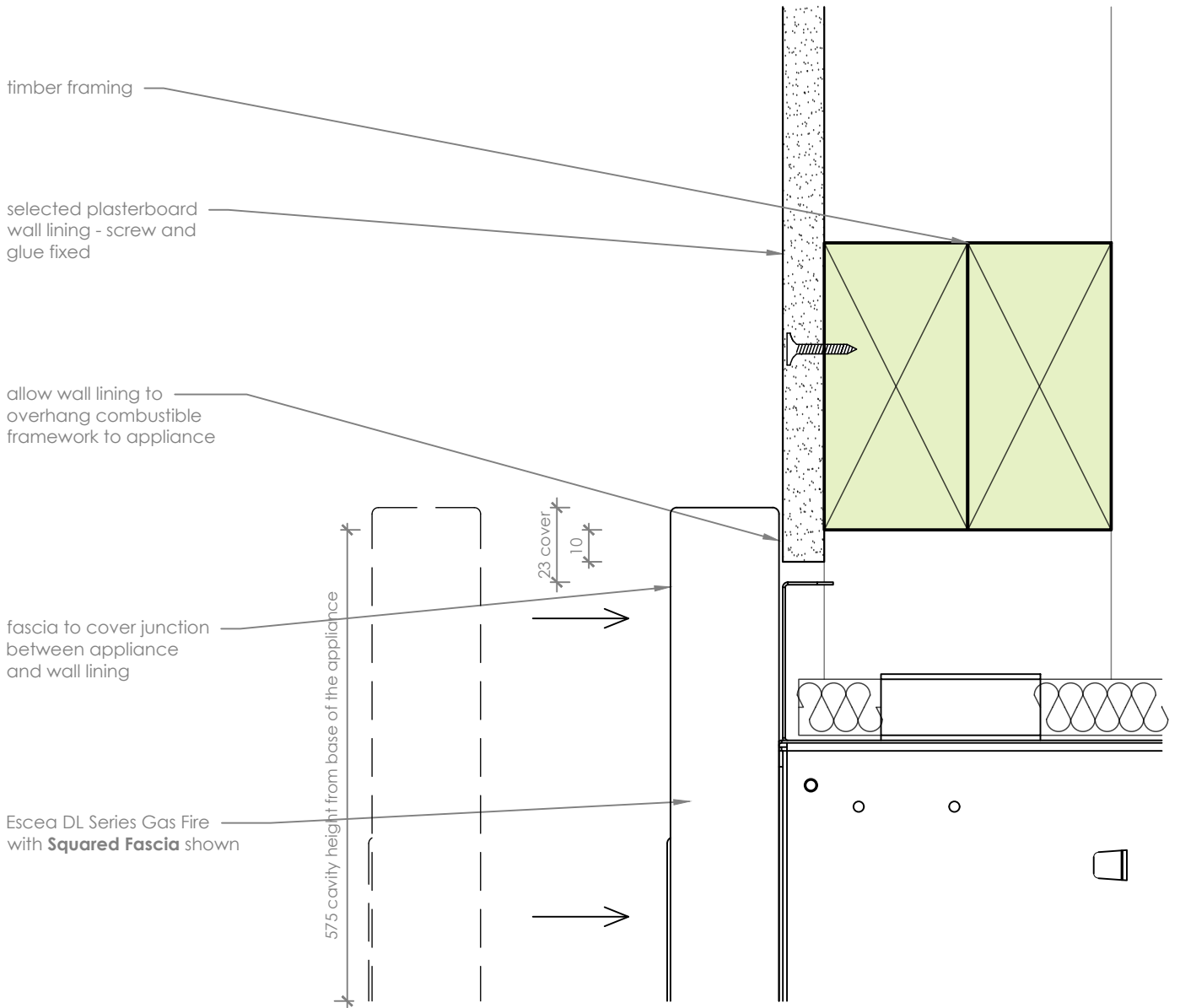

Head Detail

scale 1:2

Notes:

- DO NOT SCALE OFF THESE DRAWINGS. All dimensions are in mm.
- This detail is to assist in the installation of a **plasterboard finish** to the DL850 or DL1100 Gas Fireplace.
- Consider noise attenuation within timber framed cavities. It is advisable to restrain fire and flue to avoid movement.
- Finish detail also applicable to the side of the appliance.
- Powdercoated fascia's can be easily damaged - handle with care.
- This technical sheet must be read in conjunction with the Escea DL Series Installation Manual, the latest version can be found on our website at www.escea.com.

GENERAL CONSTRUCTION AND FINISHES SHOWN INDICATIVE ONLY

Contact the ESCEA Architectural Advisory Team for assistance with the specification of this fire - aa@escea.com

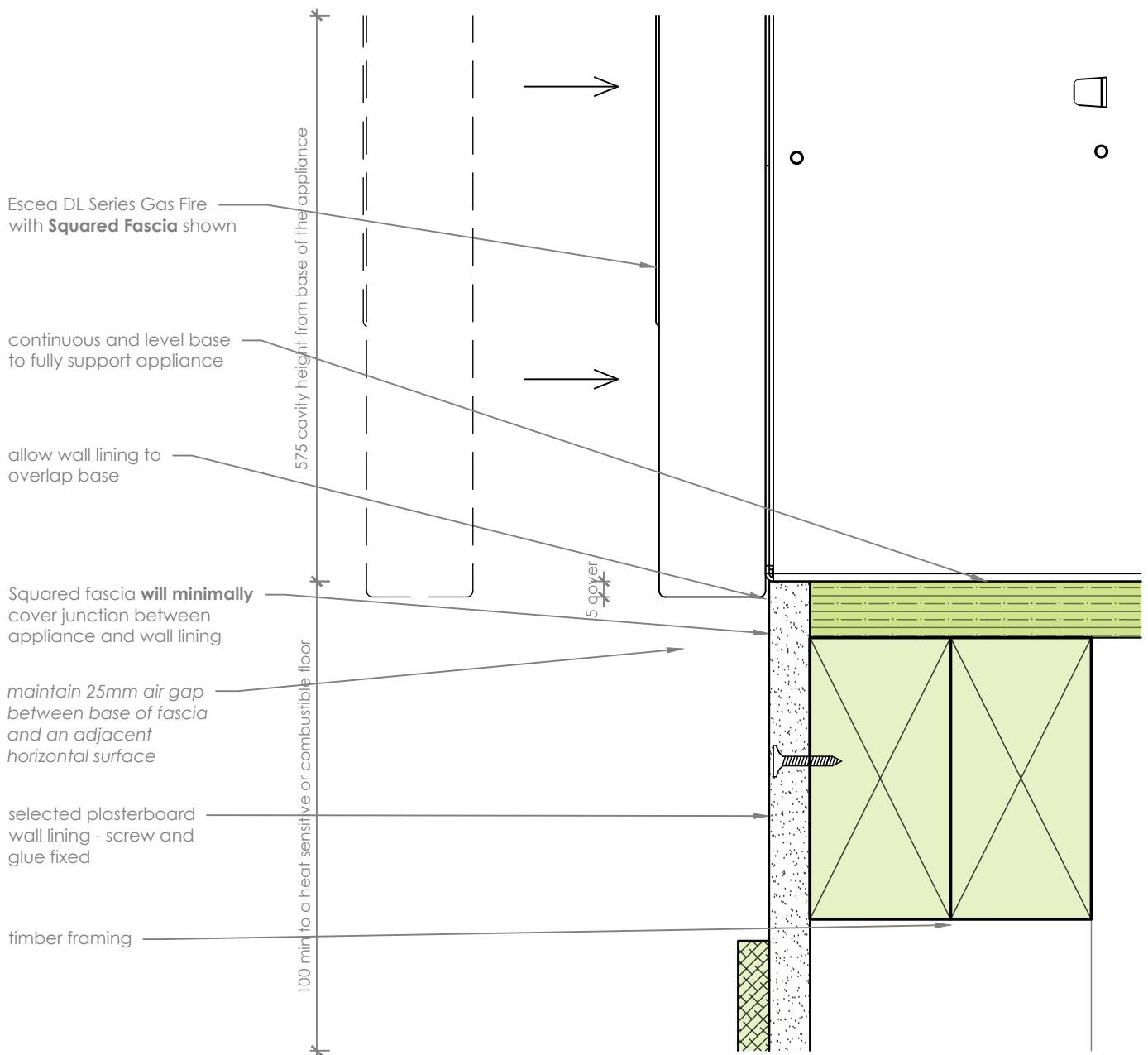
**Base Detail**

scale 1:2

Notes:

- DO NOT SCALE OFF THESE DRAWINGS. All dimensions are in mm.
- This detail is to assist in the installation of a **plasterboard finish** to the DL850 or DL1100 Gas Fireplace.
- Consider noise attenuation within timber framed cavities. It is advisable to restrain fire and flue to avoid movement.
- Finish detail also applicable to the side of the appliance.
- Powdercoated fascia's can be easily damaged - handle with care.
- This technical sheet must be read in conjunction with the Escea DL Series Installation Manual, the latest version can be found on our website at www.escea.com.

GENERAL CONSTRUCTION AND FINISHES SHOWN INDICATIVE ONLY

Contact the ESCEA Architectural Advisory Team for assistance with the specification of this fire - aa@escea.com

Prolonged unprotected exposure to heat may be detrimental to the appearance or long term performance of the wall lining. Always choose materials suitable for the specification around a fireplace.

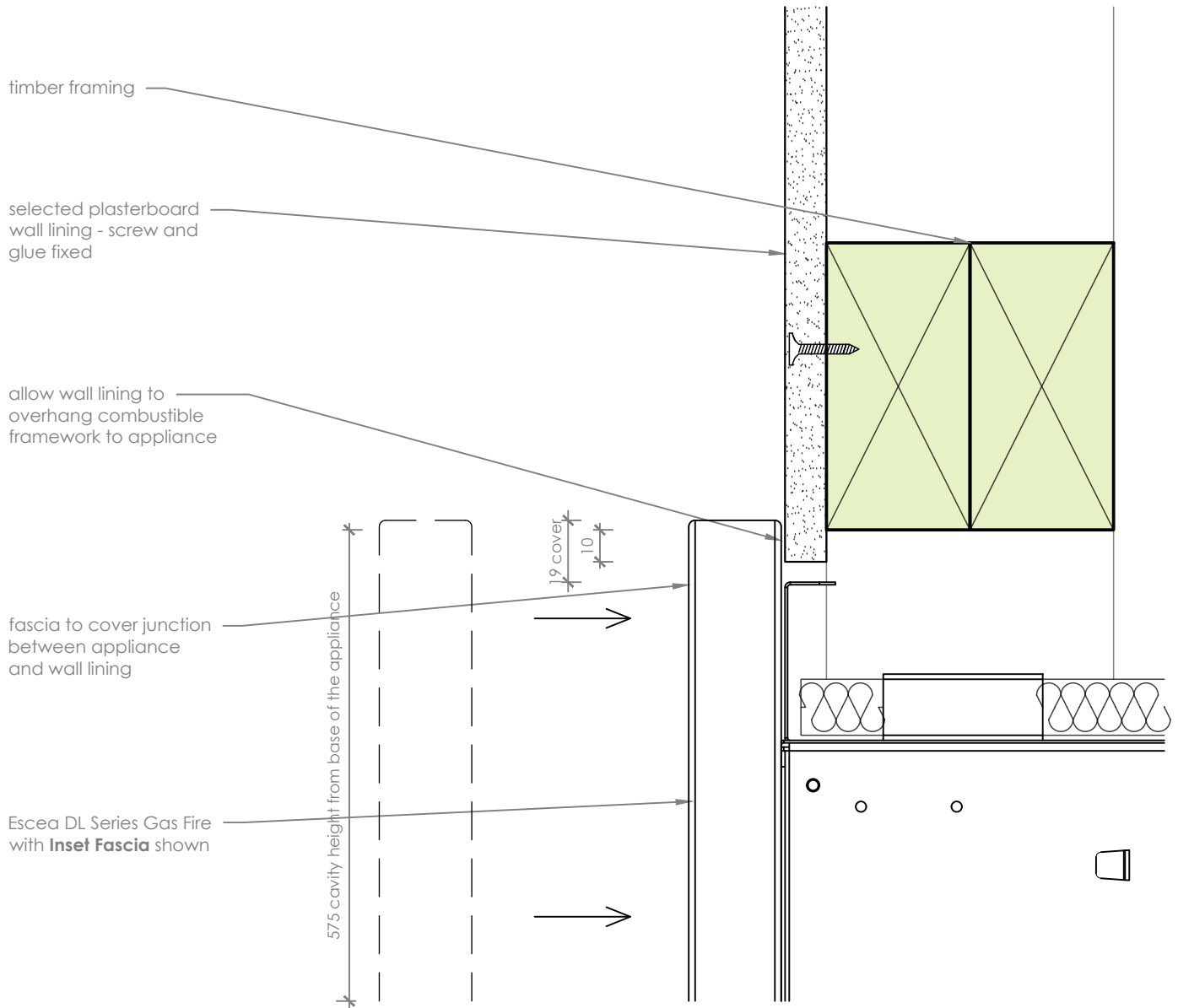

Head Detail

scale 1:2

Notes:

- DO NOT SCALE OFF THESE DRAWINGS. All dimensions are in mm.
- This detail is to assist in the installation of a **plasterboard finish** to the DL850 or DL1100 Gas Fireplace.
- Consider noise attenuation within timber framed cavities. It is advisable to restrain fire and flue to avoid movement.
- Finish detail also applicable to the side of the appliance.
- Powdercoated fascia's can be easily damaged - handle with care.
- This technical sheet must be read in conjunction with the Escea DL Series Installation Manual, the latest version can be found on our website at www.escea.com.

GENERAL CONSTRUCTION AND FINISHES SHOWN INDICATIVE ONLY

Contact the ESCEA Architectural Advisory Team for assistance with the specification of this fire - aa@escea.com

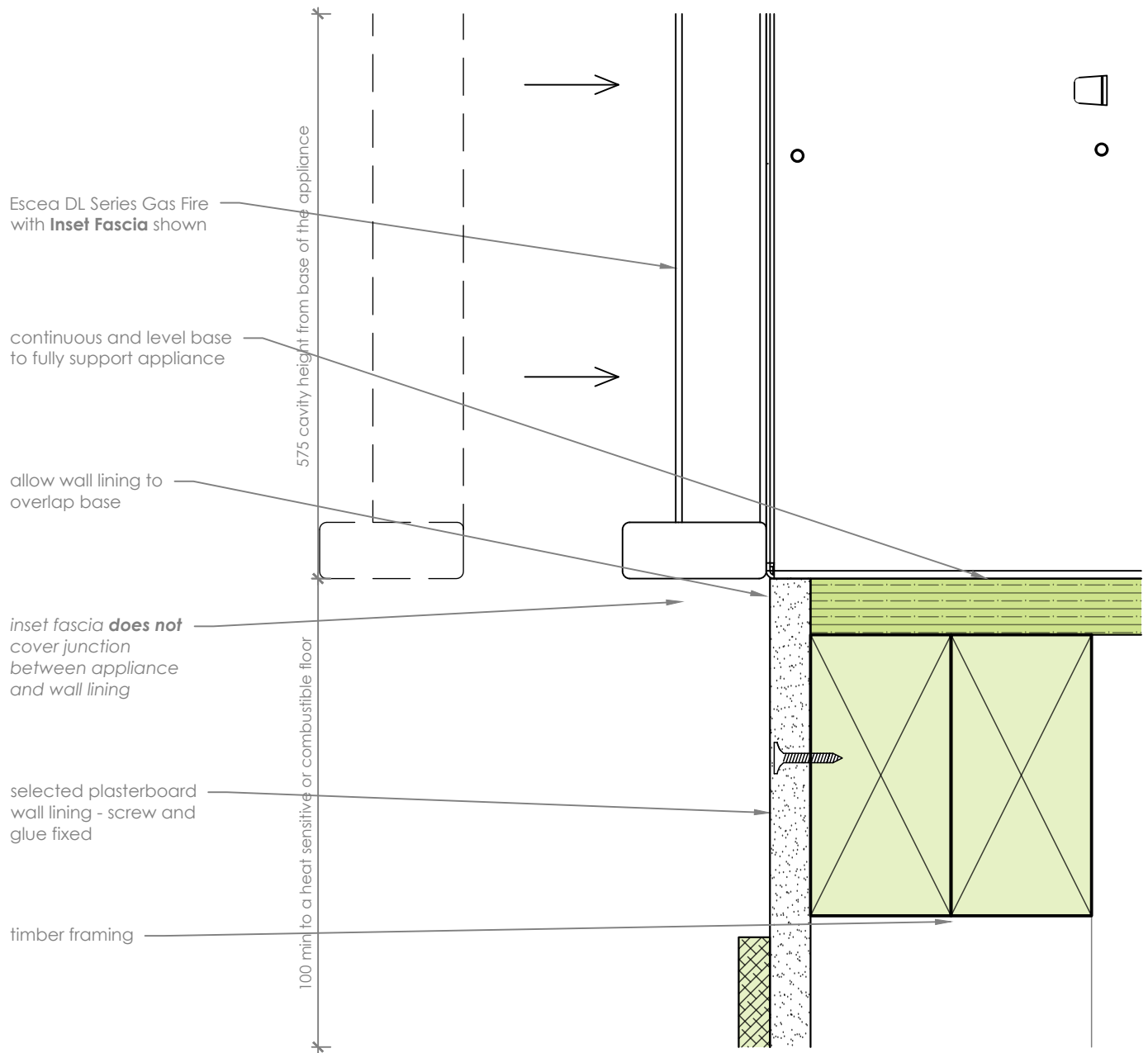

Base Detail

scale 1:2

Notes:

- DO NOT SCALE OFF THESE DRAWINGS. All dimensions are in mm.
- This detail is to assist in the installation of a **plasterboard finish** to the DL850 or DL1100 Gas Fireplace.
- Consider noise attenuation within timber framed cavities. It is advisable to restrain fire and flue to avoid movement.
- Finish detail also applicable to the side of the appliance.
- Powdercoated fascia's can be easily damaged - handle with care.
- This technical sheet must be read in conjunction with the Escea DL Series Installation Manual, the latest version can be found on our website at www.escea.com.

GENERAL CONSTRUCTION AND FINISHES SHOWN INDICATIVE ONLY

Contact the ESCEA Architectural Advisory Team for assistance with the specification of this fire - aa@escea.com