**Head Detail**

scale 1:2

**Notes:**

- DO NOT SCALE OFF THESE DRAWINGS. All dimensions are in mm.
- This detail is to assist in the installation of a **stacked stone finish** to the DL850 or DL1100 Gas Fireplace.
- Consider noise attenuation within timber framed cavities. It is advisable to restrain fire and flue to avoid movement.
- Finish detail also applicable to the side of the appliance.
- Powdercoated fascia's can be easily damaged - handle with care.
- This technical sheet must be read in conjunction with the Escea DL Series Installation Manual, the latest version can be found on our website at [www.escea.com](http://www.escea.com).

GENERAL CONSTRUCTION AND FINISHES SHOWN INDICATIVE ONLY

Contact the ESCEA Architectural Advisory Team for assistance with the specification of this fire - [aa@escea.com](mailto:aa@escea.com)

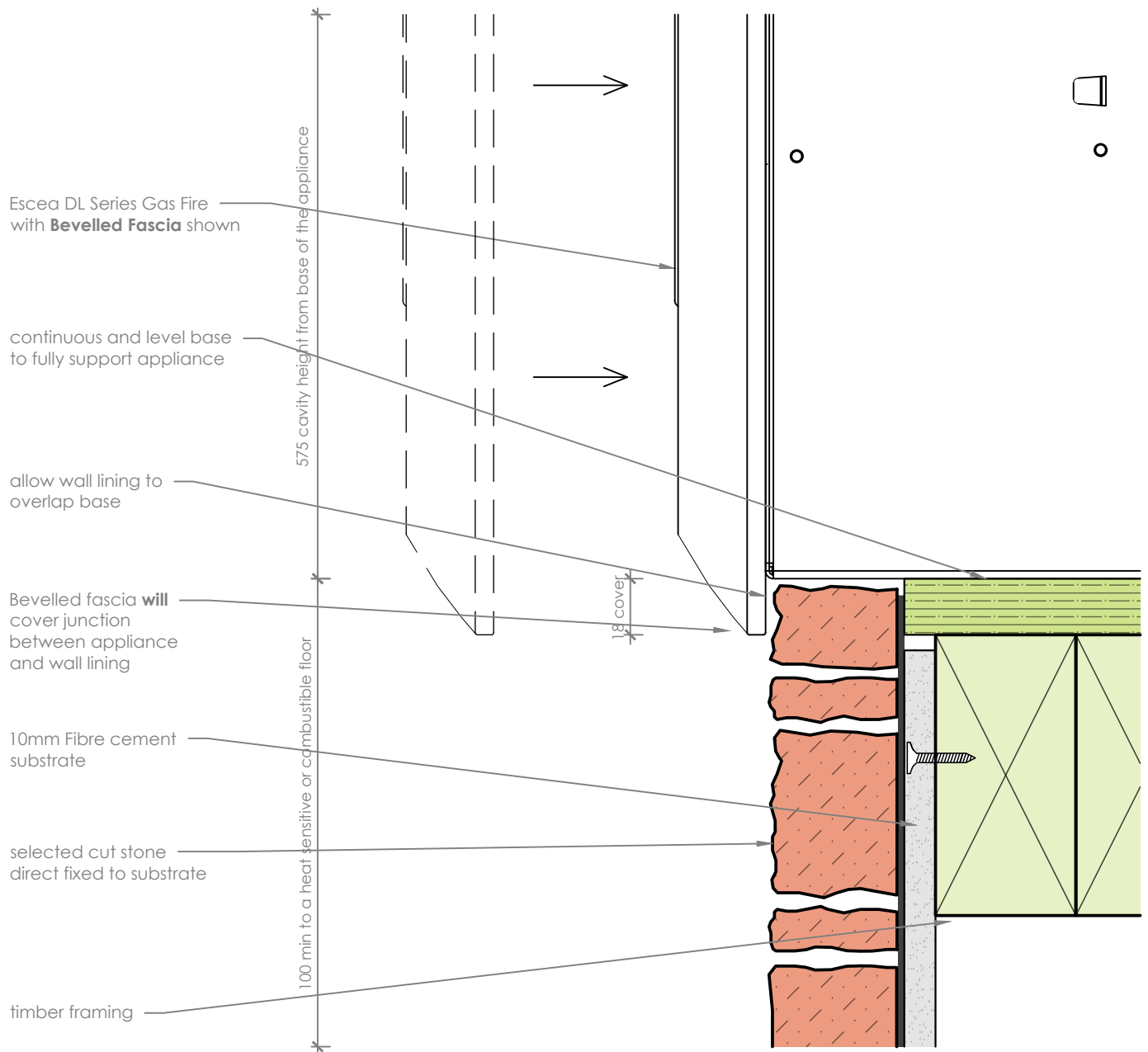
**Base Detail**

scale 1:2

**Notes:**

- DO NOT SCALE OFF THESE DRAWINGS. All dimensions are in mm.
- This detail is to assist in the installation of a **stacked stone finish** to the DL850 or DL1100 Gas Fireplace.
- Consider noise attenuation within timber framed cavities. It is advisable to restrain fire and flue to avoid movement.
- Finish detail also applicable to the side of the appliance.
- Powdercoated fascia's can be easily damaged - handle with care.
- This technical sheet must be read in conjunction with the Escea DL Series Installation Manual, the latest version can be found on our website at [www.escea.com](http://www.escea.com).

GENERAL CONSTRUCTION AND FINISHES SHOWN INDICATIVE ONLY

Contact the ESCEA Architectural Advisory Team for assistance with the specification of this fire - [aa@escea.com](mailto:aa@escea.com)

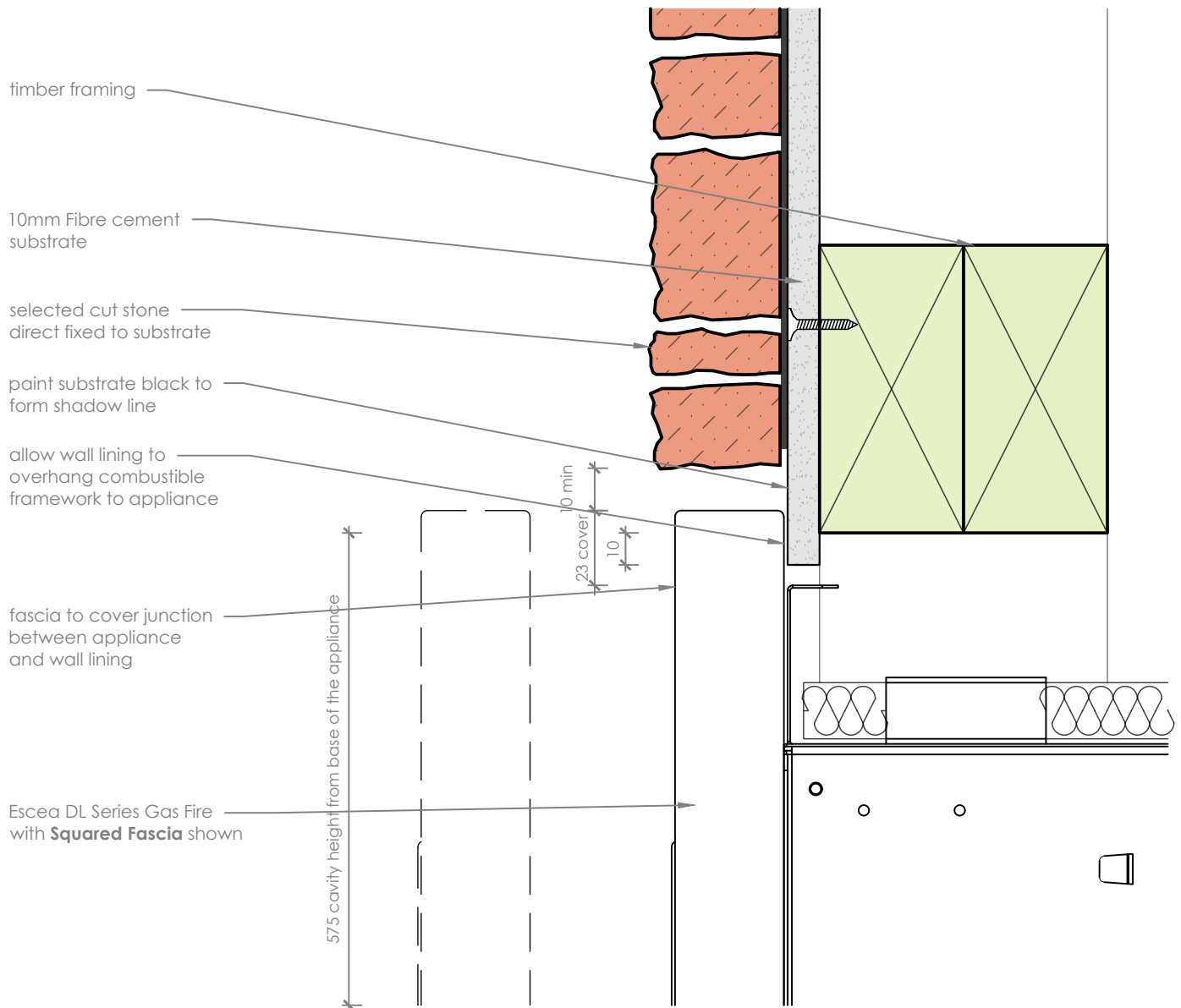
**Head Detail**

scale 1:2

**Notes:**

- DO NOT SCALE OFF THESE DRAWINGS. All dimensions are in mm.
- This detail is to assist in the installation of a **stacked stone finish** to the DL850 or DL1100 Gas Fireplace.
- Consider noise attenuation within timber framed cavities. It is advisable to restrain fire and flue to avoid movement.
- Finish detail also applicable to the side of the appliance.
- Powdercoated fascia's can be easily damaged - handle with care.
- This technical sheet must be read in conjunction with the Escea DL Series Installation Manual, the latest version can be found on our website at [www.escea.com](http://www.escea.com).

GENERAL CONSTRUCTION AND FINISHES SHOWN INDICATIVE ONLY

Contact the ESCEA Architectural Advisory Team for assistance with the specification of this fire - [aa@escea.com](mailto:aa@escea.com)

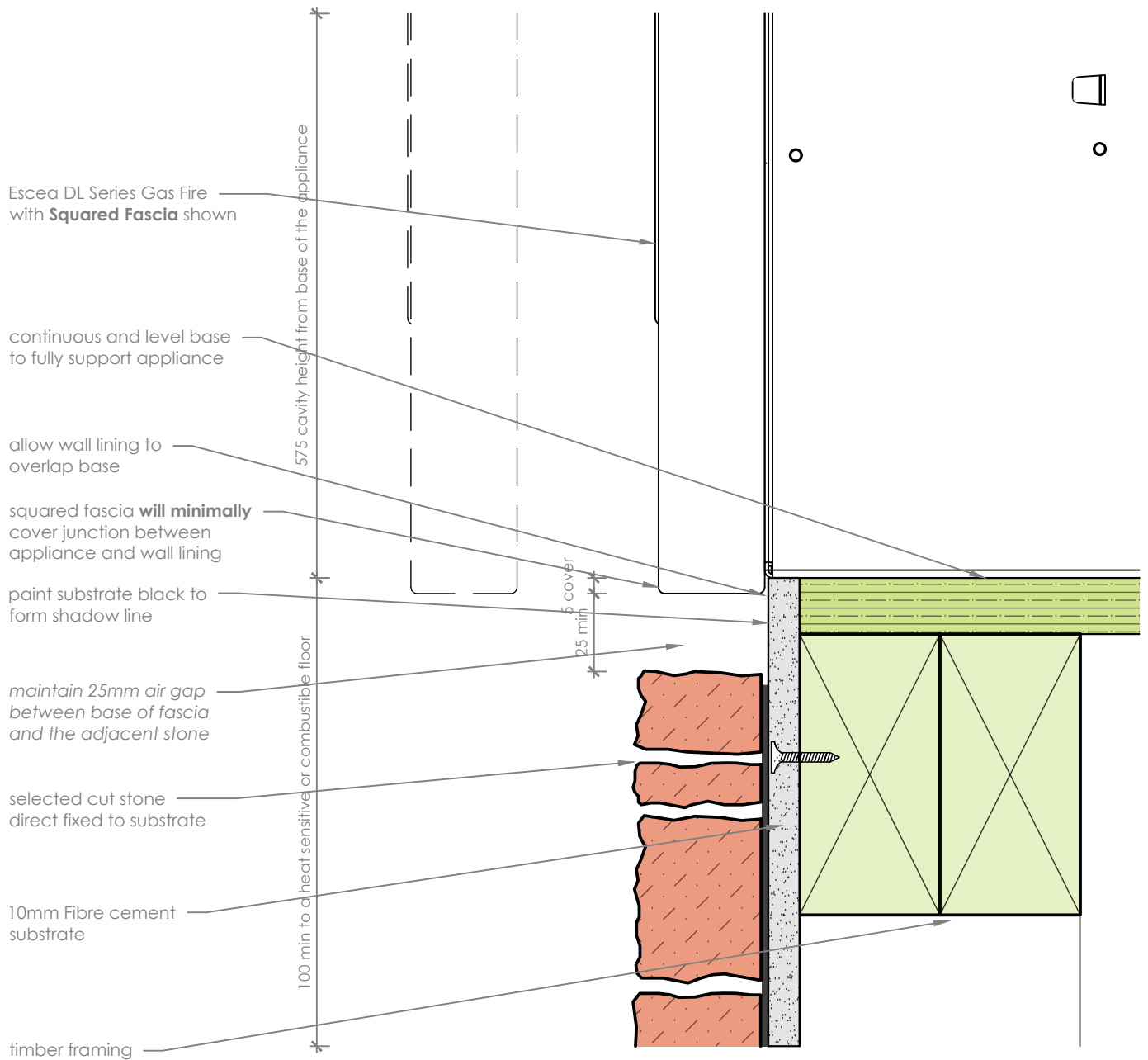
**Base Detail**

scale 1:2

**Notes:**

- DO NOT SCALE OFF THESE DRAWINGS. All dimensions are in mm.
- This detail is to assist in the installation of a **stacked stone finish** to the DL850 or DL1100 Gas Fireplace.
- Consider noise attenuation within timber framed cavities. It is advisable to restrain fire and flue to avoid movement.
- Finish detail also applicable to the side of the appliance.
- Powdercoated fascia's can be easily damaged - handle with care.
- This technical sheet must be read in conjunction with the Escea DL Series Installation Manual, the latest version can be found on our website at [www.escea.com](http://www.escea.com).

GENERAL CONSTRUCTION AND FINISHES SHOWN INDICATIVE ONLY

Contact the ESCEA Architectural Advisory Team for assistance with the specification of this fire - [aa@escea.com](mailto:aa@escea.com)

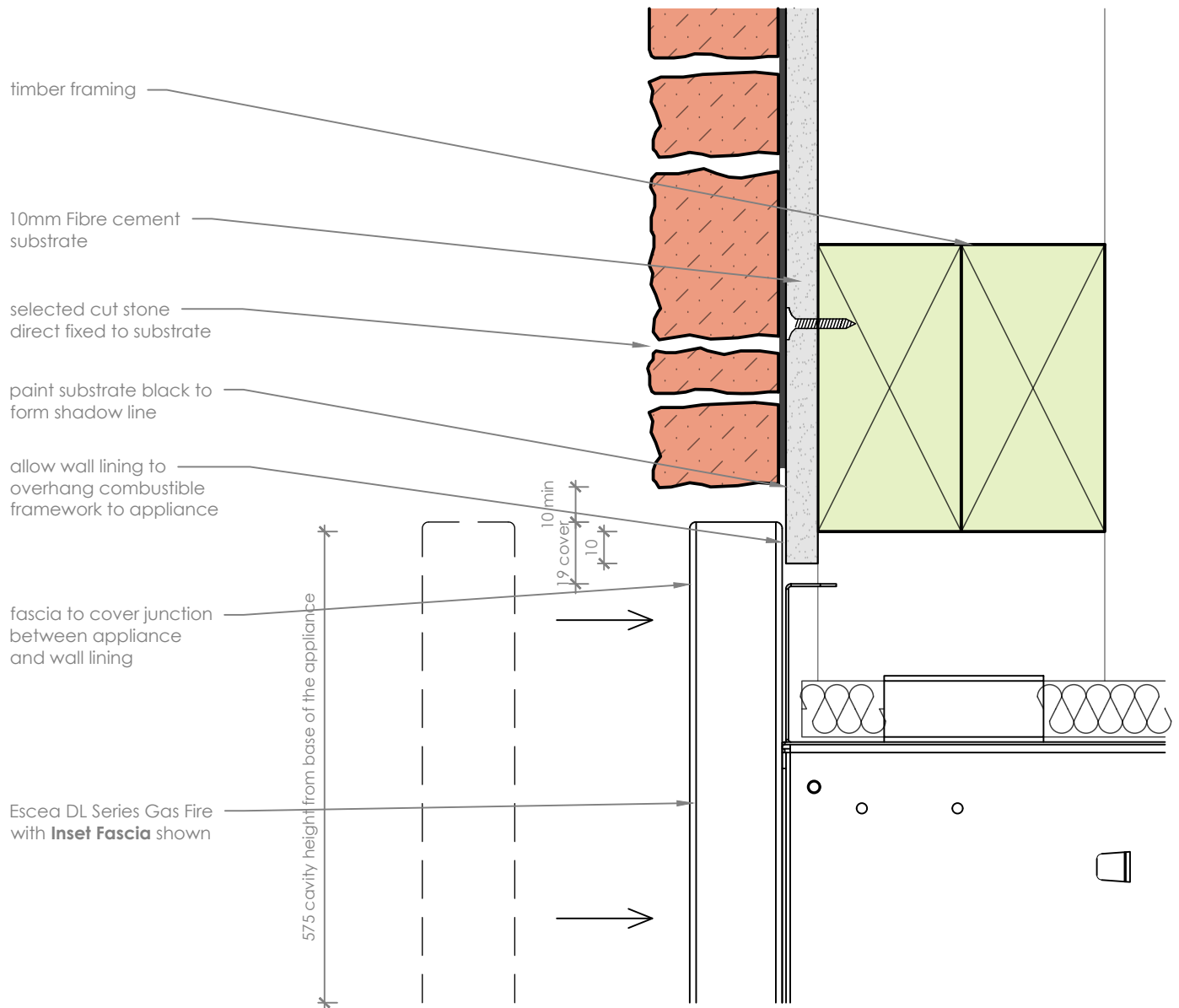

**Head Detail**

scale 1:2

**Notes:**

- DO NOT SCALE OFF THESE DRAWINGS. All dimensions are in mm.
- This detail is to assist in the installation of a **stacked stone finish** to the DL850 or DL1100 Gas Fireplace.
- Consider noise attenuation within timber framed cavities. It is advisable to restrain fire and flue to avoid movement.
- Finish detail also applicable to the side of the appliance.
- Powdercoated fascia's can be easily damaged - handle with care.
- This technical sheet must be read in conjunction with the Escea DL Series Installation Manual, the latest version can be found on our website at [www.escea.com](http://www.escea.com).

GENERAL CONSTRUCTION AND FINISHES SHOWN INDICATIVE ONLY

Contact the ESCEA Architectural Advisory Team for assistance with the specification of this fire - [aa@escea.com](mailto:aa@escea.com)

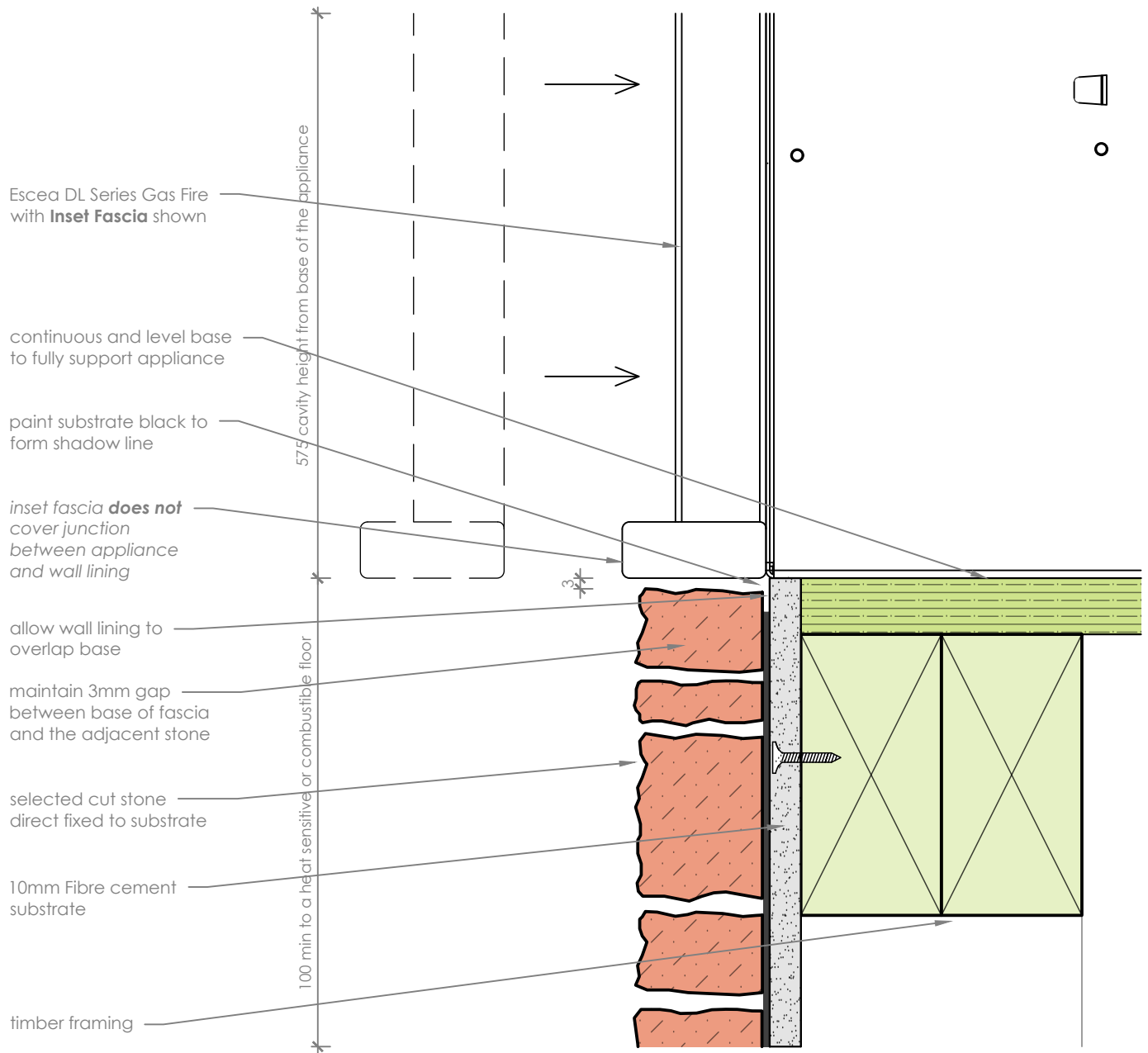

**Base Detail**

scale 1:2

**Notes:**

- DO NOT SCALE OFF THESE DRAWINGS. All dimensions are in mm.
- This detail is to assist in the installation of a **stacked stone finish** to the DL850 or DL1100 Gas Fireplace.
- Consider noise attenuation within timber framed cavities. It is advisable to restrain fire and flue to avoid movement.
- Finish detail also applicable to the side of the appliance.
- Powdercoated fascia's can be easily damaged - handle with care.
- This technical sheet must be read in conjunction with the Escea DL Series Installation Manual, the latest version can be found on our website at [www.escea.com](http://www.escea.com).

GENERAL CONSTRUCTION AND FINISHES SHOWN INDICATIVE ONLY

Contact the ESCEA Architectural Advisory Team for assistance with the specification of this fire - [aa@escea.com](mailto:aa@escea.com)