

Prolonged unprotected exposure to heat may be detrimental to the appearance or long term performance of the cladding. The DS Series Extended Trim Kit is to protect the exposed edges from the direct heat from the fire.

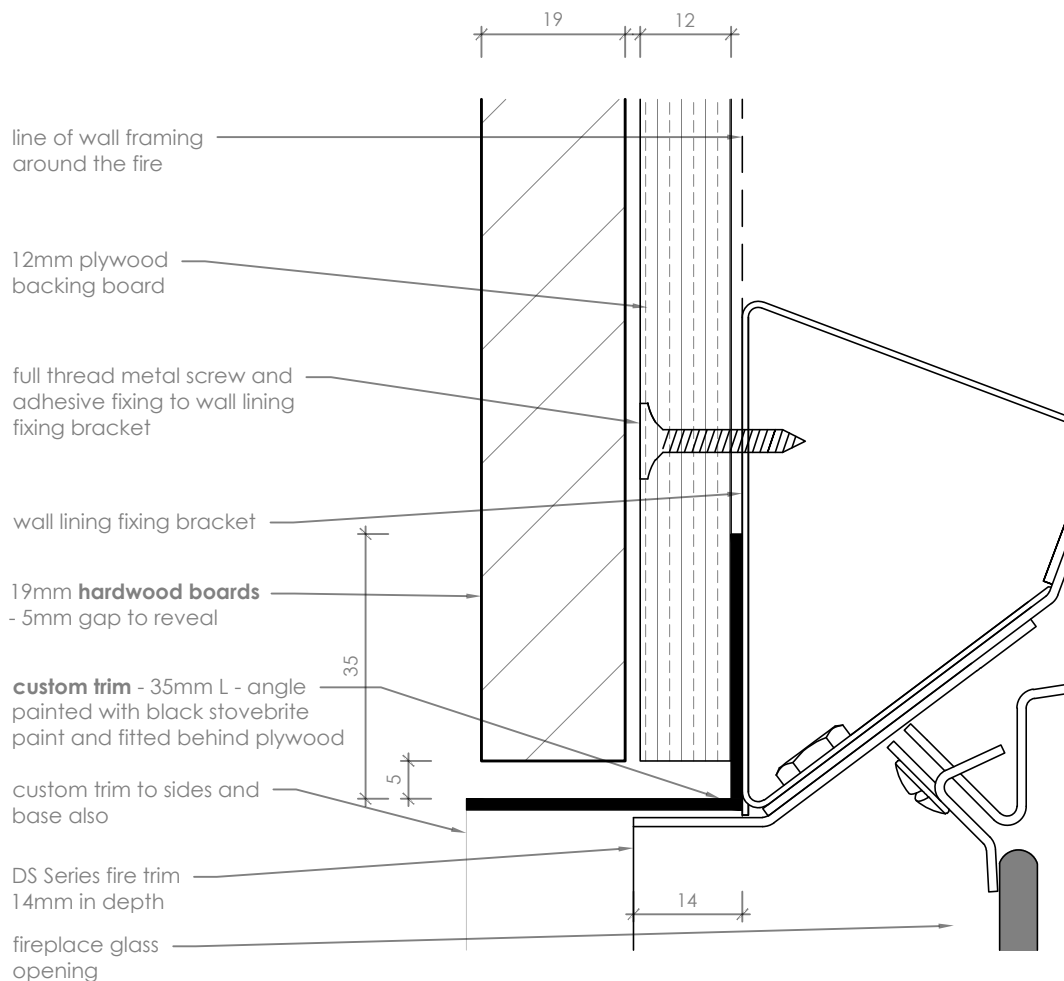

## Custom L-Angle

scale 1:1

This detail is applicable for:

**DS1150**  
**DS1400**  
**DS1650**  
**DS1900**

### Notes:

- DO NOT SCALE OFF THESE DRAWINGS
- All dimensions are in mm.
- This detail is to assist in the installation of a **frameless finish** to the DS Series Gas Fire.
- Escea recommends when using these finishing methods that a backing board is used.
- Black fireplace reveals must be able to be removed - ensure any adhesive or compound is kept clear.
- This detail is a solution for covering the exposed edges of wall linings that may be affected by the convected heat from the fire. The L angle is not supplied by Escea.
- The L angle dimension will need to increase/decrease to ensure that all combustible materials are covered.
- Maximum wall lining thickness combined is 35mm.
- This technical sheet must be read in conjunction with the Escea DS Series Installation Manual, the latest version can be found on our website at [www.escea.com](http://www.escea.com).

GENERAL CONSTRUCTION AND FINISHES SHOWN INDICATIVE ONLY

Contact the ESCEA Architectural Advisory Team for assistance with the specification of this fire - [aa@escea.com](mailto:aa@escea.com)