

Prolonged unprotected exposure to heat may be detrimental to the appearance or long term performance of the cladding. The DS Series Extended Trim Kit is to protect the exposed edges from the direct heat from the fire.

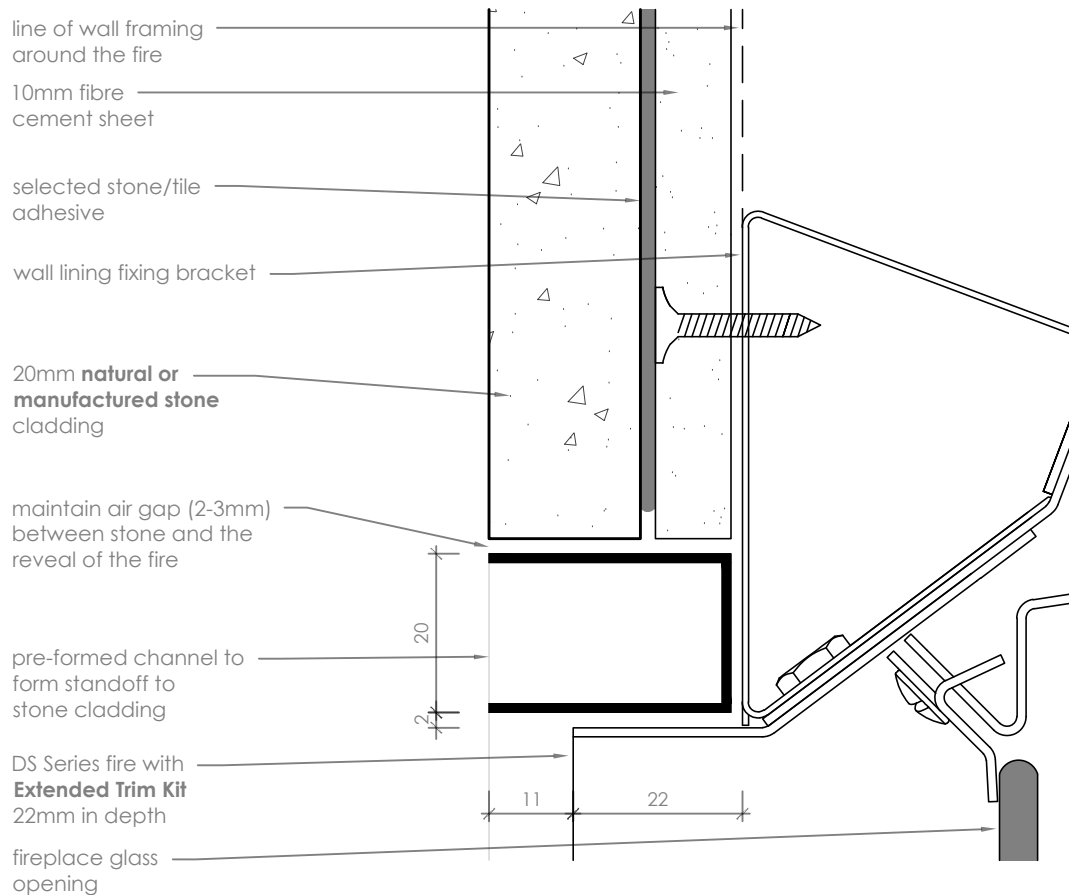

**Negative Detail**

scale 1:1

Applicable for:

- DS1150
- DS1400
- DS1650
- DS1900

**Notes:**

- DO NOT SCALE OFF THESE DRAWINGS
- All dimensions are in mm.
- This detail sheet is to assist in the installation of a **frameless finish** to the DS Series Gas Fire. They offer pathways for protection of heat sensitive linings and finishes.
- Black fireplace reveals must be able to be removed - ensure adhesive or compound is kept clear.
- Any custom trim or L-angle must be on all four sides to the glass opening of the fire.
- This technical sheet must be read in conjunction with the Escea DS Series Installation Manual, the latest version can be found on our website at [www.escea.com](http://www.escea.com).

GENERAL CONSTRUCTION AND FINISHES SHOWN INDICATIVE ONLY

Contact the ESCEA Architectural Advisory Team for assistance with the specification of this fire - [aa@escea.com](mailto:aa@escea.com)

Prolonged unprotected exposure to heat may be detrimental to the appearance or long term performance of the cladding. The DS Series Extended Trim Kit is to protect the exposed edges from the direct heat from the fire.

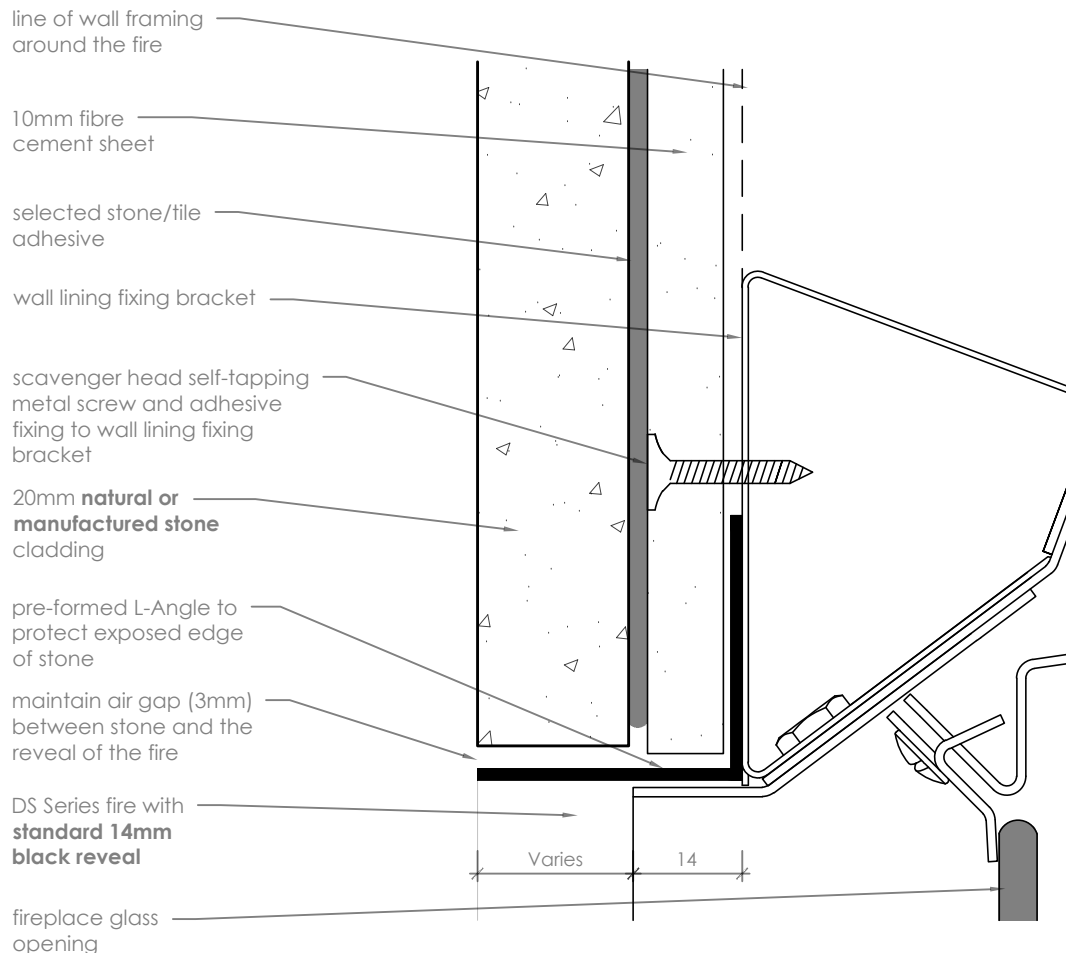

**Custom L-Angle**

scale 1:1

Applicable for:

- DS1150
- DS1400
- DS1650
- DS1900

**Notes:**

- DO NOT SCALE OFF THESE DRAWINGS
- All dimensions are in mm.
- This detail sheet is to assist in the installation of a **frameless finish** to the DS Series Gas Fire. They offer pathways for protection of heat sensitive linings and finishes.
- Black fireplace reveals must be able to be removed - ensure adhesive or compound is kept clear.
- Any custom trim or L-angle must be on all four sides to the glass opening of the fire.
- This technical sheet must be read in conjunction with the Escea DS Series Installation Manual, the latest version can be found on our website at [www.escea.com](http://www.escea.com).

GENERAL CONSTRUCTION AND FINISHES SHOWN INDICATIVE ONLY

Contact the ESCEA Architectural Advisory Team for assistance with the specification of this fire - [aa@escea.com](mailto:aa@escea.com)