

Prolonged unprotected exposure to heat may be detrimental to the appearance or long term performance of the cladding. The DS Series Extended Trim Kit is to protect the exposed edges from the direct heat from the fire.

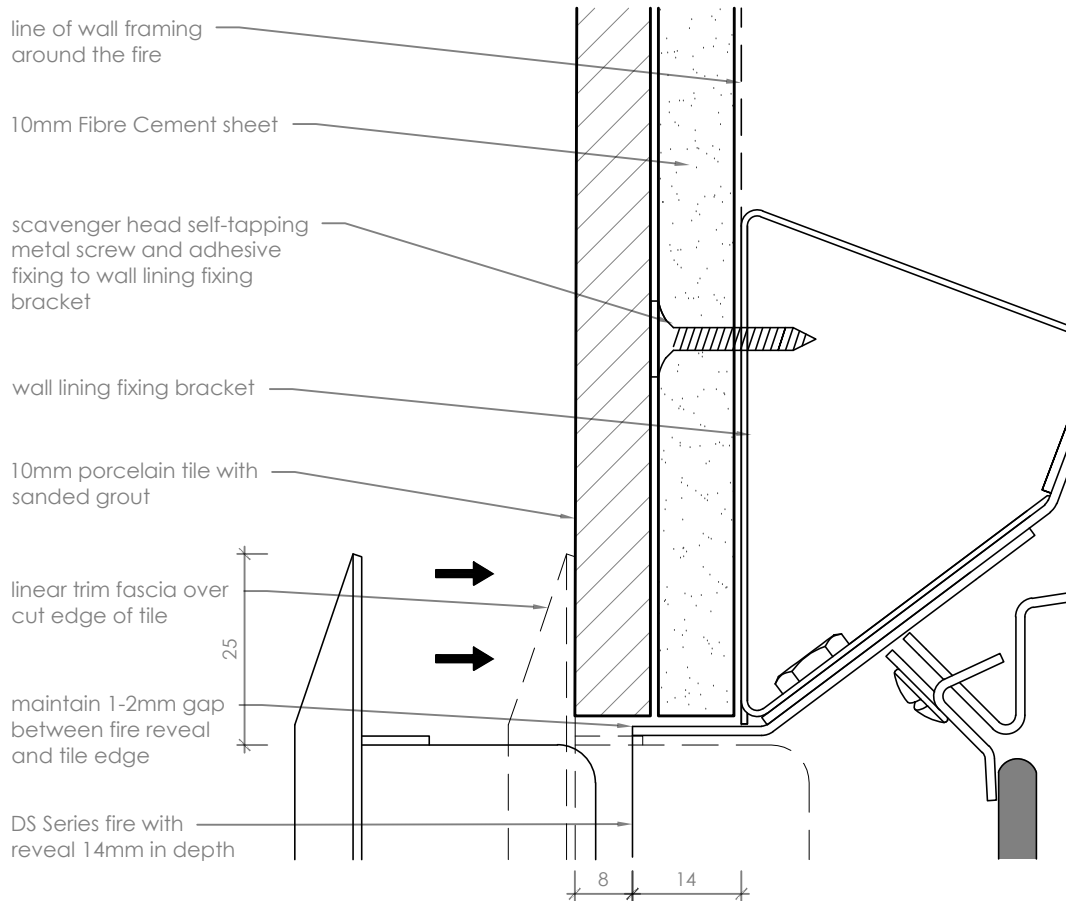

Tile with Linear Trim

scale 1:1

This detail is applicable for:

DS1150
DS1400
DS1650
DS1900

Notes:

- DO NOT SCALE OFF THESE DRAWINGS. All dimensions are in mm.
- This detail is to assist in the installation of a **Porcelain or Stone Tile Finish** using the **Linear Trim Fascia** to the DS Series Gas Fire.
- Black fireplace reveals must be able to be removed - ensure any adhesive or compound is kept clear.
- The Linear Trim is a friction fit to the inside of all four sides of the black reveals at the glass opening of the fire.
- This technical sheet must be read in conjunction with the Escea DS Series Installation Manual, the latest version can be found on our website at www.escea.com

GENERAL CONSTRUCTION AND FINISHES SHOWN INDICATIVE ONLY

Contact the **ESCEA Architectural Advisory Team** for assistance with the specification of this fire - aa@escea.com