

In a four sided concrete or masonry cavity, installation of the fireplace cannot be completed through the cavity opening. Please allow for installation of the fireplace either prior to, or after the concrete has been cast or laid.

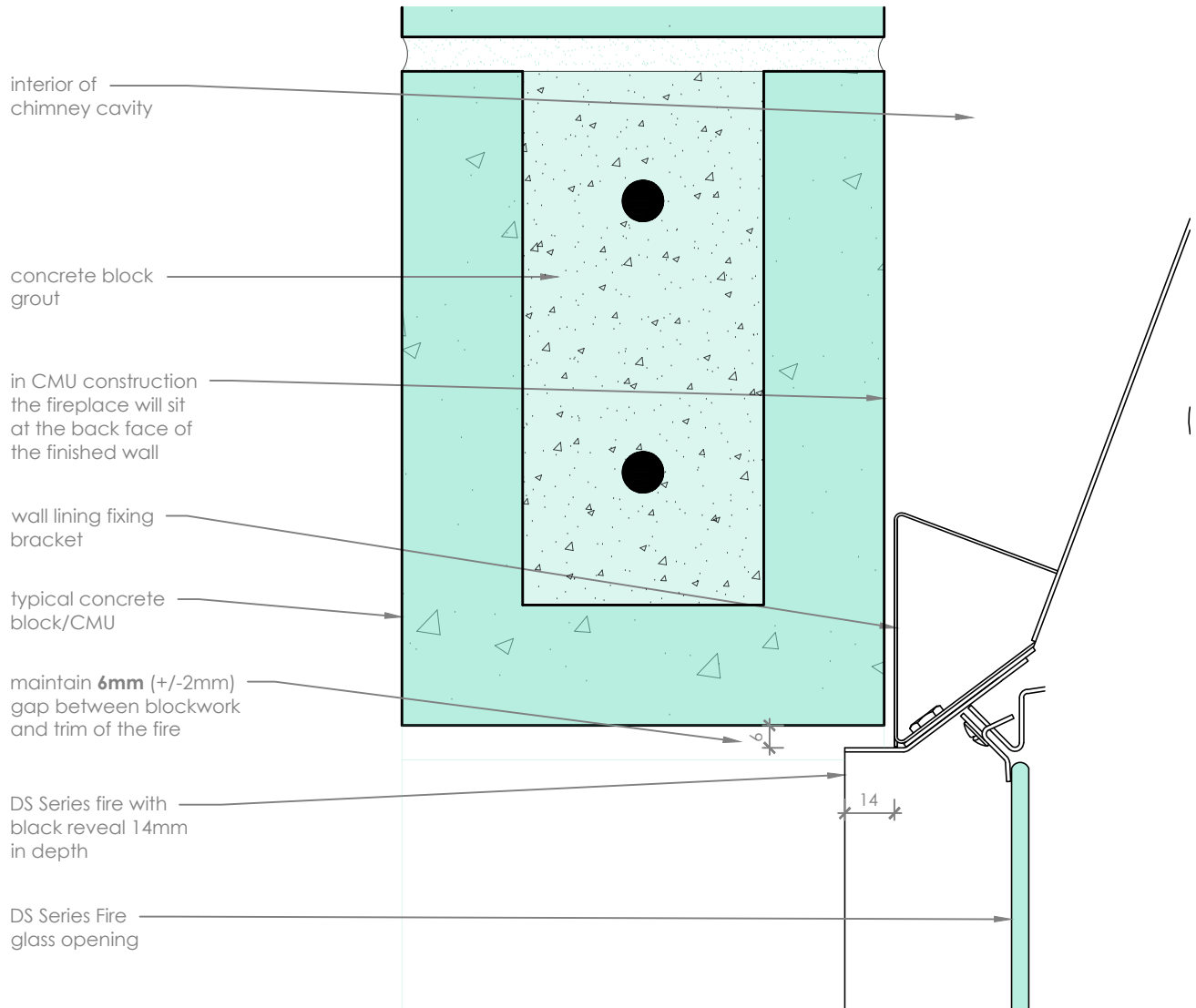

**Concrete Block Detail**

scale 1:2

**Notes:**

- All dimensions are in mm. DO NOT SCALE OFF THESE DRAWINGS
- This detail is to assist in the installation of a **frameless finish** to a DS or DN Series Gas Fireplace.
- This detail is suitable for all four sides of the fireplace glass viewing area.
- Use care when block laying to avoid damaging powdercoated black fireplace reveals.
- Black fireplace reveals must be able to be removed - ensure any adhesive or mortar is kept clear.
- A CMU lintel can be used instead of MS Lintel in accordance with design and building code requirements.
- Allow for construction tolerance when setting out the opening within the block/CMU wall.
- This technical sheet must be read in conjunction with the Escea DS Series Installation Manual, the latest version can be found on our website at [www.escea.com](http://www.escea.com).

GENERAL CONSTRUCTION AND FINISHES SHOWN INDICATIVE ONLY

Contact the **ESCEA Architectural Advisory Team** for assistance with the specification of this fire - [aa@escea.com](mailto:aa@escea.com)