

Prolonged unprotected exposure to heat may be detrimental to the appearance or long term performance of the cladding. The DS Series Extended Trim Kit is to protect the exposed edges from the direct heat from the fire.

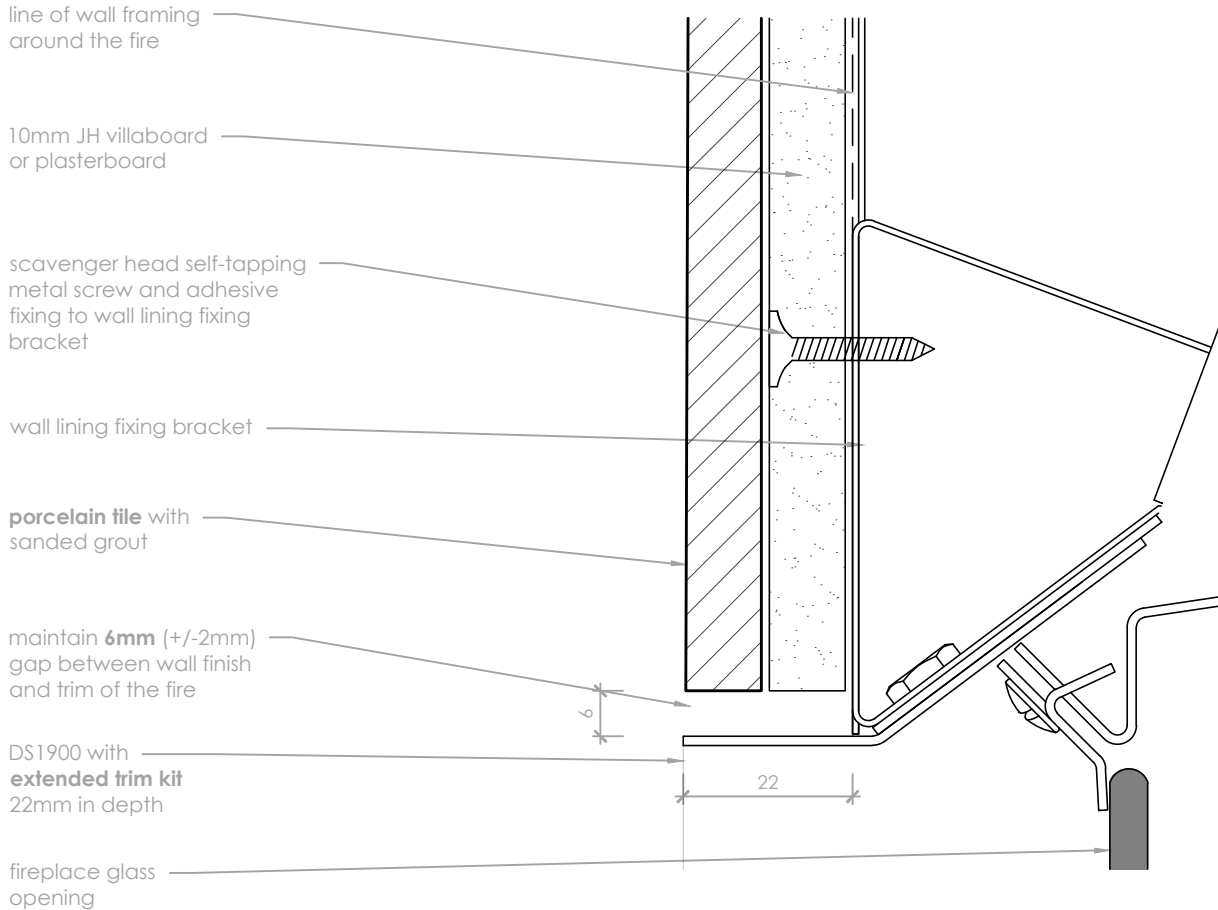

**Tile Detail**

scale 1:1

**Notes:**

- All dimensions are in mm. DO NOT SCALE OFF THESE DRAWINGS
- This detail is to assist in the installation of a **frameless tiled finish** to the DS1900 Gas Fireplace.
- This detail will use the extended cabinetry trim kit to protect overhanging cladding edges at the opening of the fire.
- Escea recommends when using these finishing methods that **10mm Fibre Cement Sheet** is used.
- Use care when grouting files to avoid scratching black fireplace reveals.
- Black fireplace reveals must be able to be removed - ensure any adhesive or compound is kept clear.
- This technical sheet must be read in conjunction with the Escea DS Series Installation Manual, the latest version can be found on our website at [www.escea.com](http://www.escea.com).

GENERAL CONSTRUCTION AND FINISHES SHOWN INDICATIVE ONLY

Contact the **ESCEA Architectural Advisory Team** for assistance with the specification of this fire - [aa@escea.com](mailto:aa@escea.com)