

Prolonged unprotected exposure to heat may be detrimental to the appearance or long term performance of a wall lining. Combustible and heat sensitive wall linings or finishes must not protrude past the trim, to the glass viewing area. Some scenarios will require the use of 22mm DS Extended Trim Kit, or a custom solution, to provide adequate protection.

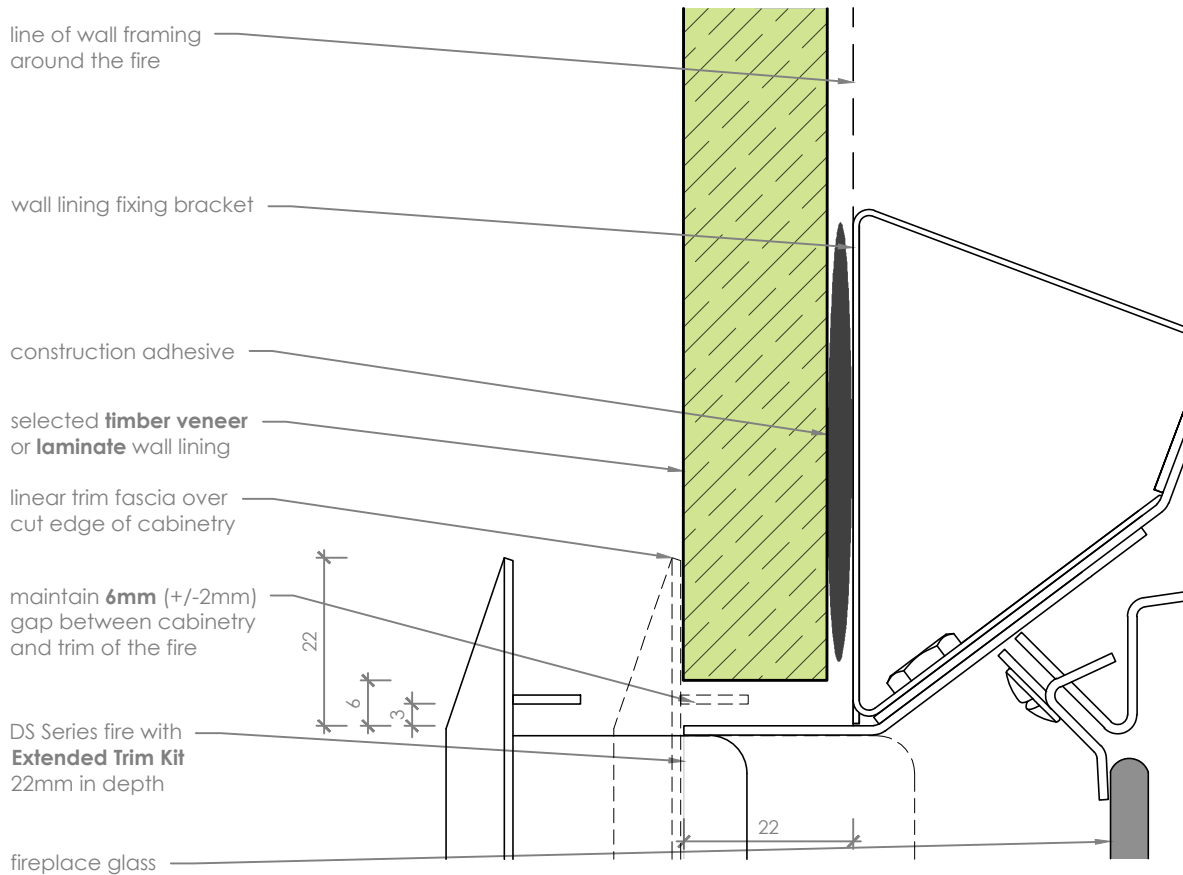

Cabinetry with Linear Trim scale 1:1

Notes:

- All dimensions are in mm. DO NOT SCALE OFF THESE DRAWINGS
- This detail is to assist in the installation of a **Cabinetry or Veneer Panel** to a DS1150, DS1400, DS1650 or DS1900 Gas Fireplace, where a finished edge is not possible.
- This detail is suitable for all four sides of the fireplace glass viewing area.
- Cabinetry panel can be directly bonded to the outer metalwork of the appliance.
- **Do not excessively push back lining when fixing it to the fire chassis** - use large daubs of adhesive to the appliance chassis, apply lining and flush finish with edge of the fire reveal.
- Black fireplace reveals must be able to be removed - ensure any adhesive or compound is kept clear.
- This technical sheet must be read in conjunction with the Escea DS Series Installation Manual, the latest version can be found on our website at www.escea.com.

GENERAL CONSTRUCTION AND FINISHES SHOWN INDICATIVE ONLY

Contact the ESCEA Architectural Advisory Team for assistance with the specification of this fire - aa@escea.com