

Prolonged unprotected exposure to heat may be detrimental to the appearance or long term performance of the cladding. The DS Series Extended Trim Kit is to protect the exposed edges from the direct heat from the fire.

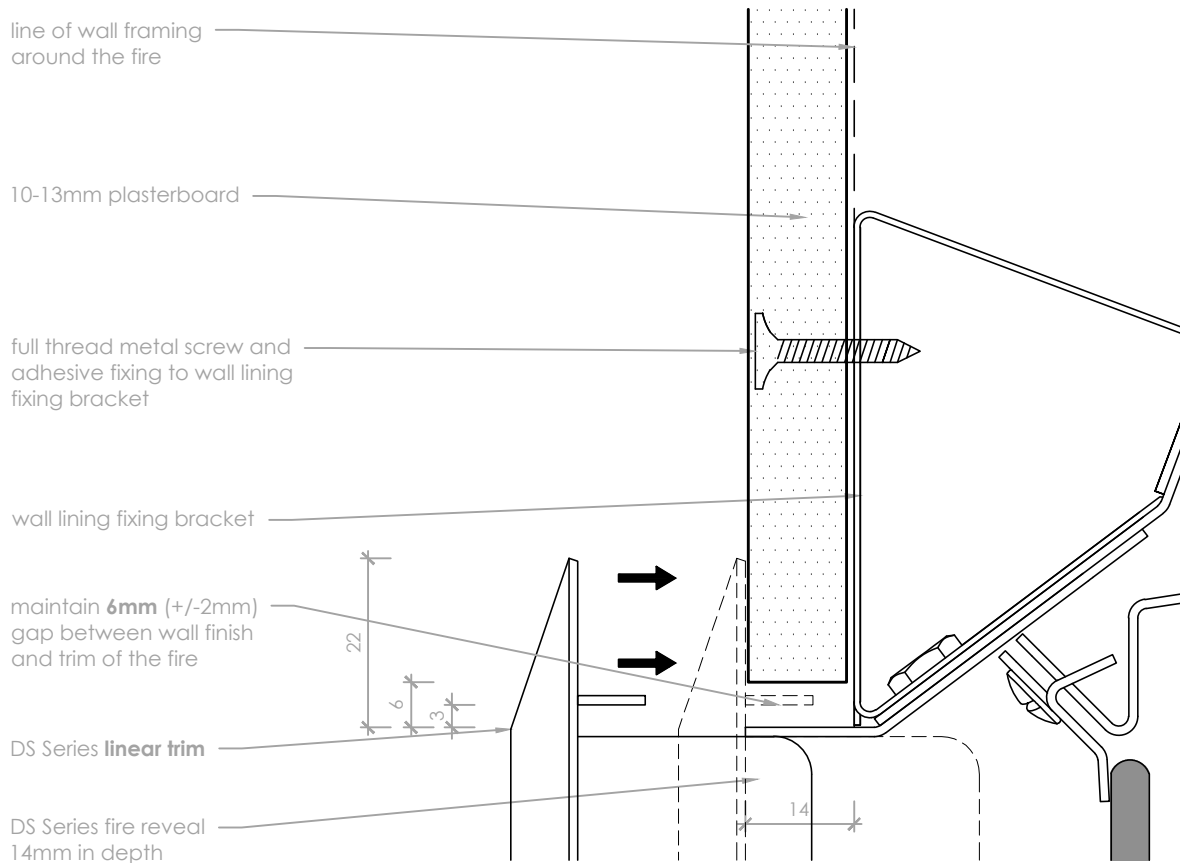

## Linear Trim

scale 1:1

### Notes:

- DO NOT SCALE OFF THESE DRAWINGS. All dimensions are in mm.
- This detail is to assist in the installation of a **plasterboard finish** using the **Linear Trim Fascia** to a DS1150, DS1400 or DS1650 Gas Fireplace.
- Black fireplace reveals must be able to be removed - ensure any adhesive or compound is kept clear.
- **Do not excessively push back wall board when fixing it to the fire chassis** - use large daubs of adhesive to the appliance chassis, apply wall lining and flush finish with edge of the fire reveal.
- The upper portion of the DS Linear Trim fits above the black reveal of the fireplace viewing area. Ensure the correct orientation and gaps are maintained.
- This technical sheet must be read in conjunction with the Escea DS Series Installation Manual, the latest version can be found on our website at [www.escea.com](http://www.escea.com)

GENERAL CONSTRUCTION AND FINISHES SHOWN INDICATIVE ONLY

Contact the **ESCEA Architectural Advisory Team** for assistance with the specification of this fire - [aa@escea.com](mailto:aa@escea.com)