

# EW5000 - Outdoor Wood Fireplace

## Install Guide for a Timber Framed Cavity

### SPECIFICATIONS

Where the EW5000 is to be installed with combustible materials adjacent, in contact with a building, or where the flue penetrates a combustible roof, this method is compulsory. With the inclusion of an AAC panel heat cell, the EW5000 Fireplace can be installed within a timber framed cavity. The AAC panel heat cell encapsulates the EW5000, insulating the fireplace from the timber framework and diverting the heat into the triple skin flue system.

With this install method the EW5000 Timber Cavity Flue Kit must be used.

Appliance Dimensions	996mm W x 758mm H x 548mm D
Opening Area Dimensions	884mm W x 479mm H
Fuel Type	Hardwood (AU), Softwood (NZ)
Fascia or Frameless	Frameless only
Fireplace Weight	127kg + Flue (40kg)
Compliance	Clearance tested to AS/NZS 2918
Accessories	Cooking Plate, Pizza Oven
Flue Type	Natural Draught
Flue Size	250mm/350mm /450mm/550mm
Flue Length (min. recommended)	3.6m - from the top of the appliance

### TIMBER CAVITY DIMENSIONS

Timber framework can be used to the rear and sides of the appliance but not to the front face of the cavity. The timber framework cannot be in contact with the AAC Panel Heat Cell.

Timber Cavity Dimensions:  
Venting: **1270mm W x 1550mm H x 770mm D (ID)**  
Total combined intake vent area of **94600mm<sup>2</sup>**  
Vents must be a maximum of 300mm from the base of the appliance.  
Venting out is through the 450mm Ø Flue Liner

### AAC HEAT CELL DIMENSIONS

The AAC Panel Heat Cell is a self supporting structure to insulate the fireplace from the timber framed cavity. A flue Dropbox is located at the top of the AAC heat cell and is the transition to the triple skin flue system. The Dropbox allows for venting of the AAC heat cell and the adjacent timber framed cavity.

AAC Heat Cell Dimensions:  
AAC Panels: **1200mm W x 950mm H x 735mm D (OD)**  
minimum 75mm thick, R Value = 0.59m<sup>2</sup> K/W  
Total combined intake vent area of **24200mm<sup>2</sup>**  
Venting out is through the 350mm Ø Flue Liner

### HEARTH REQUIREMENTS

The EW5000 fireplace requires a fully non-combustible floor or an insulating, heat resistant hearth complying with AS/NZS 2918. Minimum dimensions of an insulating hearth to be: **1884mm W x 1000mm D.**

### INSTALLATION

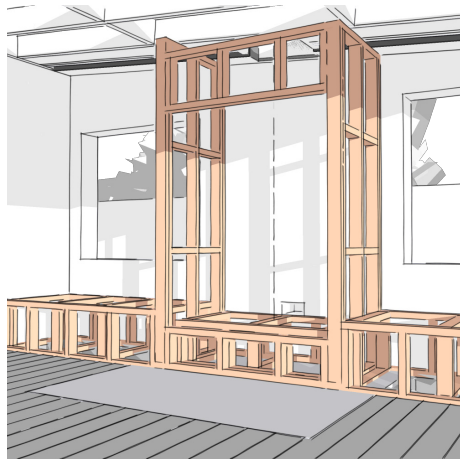

A location is selected meeting all requirements for flue clearances and the adjacent building. Obtain flue centreline to ensure the flue run is clear from obstructions. Build the framework to the required dimensions and provide the ventilation inlet hole to the exterior.

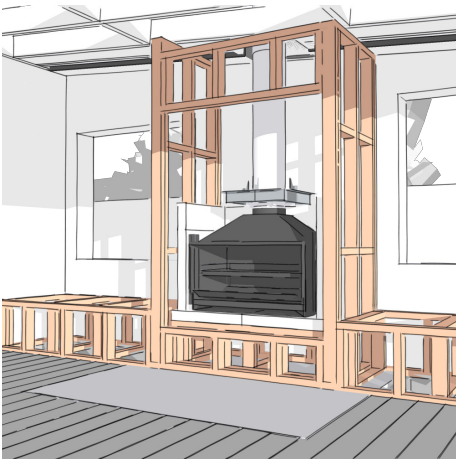

Install the rear, side and base AAC panels according to the manufacturers instructions. Fix the fireplace into the AAC heat cell alongside the 250mm Ø flue. Restrain the fire to its base. The Dropbox support bracket and flue Dropbox can be temporarily located.

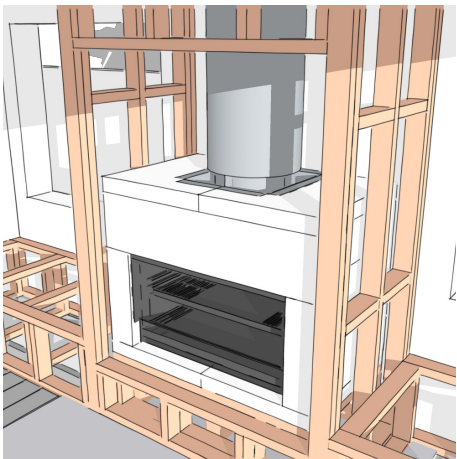

Finish the AAC Panel installation to close off the Heat cell. Complete the flue installation by installing the remaining 350mm and 450mm Ø flue liners to the correct configuration and height. Flue dropbox can be sealed in place.

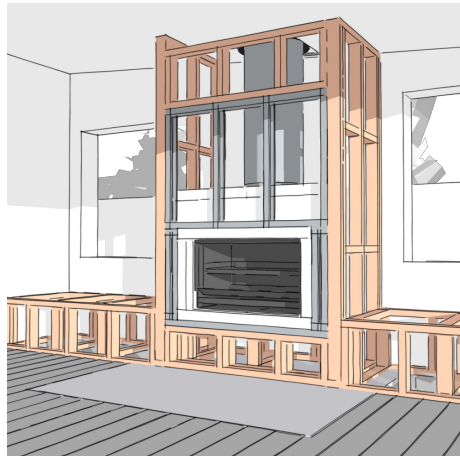

In this scenario an additional lightweight steel frame is used on the front face to support the wall linings and finishes.



Fix the non-combustible substrate to the framework. Detail the opening to cover the wall linings and protect from direct heat exposure.

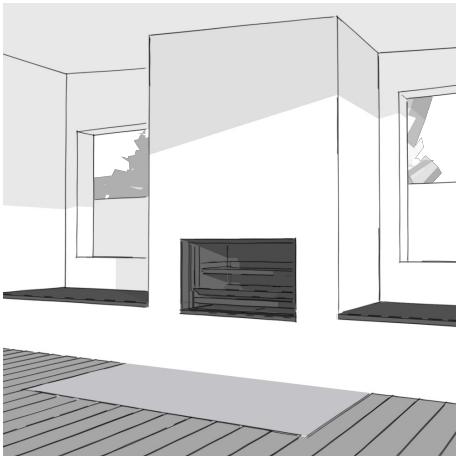

Complete the installation by installing the remaining fireplace components, apply any finishes to the walls, and install the floor protector or hearth.