

## Cavity Plan

scale 1:20

### Notes:

- All dimensions are in mm. DO NOT SCALE OFF THESE DRAWINGS.
- This detail sheet is to assist in the installation of an **Escea TC950 Indoor Wood Fire** into a timber framed cavity.
- Protect the appliance from damage during installation.
- The finishing material to the front of the cavity must be a non-combustible and heat resistant material, to resist deformation or degradation. Escea takes no responsibility for material selection.
- The Specifier and/or Installer are responsible for compliance with all relevant Building Codes.
- This technical sheet must be read in conjunction with the Escea TC950 Installation Manual, the latest version can be found on our website at [www.escea.com](http://www.escea.com)

GENERAL CONSTRUCTION AND FINISHES SHOWN INDICATIVE ONLY

Contact the **ESCEA Architectural Advisory Team** for assistance with the specification of this fire - [aa@escea.com](mailto:aa@escea.com)

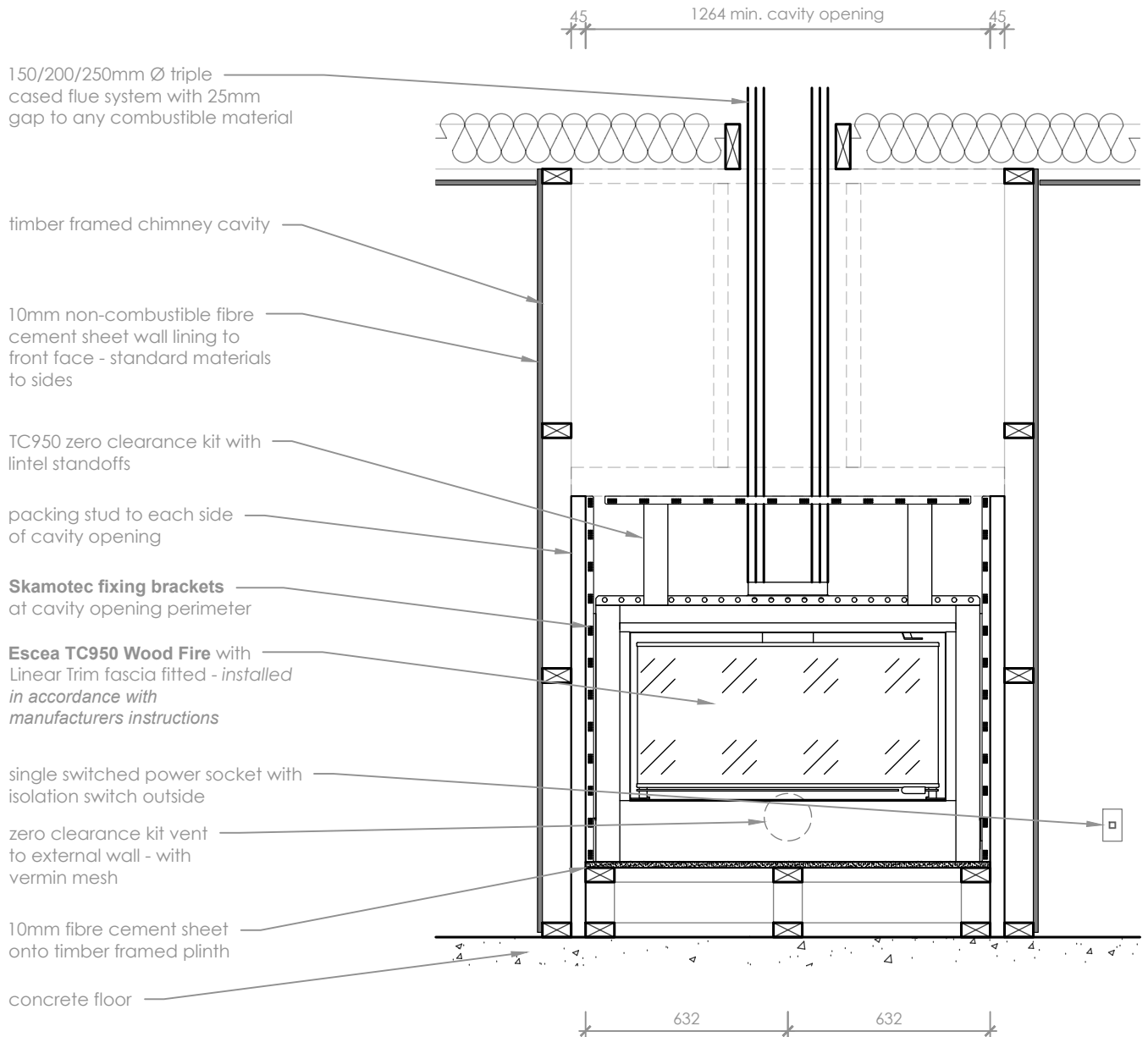

**Cavity Section (Front)**

scale 1:20

**Notes:**

- All dimensions are in mm. DO NOT SCALE OFF THESE DRAWINGS.
- This detail sheet is to assist in the installation of an **Escea TC950 Indoor Wood Fire** into a timber framed cavity.
- Protect the appliance from damage during installation.
- The finishing material to the front of the cavity must be a non-combustible and heat resistant material, to resist deformation or degradation. Escea takes no responsibility for material selection.
- The Specifier and/or Installer are responsible for compliance with all relevant Building Codes.
- This technical sheet must be read in conjunction with the Escea TC950 Installation Manual, the latest version can be found on our website at [www.escea.com](http://www.escea.com)

GENERAL CONSTRUCTION AND FINISHES SHOWN INDICATIVE ONLY

Contact the **ESCEA Architectural Advisory Team** for assistance with the specification of this fire - [aa@escea.com](mailto:aa@escea.com)

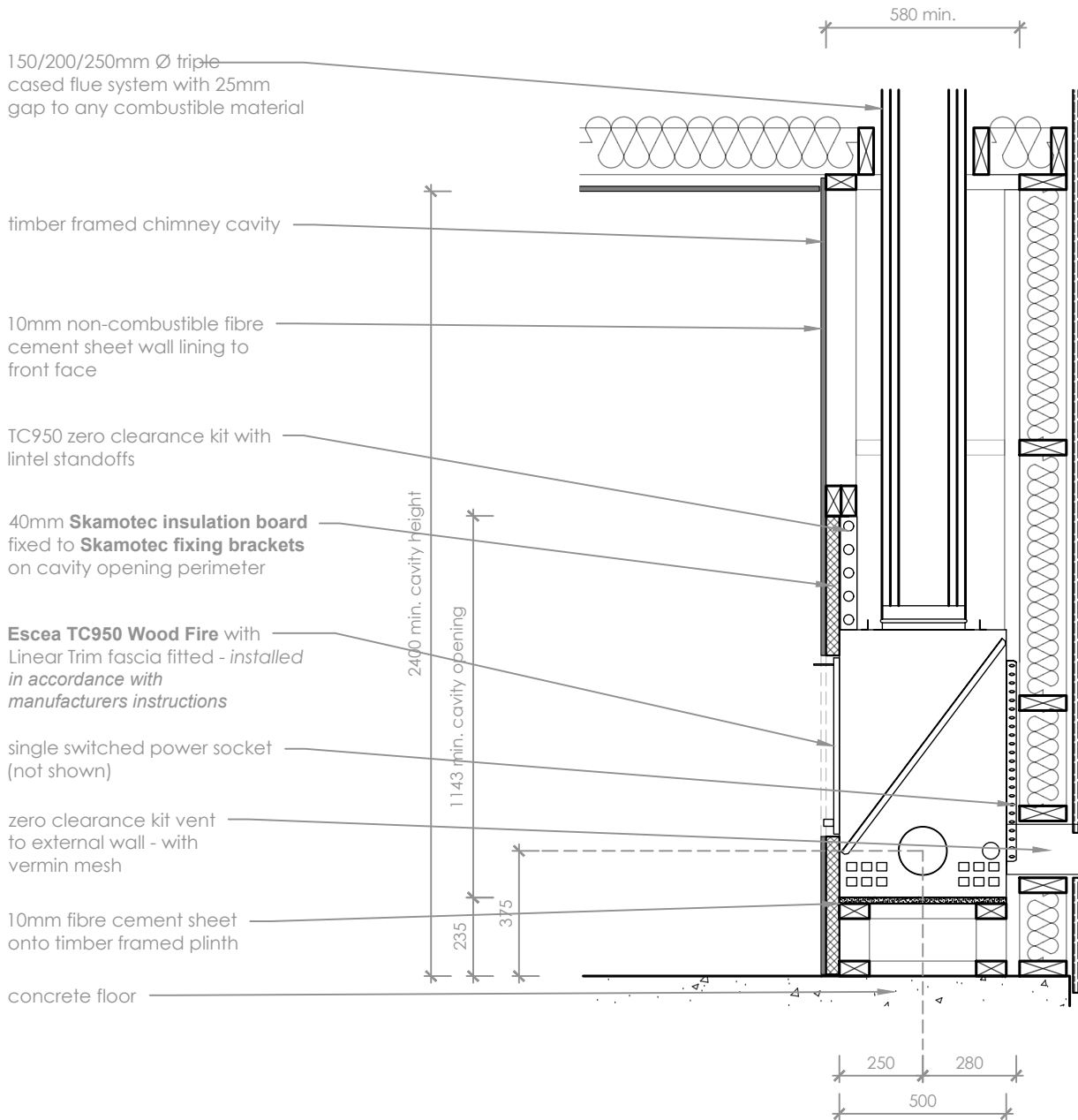

**Cavity Section (Side)**

scale 1:20

**Notes:**

- All dimensions are in mm. DO NOT SCALE OFF THESE DRAWINGS.
- This detail sheet is to assist in the installation of an **Escea TC950 Indoor Wood Fire** into a timber framed cavity.
- Protect the appliance from damage during installation.
- The finishing material to the front of the cavity must be a non-combustible and heat resistant material, to resist deformation or degradation. Escea takes no responsibility for material selection.
- The Specifier and/or Installer are responsible for compliance with all relevant Building Codes.
- This technical sheet must be read in conjunction with the Escea TC950 Installation Manual, the latest version can be found on our website at [www.escea.com](http://www.escea.com)

GENERAL CONSTRUCTION AND FINISHES SHOWN INDICATIVE ONLY

Contact the **ESCEA Architectural Advisory Team** for assistance with the specification of this fire - [aa@escea.com](mailto:aa@escea.com)