

Cavity Plan

scale 1:20

Notes:

- All dimensions are in mm. DO NOT SCALE OFF THESE DRAWINGS.
- This detail sheet is to assist in the installation of an **Escea TC950 Indoor Wood Fire** into a timber framed cavity.
- Protect the appliance from damage during installation.
- The finishing material to the front of the cavity must be a non-combustible and heat resistant material, to resist deformation or degradation. Escea takes no responsibility for material selection.
- The Specifier and/or Installer are responsible for compliance with all relevant Building Codes.
- This technical sheet must be read in conjunction with the Escea TC950 Installation Manual, the latest version can be found on our website at www.escea.com

GENERAL CONSTRUCTION AND FINISHES SHOWN INDICATIVE ONLY

Contact the **ESCEA Architectural Advisory Team** for assistance with the specification of this fire - aa@escea.com

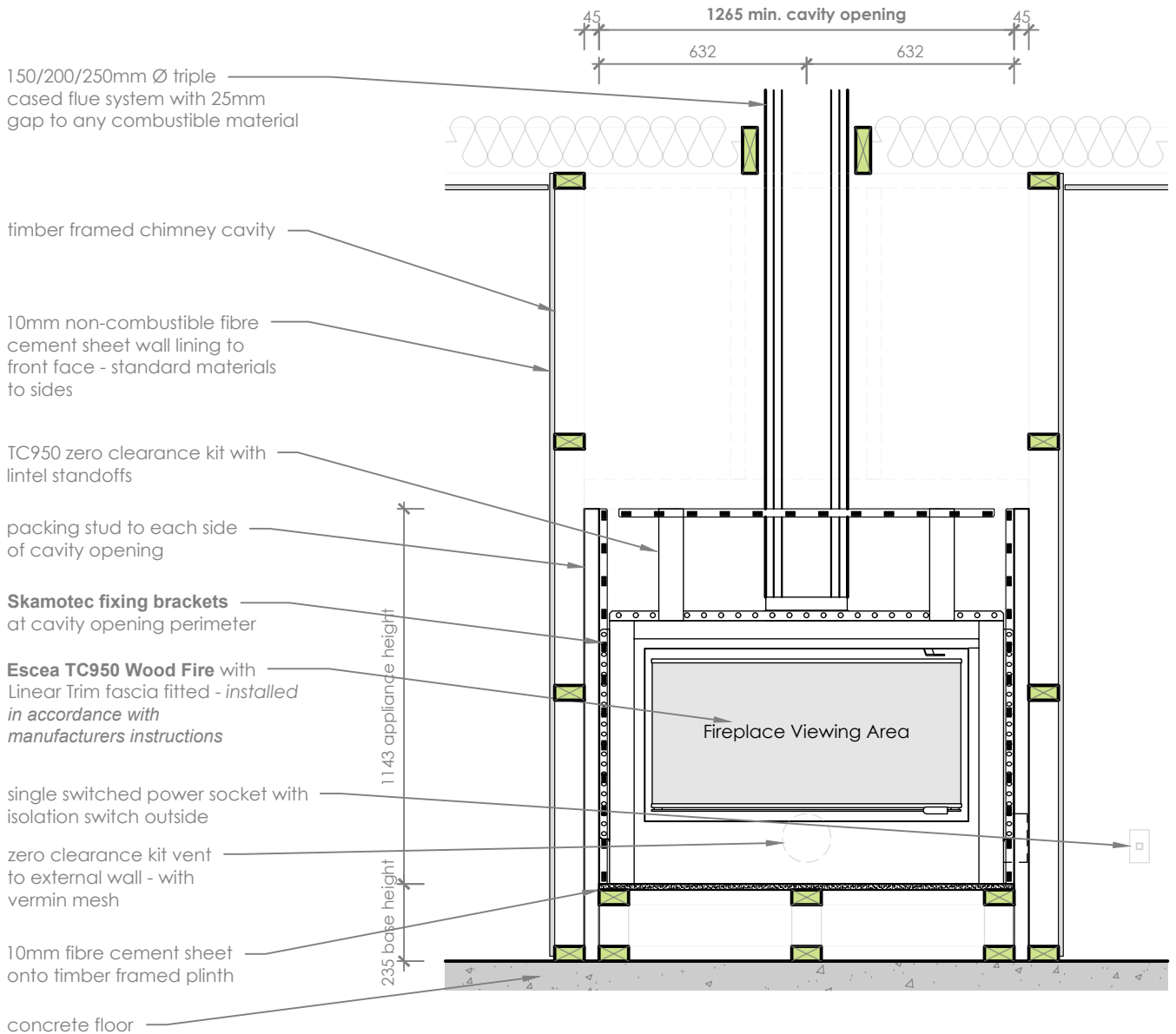

Cavity Section (Front)

scale 1:20

Notes:

- All dimensions are in mm. DO NOT SCALE OFF THESE DRAWINGS.
- This detail sheet is to assist in the installation of an **Escea TC950 Indoor Wood Fire** into a timber framed cavity.
- Protect the appliance from damage during installation.
- The finishing material to the front of the cavity must be a non-combustible and heat resistant material, to resist deformation or degradation. Escea takes no responsibility for material selection.
- The Specifier and/or Installer are responsible for compliance with all relevant Building Codes.
- This technical sheet must be read in conjunction with the Escea TC950 Installation Manual, the latest version can be found on our website at www.escea.com

GENERAL CONSTRUCTION AND FINISHES SHOWN INDICATIVE ONLY

Contact the **ESCEA Architectural Advisory Team** for assistance with the specification of this fire - aa@escea.com

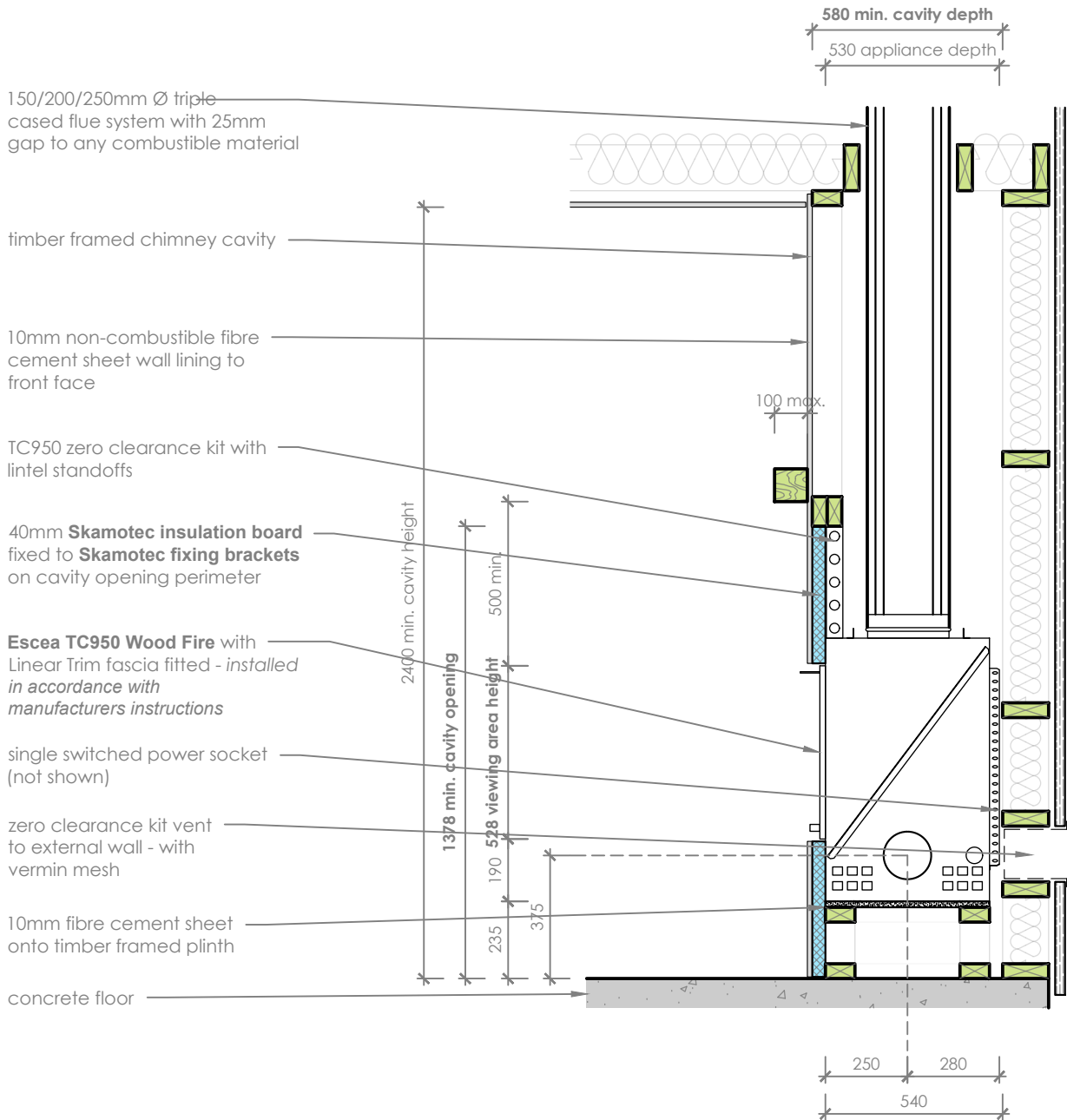

Cavity Section (Side)

scale 1:20

Notes:

- All dimensions are in mm. DO NOT SCALE OFF THESE DRAWINGS.
- This detail sheet is to assist in the installation of an **Escea TC950 Indoor Wood Fire** into a timber framed cavity.
- Protect the appliance from damage during installation.
- The finishing material to the front of the cavity must be a non-combustible and heat resistant material, to resist deformation or degradation. Escea takes no responsibility for material selection.
- The Specifier and/or Installer are responsible for compliance with all relevant Building Codes.
- This technical sheet must be read in conjunction with the Escea TC950 Installation Manual, the latest version can be found on our website at www.escea.com

GENERAL CONSTRUCTION AND FINISHES SHOWN INDICATIVE ONLY

Contact the **ESCEA Architectural Advisory Team** for assistance with the specification of this fire - aa@escea.com