

Plan

scale 1:20

Notes:

- All dimensions are in mm. DO NOT SCALE OFF THESE DRAWINGS.
- This detail is to assist in the installation of a EW5000 Outdoor Fireplace into a timber framed cavity. In this scenario, the fireplace is to be installed frameless.
- The cavity for the EW5000 may be a combustible material, but the fireplace enclosure **MUST NOT** form part of the external wall of the building.
- Some parts of this fire and the cavity into which it is installed, may get hot during operation. Ensure any materials used are heat resistant and non-combustible to resist deformation or degradation. Escea takes no responsibility for material selection.
- Restrain the fire from movement by fixing to the supporting base through the provided holes in the base of the fireplace.
- For flue detailing above the roof line, refer to the requisite Timber Cavity Flue Detail, which can be found at www.escea.com
- This technical sheet must be read in conjunction with the EW5000 Installation Manual, the latest version can be found on our website at www.escea.com

GENERAL CONSTRUCTION AND FINISHES SHOWN INDICATIVE ONLY

Contact the ESCEA Architectural Advisory Team for assistance with the specification of this fire - aa@escea.com

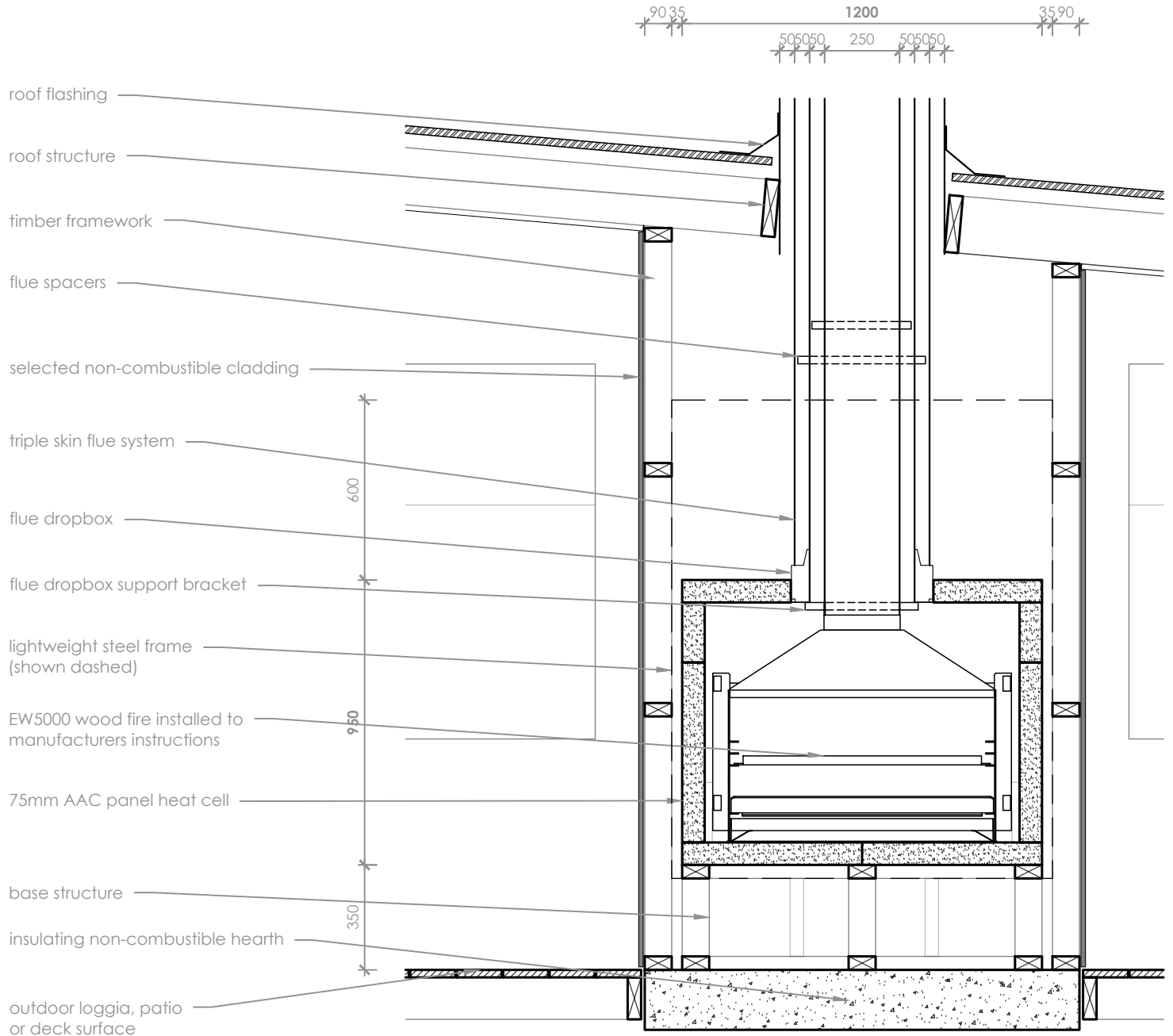

Front

scale 1:20

Notes:

- All dimensions are in mm. DO NOT SCALE OFF THESE DRAWINGS.
- This detail is to assist in the installation of a EW5000 Outdoor Fireplace into a timber framed cavity. In this scenario, the fireplace is to be installed frameless.
- The cavity for the EW5000 may be a combustible material, but the fireplace enclosure **MUST NOT** form part of the external wall of the building.
- Some parts of this fire and the cavity into which it is installed, may get hot during operation. Ensure any materials used are heat resistant and non-combustible to resist deformation or degradation. Escea takes no responsibility for material selection.
- Restrain the fire from movement by fixing to the supporting base through the provided holes in the base of the fireplace.
- For flue detailing above the roof line, refer to the requisite Timber Cavity Flue Detail, which can be found at www.escea.com
- This technical sheet must be read in conjunction with the EW5000 Installation Manual, the latest version can be found on our website at www.escea.com

GENERAL CONSTRUCTION AND FINISHES SHOWN INDICATIVE ONLY

Contact the ESCEA Architectural Advisory Team for assistance with the specification of this fire - aa@escea.com

EW5000 (Frameless) Timber Cavity Technical Detail

FIRE BY **escea**.

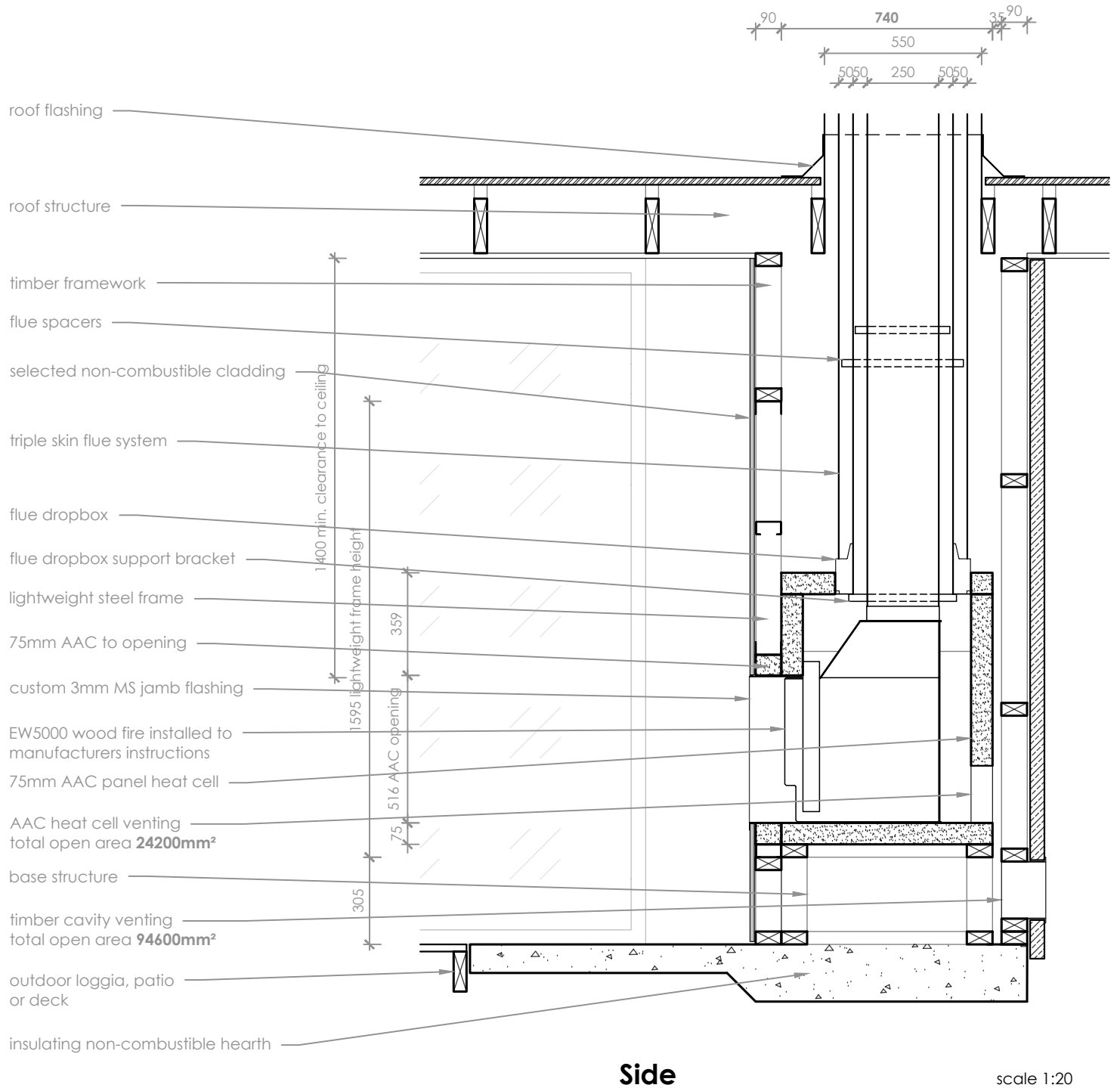

Notes:

- All dimensions are in mm. DO NOT SCALE OFF THESE DRAWINGS.
- This detail is to assist in the installation of a EW5000 Outdoor Fireplace into a timber framed cavity. In this scenario, the fireplace is to be installed frameless.
- The cavity for the EW5000 may be a combustible material, but the fireplace enclosure **MUST NOT** form part of the external wall of the building.
- Some parts of this fire and the cavity into which it is installed, may get hot during operation. Ensure any materials used are heat resistant and non-combustible to resist deformation or degradation. Escea takes no responsibility for material selection.
- Restrain the fire from movement by fixing to the supporting base through the provided holes in the base of the fireplace.
- For flue detailing above the roof line, refer to the requisite Timber Cavity Flue Detail, which can be found at www.escea.com
- This technical sheet must be read in conjunction with the EW5000 Installation Manual, the latest version can be found on our website at www.escea.com

GENERAL CONSTRUCTION AND FINISHES SHOWN INDICATIVE ONLY

Contact the ESCEA Architectural Advisory Team for assistance with the specification of this fire - aa@escea.com