

External Vertical Powerflue - Chimney Cap Detail

The installation of an Escea D-Series External Vertical Powerflue Kit (EVP) or Masonry Flue Kit can be made with a **custom-made chimney cap** designed to match the selected roof finish and maintain a neat, weathertight finish.

For this type of install the rigid liner or flashing supplied with the flue kit, would be discarded.

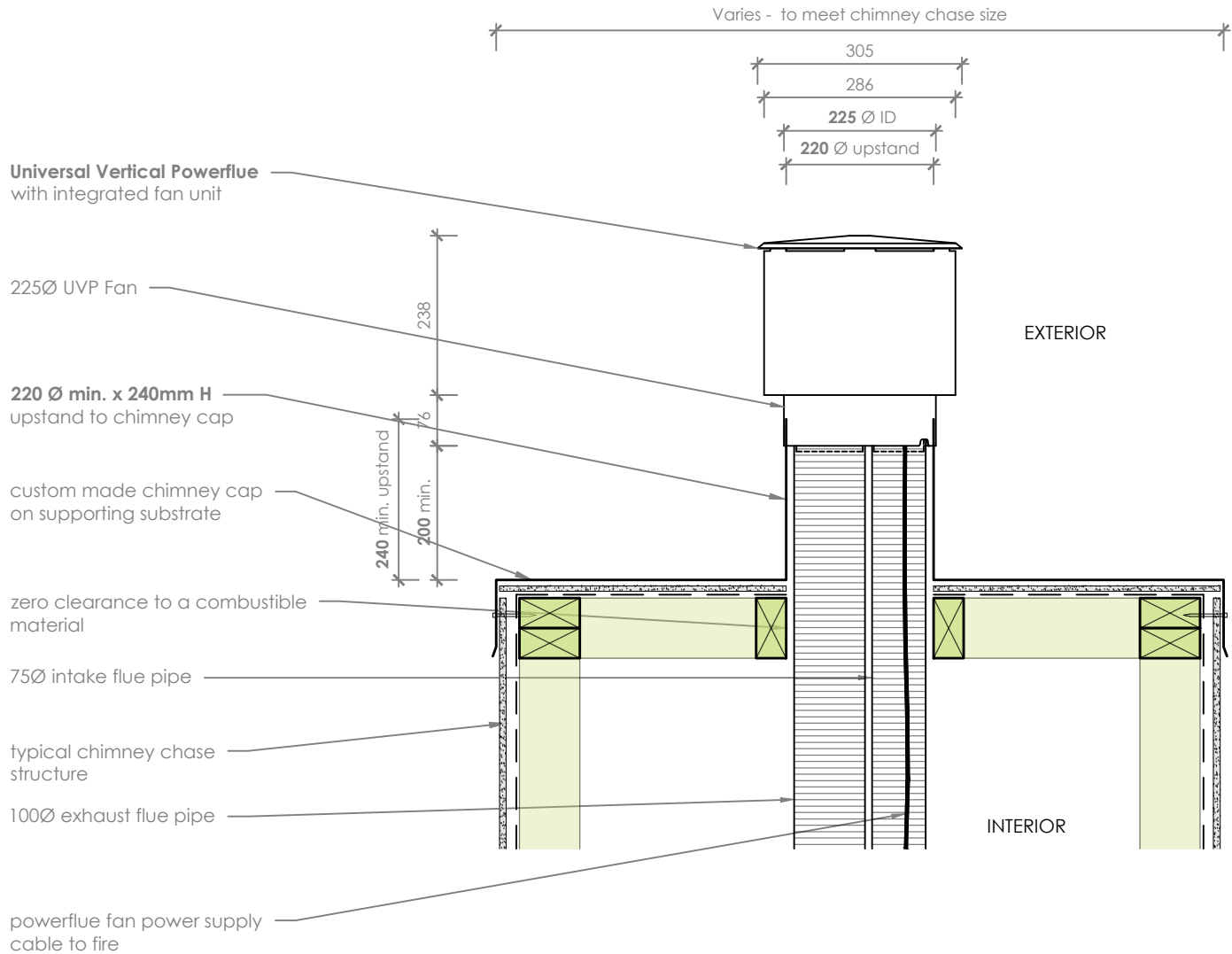

Flue Detail

scale 1:10

note:

- DO NOT SCALE OFF THESE DRAWINGS. All dimensions are in mm.
- The **External Vertical Powerflue** should be used in situations where roof access for servicing the Powerflue Fan is more suitable.
- It is advisable to secure the flexible flue to prevent movement, vibration and sagging - this will also assist in maintaining the required 50mm standoff where required.
- Construction requirements including venting, weathertightness and insulation shown for illustrative purposes only. Confirm specific regulatory requirements.
- Chimney cap should be supported to prevent sagging under the weight of the flue Terminal.
- This technical sheet must be read in conjunction with the relevant Escea Gas Fireplace Installation Manual, the latest version can be found on our website at www.escea.com.

GENERAL CONSTRUCTION AND FINISHES SHOWN INDICATIVE ONLY

Contact the ESCEA Architectural Advisory Team for assistance with the specification of this fire - aa@escea.com