

Head/Sill Detail

scale 1:5

note:

- DO NOT SCALE OFF THESE DRAWINGS. All dimensions are in mm.
- It is advisable to secure the flexible flue to prevent movement, vibration and sagging - this will also assist in maintaining the required 50mm standoff where required.
- Ensure flashing's, wall claddings or any other building component does not obstruct the horizontal powerflue terminal.
- Construction requirements including venting, moisture control and insulation shown for illustrative purposes only. Confirm specific regulatory requirements.
- The flue terminal will get very hot when in use. Precautions should be taken to protect people and animals from injury.
- This technical sheet must be read in conjunction with the relevant Escea Gas Fireplace Installation Manual, the latest version can be found on our website at www.escea.com.

GENERAL CONSTRUCTION AND FINISHES SHOWN INDICATIVE ONLY

Contact the ESCEA Architectural Advisory Team for assistance with the specification of this fire - aa@escea.com

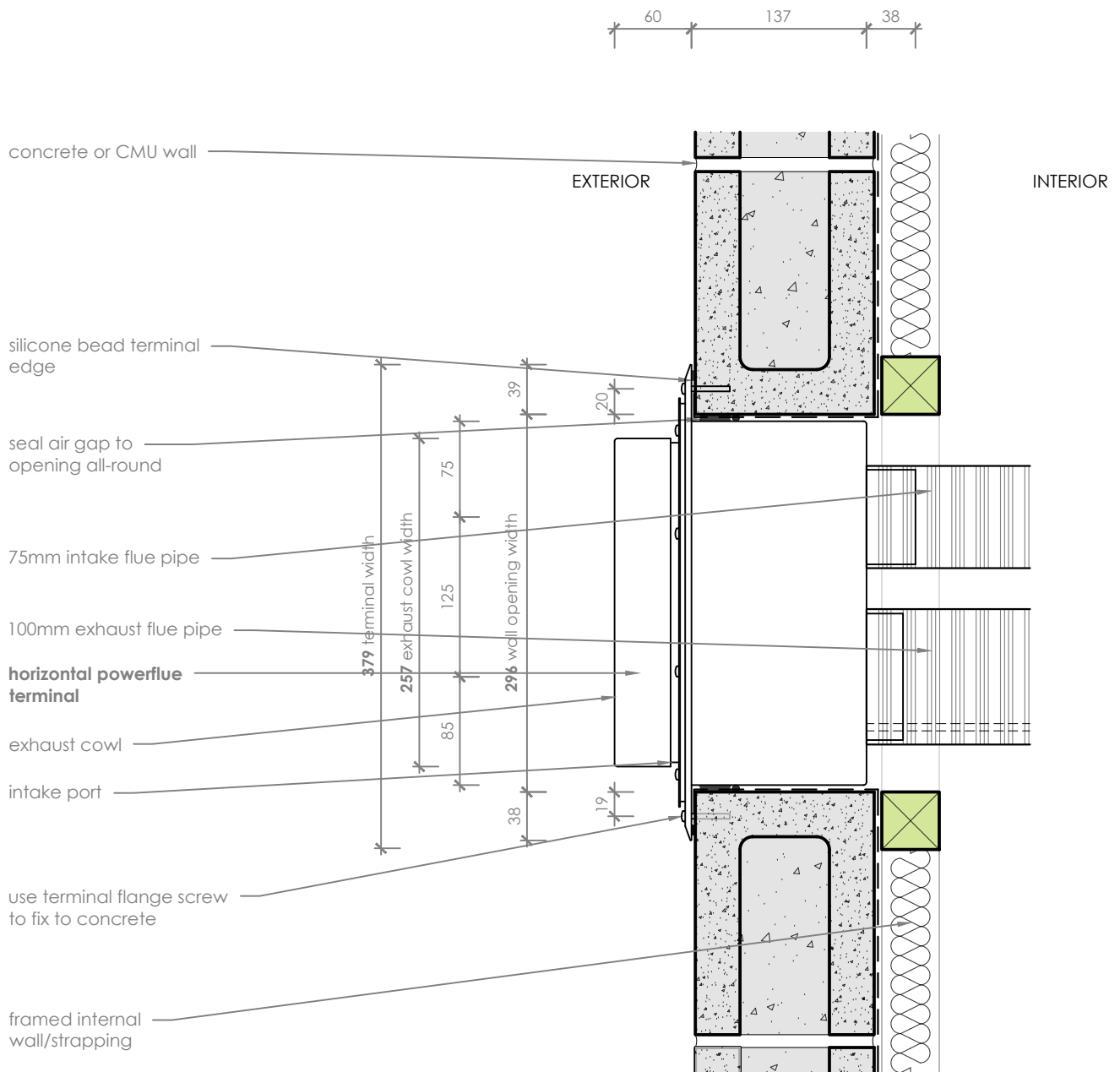

Jamb Detail

scale 1:5

note:

- DO NOT SCALE OFF THESE DRAWINGS. All dimensions are in mm.
- It is advisable to secure the flexible flue to prevent movement, vibration and sagging - this will also assist in maintaining the required 50mm standoff where required.
- Ensure flashing's, wall claddings or any other building component does not obstruct the horizontal powerflue terminal.
- Construction requirements including venting, moisture control and insulation shown for illustrative purposes only. Confirm specific regulatory requirements.
- The flue terminal will get very hot when in use. Precautions should be taken to protect people and animals from injury.
- This technical sheet must be read in conjunction with the relevant Escea Gas Fireplace Installation Manual, the latest version can be found on our website at www.escea.com.

GENERAL CONSTRUCTION AND FINISHES SHOWN INDICATIVE ONLY

Contact the ESCEA Architectural Advisory Team for assistance with the specification of this fire - aa@escea.com