

**Head/Sill Detail**

scale 1:5

**note:**

- DO NOT SCALE OFF THESE DRAWINGS. All dimensions are in mm.
- It is advisable to secure the flexible flue to prevent movement, vibration and sagging - this will also assist in maintaining the required 50mm standoff where required.
- Ensure flashings, wall claddings or any other building component does not obstruct the horizontal powerflue terminal.
- Construction requirements including venting, moisture control and insulation shown for illustrative purposes only. Confirm specific regulatory requirements.
- The flue terminal will get very hot when in use. Precautions should be taken to protect people and animals from injury.
- This technical sheet must be read in conjunction with the relevant Escea Gas Fireplace Installation Manual, the latest version can be found on our website at [www.escea.com](http://www.escea.com).

GENERAL CONSTRUCTION AND FINISHES SHOWN INDICATIVE ONLY

Contact the ESCEA Architectural Advisory Team for assistance with the specification of this fire - [aa@escea.com](mailto:aa@escea.com)

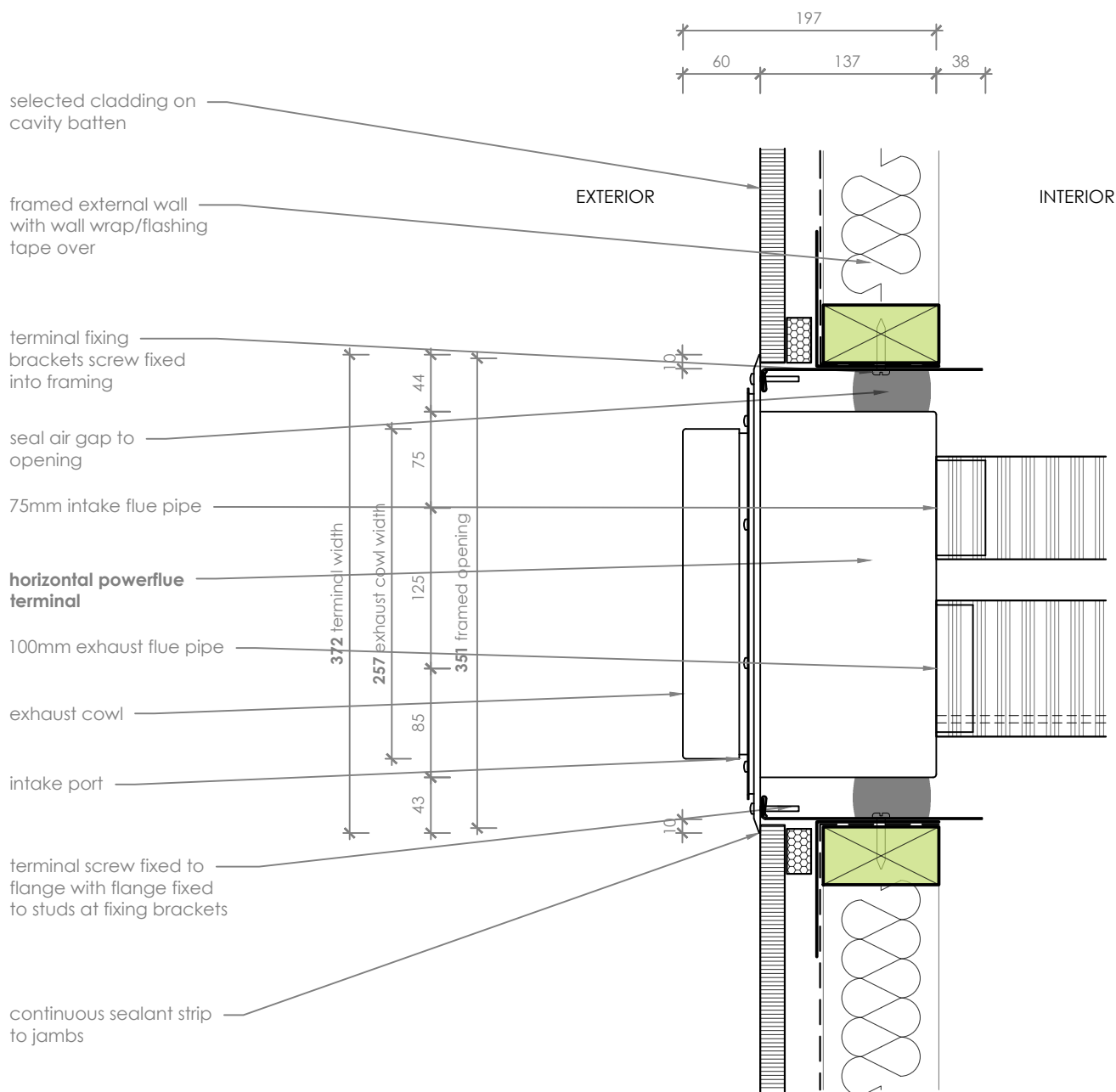

**Jamb Detail**

scale 1:5

**note:**

- DO NOT SCALE OFF THESE DRAWINGS. All dimensions are in mm.
- It is advisable to secure the flexible flue to prevent movement, vibration and sagging - this will also assist in maintaining the required 50mm standoff where required.
- Ensure flashings, wall claddings or any other building component does not obstruct the horizontal powerflue terminal.
- Construction requirements including venting, moisture control and insulation shown for illustrative purposes only. Confirm specific regulatory requirements.
- The flue terminal will get very hot when in use. Precautions should be taken to protect people and animals from injury.
- This technical sheet must be read in conjunction with the relevant Escea Gas Fireplace Installation Manual, the latest version can be found on our website at [www.escea.com](http://www.escea.com).

GENERAL CONSTRUCTION AND FINISHES SHOWN INDICATIVE ONLY

Contact the ESCEA Architectural Advisory Team for assistance with the specification of this fire - [aa@escea.com](mailto:aa@escea.com)