

# ST900 Direct Vent Gas Fireplace

Information Sheet for Builders and Architects

escea.

## Creating the Cavity:

The dimensioned drawing below shows the minimum size of cavity that must be created. Normal dry wall (Gib Board) is suitable for facing wall surfaces.



## Flueing:

Flueing consists of 5" x 8" Simpson Duravent Direct Vent Pro system, available from Escea. For full details relating to flueing design options please consult the Installation Manual, available from [www.escea.co.nz](http://www.escea.co.nz)

## Fascia Options:

Stainless Steel, or Powder Coated (Satin Black, Suede Cream, Antique Steel, Florentine Bronze)

## Fuel Bed Options:

White coals, black coals, or driftwood log set with pebbles (pictured).

## Gas Specifications:

Heat Output = 3.2 – 4.2kW Depending on flue configuration  
 Gas Input = 20Mj/hr (on HIGH flame setting)  
 Gas Connection = Front LH bottom corner of heater, 3/8" flare  
 Gas = NG / LPG  
 Operating Pressure = 1kPa NG / 2.3kPa LPG  
 Inlet Gas Pressure = 1.2kPa to 5kPa NG; 2.5kPa to 5.0kPa LPG

## Power Requirement:

To use the mains power supply as the primary power source, a standard 3-pin, earthed, 240V outlet must be within 1.5m of the lower left hand side of the appliance.  
 The ST900 may also be run on 3 D cell Batteries as the primary or backup power source.  
 (Available as an accessory)

## Product Dimensions: (mm)

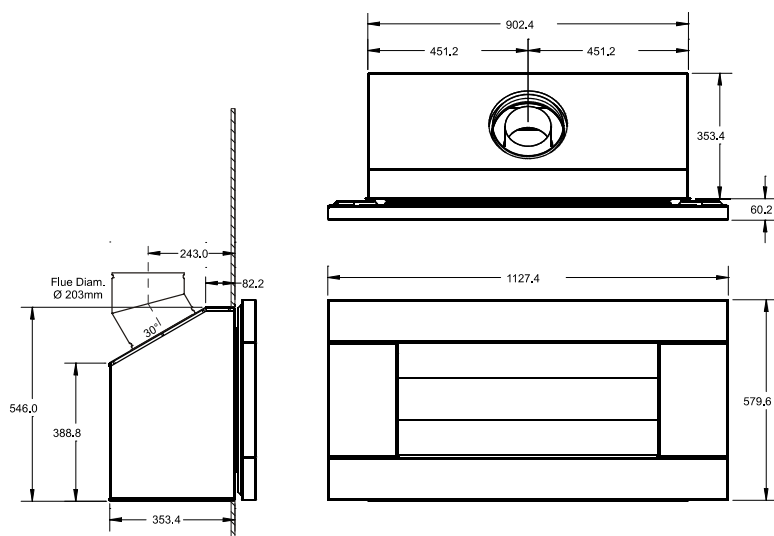

## Minimum Cavity size:

W	H	D
910	555	380

Top of cavity **MUST** be open to the ceiling space.

